

LIVERMORES
THE ESTATE AGENTS

3 Bedrooms

House - Terraced

Offers In The Region Of

£380,000

Located in

Dartford



www.livermores.co.uk

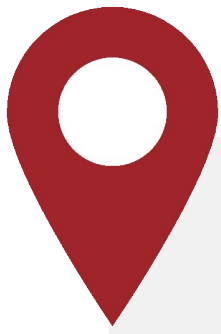

53 Savoy Road

Dartford DA1 5AN



OFFERS IN THE REGION OF £380000 * THREE BEDROOM MID TERRACE HOUSE * SEPERATE LOUNGE AND KITCHEN/DINER * MODERN KITCHEN * LOVELY GARDEN * PERFECT FOR FIRST TIME BUYERS AND INVESTORS* APPROXIMATELY 0.5 MILES FROM DARTFORD MAINLINE STATION * AMAZING SUMMER HOUSE* ADDED SHOWER ROOM IN SUMMER HOUSE* INTERNAL VIEWING HIGHLY RECOMMENDED*

53 Savoy Road

£380,000 Freehold



- OFFERS IN THE REGION OF £380,000
- 3 BEDROOM MID TERRACE
- 0.5 MILES FROM DARTFORD RAIL STATION
- FAMILY BATHROOM
- SIMILAR PROPERTIES REQUIRED
- DATFORD GRAMMAR SCHOOL CATHMENT
- EXTREMELY SPACIOUS SUMMER HOUSE
- OFF STREET PARKING
- DOUBLE GLAZING
- EPC RATING TBA COUNCIL TAX BAND 'C'

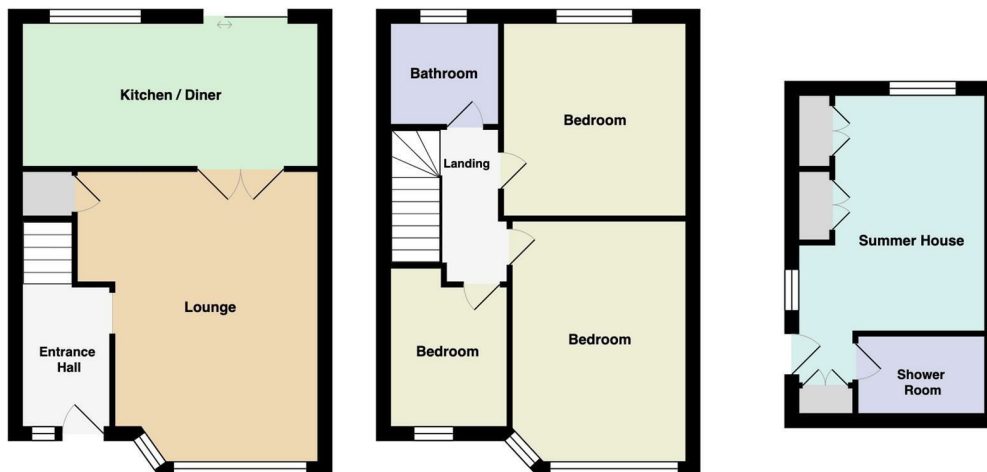

Council Tax Band C

Local Authority DARTFORD

Agents Note: Whilst every care has been taken to prepare these particulars, they are for guidance purposes only. All measurements are approximate and are for general guidance purposes only and whilst every care has been taken to ensure their accuracy, they should not be relied upon and potential buyers/tenants are advised to recheck the measurements.

Energy Efficiency Rating		
	Current	Potential
Very energy efficient - lower running costs		
(92 plus) A		90
(81-91) B		
(69-80) C	70	
(55-68) D		
(39-54) E		
(21-38) F		
(1-20) G		
Not energy efficient - higher running costs		
England & Wales	EU Directive 2002/91/EC	

1 Hythe Street
Dartford
Kent
DA1 1BE



dartford@livermores.co.uk

01322 228090

www.company.co.uk