

40-42 Arundel Road, Littlehampton BN17 7DD

£100,000 - Leasehold

Glyn-Jones

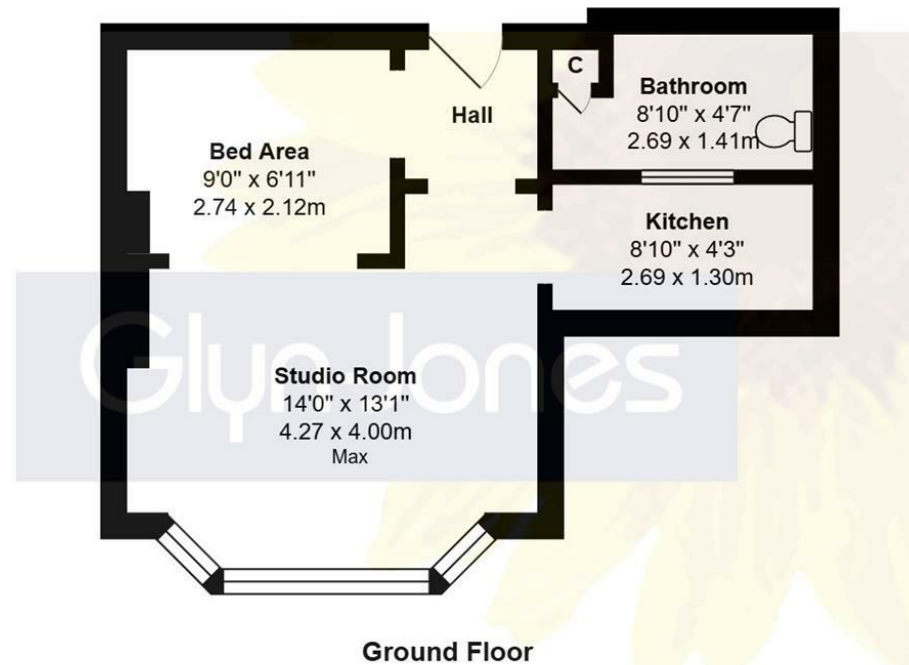

Total Area: 326 ft² ... 30.3 m²

Whilst every attempt has been made to ensure the accuracy of the floor plan contained here, measurements are approximate and no responsibility is taken for error, omission or mis-statement. This plan is for illustrative purposes only and should be used as such by any prospective purchaser. Created by 1st Image 2026



TENURE - Leasehold

Council Tax Band: A

Energy Performance Rating: F

AGENTS NOTE - For clarification, we wish to inform prospective purchasers that we have prepared these sales particulars as a general guide. We have not carried out a detailed survey nor tested the services, appliances and specific fittings. Room sizes should not be relied upon for carpets and furnishings.

WITH OVER...



At an Average rating of **4.9/5** ★★★★★



Glyn-Jones & Company
Littlehampton Office Sales
01903 739000
littlehampton@glyn-jones.com

- Ground Floor Studio Flat
- Studio Room with Bedroom Area
- Bathroom
- No Chain
- Requires Complete Modernisation
- Separate Kitchen
- New 999 Year Lease Upon Completion
- CASH BUYERS ONLY

CASH BUYERS ONLY | Ground Floor Studio Flat | Studio Room with Bedroom Area | Separate Kitchen | Bathroom | New 999 Year Lease Upon Completion | Requires Complete Modernisation | No Chain | EER - F



At an Average rating of **4.9/5** ★★★★★



Glyn-Jones & Company
Littlehampton
01903 739000

Flat 11, 40-42 Arundel Road, Littlehampton, BN17 7DD

CASH BUYERS ONLY | Ground Floor Studio Flat | Studio Room with Bedroom Area | Separate Kitchen | Bathroom | New 999 Year Lease Upon Completion | Requires Complete Modernisation | No Chain | EER - F



CASH BUYERS ONLY | Ground Floor Studio Flat | Studio Room with Bedroom Area | Separate Kitchen | Bathroom | New 999 Year Lease Upon Completion | Requires Complete Modernisation | No Chain | EER - F

WITH OVER... **500** COMPANY REVIEWS At an Average rating of **4.9/5**   **Glyn-Jones & Company**
Littlehampton
01903 739000