

29 The Gilberts Sea Road, Rustington

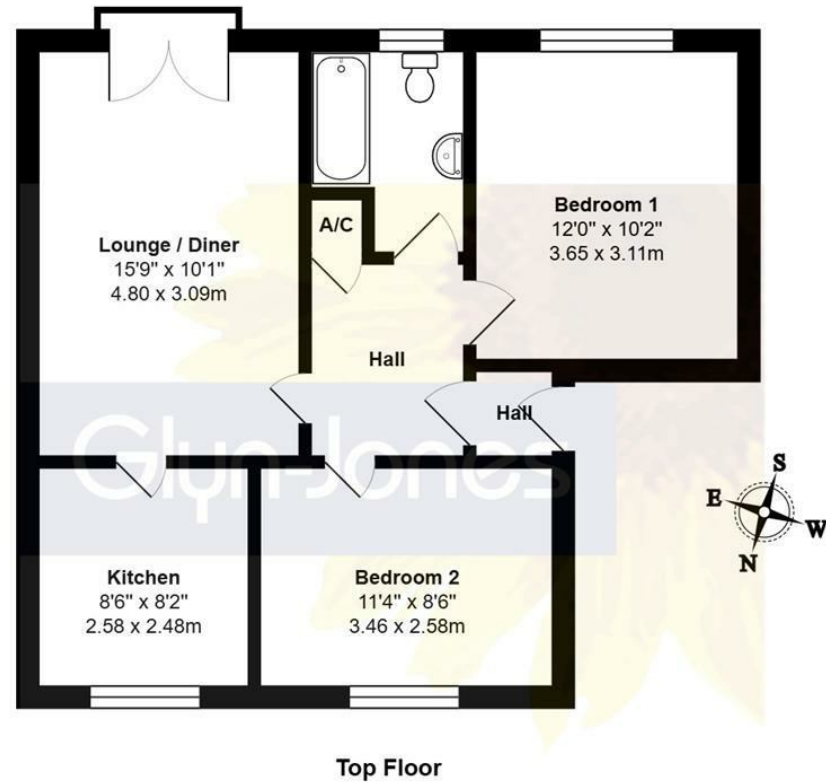

£255,000 - Leasehold



Total Area: 582 ft² ... 54.1 m²

Whilst every attempt has been made to ensure the accuracy of the floor plan contained here, measurements are approximate and no responsibility is taken for error, omission or mis-statement. This plan is for illustrative purposes only and should be used as such by any prospective purchaser. Created by 1st Image 2026



TENURE - Leasehold

Council Tax Band: C

Energy Performance Rating:

AGENTS NOTE - For clarification, we wish to inform prospective purchasers that we have prepared these sales particulars as a general guide. We have not carried out a detailed survey nor tested the services, appliances and specific fittings. Room sizes should not be relied upon for carpets and furnishings.

WITH OVER...



At an Average rating of **4.9/5** ★★★★★



Glyn-Jones & Company
Rustington Office Sales
01903 770095
rustington@glyn-jones.com

Set within this popular seafront development, this delightful top floor apartment presents a unique opportunity to enjoy coastal living at its finest. With no onward chain, this purpose-built residence is positioned at the rear of the development offering elevated sea views. The apartment boasts two bedrooms, with the main bedroom enjoying a sea view. The south-facing lounge is bright and inviting, with double doors opening onto a Juliet balcony that frames far reaching sea views and bathes the living space in natural light. The kitchen is accessed off the lounge, whilst the bathroom is fitted with white suite. Additional features include gas heating, double glazing, security entryphone and the remainder of a 999 year lease. Externally, residents benefit from well-maintained communal gardens. There is a garage for private parking, as well as non-allocated spaces for residents and visitors.

Rustington's comprehensive village centre can be found within approximately one mile, with most amenities close to hand, including; library, churches and medical centre. The village offers comprehensive shops, including Waitrose and a wide range of specialist retailers, coffee shops and restaurants. The seafront offers extensive leisure facilities, including Littlehampton's Wave leisure centre with swimming pool, Mewsbrook Park and boating lake, and the seafront promenade providing a pleasant walk with cafes and amenities along the way. This is an ideal retirement location with everything you need close to hand and many leisure activities available nearby.



At an Average rating of **4.9/5** ★★★★★



Glyn-Jones & Company
Rustington
01903 770095

29 The Gilberts Sea Road, Rustington, BN16 2LY

