

PROMINENCE
ESTATES



RESIDENTIAL
PROPERTY EXPERTS

COVENTRY, WARWICKSHIRE
& LEAMINGTON SPA



COTEN END,
WARWICK, CV34 4NU

£625 PCM

COTEN END



PROMINENCE
ESTATES

A newly renovated ground floor commercial unit to let, prominently positioned within a busy and established parade on Coten End, Warwick. The premises is ready for immediate occupation and provides a versatile space suitable for a range of commercial uses, subject to any required consent.

The unit includes a main trading area together with a small kitchen to the rear and separate WC facilities. The property occupies a convenient and accessible position close to Warwick town centre, benefiting from nearby local amenities, regular passing trade and excellent connectivity to Warwick Railway Station, Leamington Spa, Coventry and surrounding Warwickshire areas. An ideal opportunity for a business seeking a smart, ready-to-occupy unit in a strong local trading location.

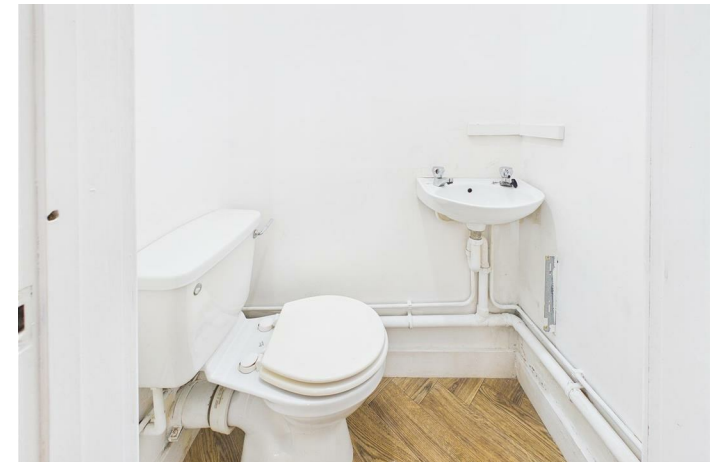

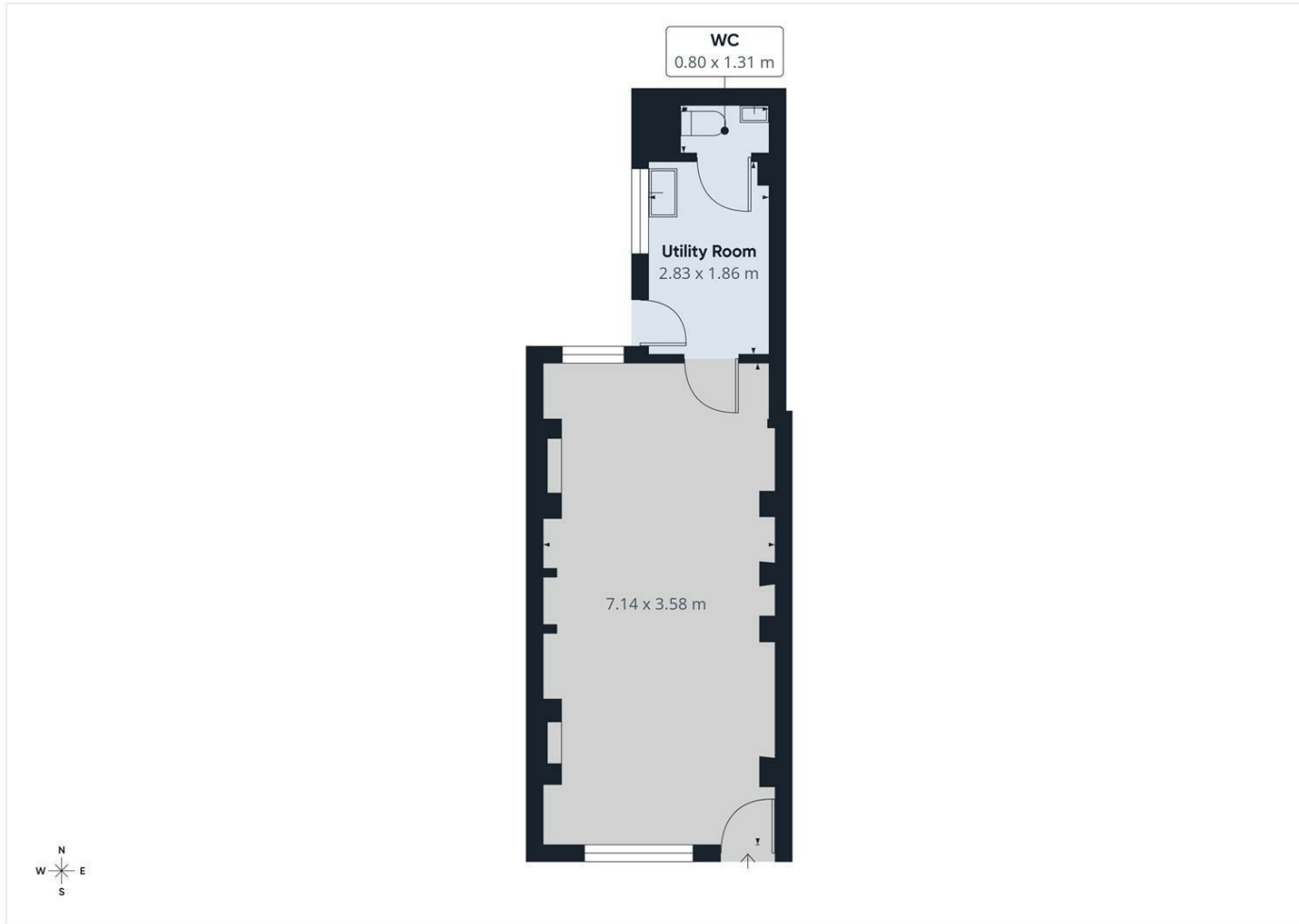

Prominence Estates
5 Queen Isabels Avenue,
Cheylesmore,
Coventry,
CV3 5GE

02476 309 826
sales@prominenceestates.com
www.prominenceestates.com

PROMINENCE
ESTATES