

ROAD MAP

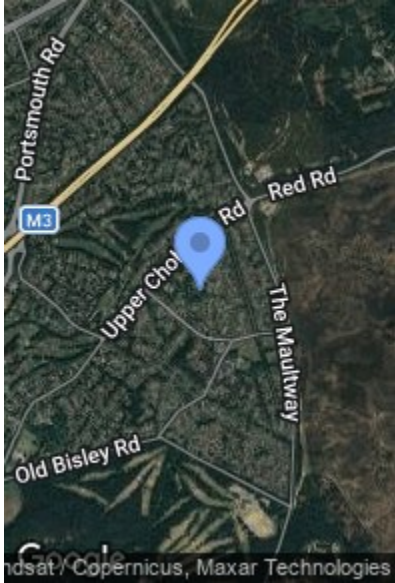

HYBRID MAP



TERRAIN MAP



DAWSMERE CLOSE, CAMBERLEY GU15
OFFERS IN EXCESS OF £230,000

Camberley 01276 539111
Email: enquiries@knightspropertyservices.com
54 Obelisk Way, Camberley, Surrey GU15 3SG
www.knightspropertyservices.com



Energy Efficiency Rating		
	Current	Potential
Very energy efficient - lower running costs		
(92 plus) A		
(81-91) B		
(69-80) C		
(55-68) D		
(39-54) E	58	68
(21-38) F		
(1-20) G		
Not energy efficient - higher running costs		
England & Wales	EU Directive 2002/91/EC	





FLOORPLAN

Dawsmere Close, GU15
Approximate Area = 757 sq ft / 70.3 sq m
For identification only - Not to scale

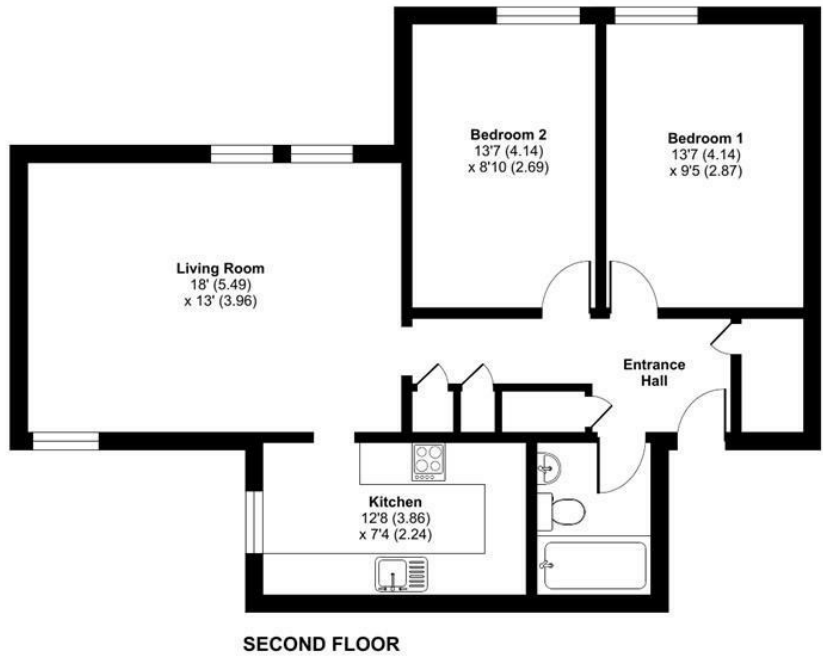

 **Certified Property Measurer** Floor plan produced in accordance with RICS Property Measurement Standards incorporating International Property Measurement Standards (IPMS2 Residential). © rîchecom 2024. Produced for Knights Property Services. REF: 1189160 

DAWSMERE CLOSE, CAMBERLEY GU15

KNIGHTS PROPERTY SERVICES ****NO ONWARD CHAIN**** New to the market for sale is this well presented top floor apartment on the sought-after Heatherside development. The spacious property comprising; living room, separate kitchen, two double bedrooms and a bathroom. It also comes with external lockable storage. There is communal parking.

MAIN FEATURES

- No Onward Chain
- Second Floor Apartment
- Two Double Bedrooms
- Close To Well Regarded Schools
- Close To Local Amenities
- Separate Kitchen
- External Lockable Storage
- Well Presented
- Communal Parking

FULL DETAILS

Entrance Hall
Enter via door, storage cupboards and laminate flooring.

Living Room
Dual aspect, wood flooring and leading through to;

Kitchen
Range of base and eye level units, sink, cooker and space for; dishwasher and washing machine. Partly tiled walls and laminate flooring.

Bedroom One
Double bedroom and carpet flooring.

Bedroom Two
Double bedroom and carpet flooring.

Bathroom
Bath with shower, wash hand basin, low level WC and partly tiled walls.

Council Tax
Band C.