

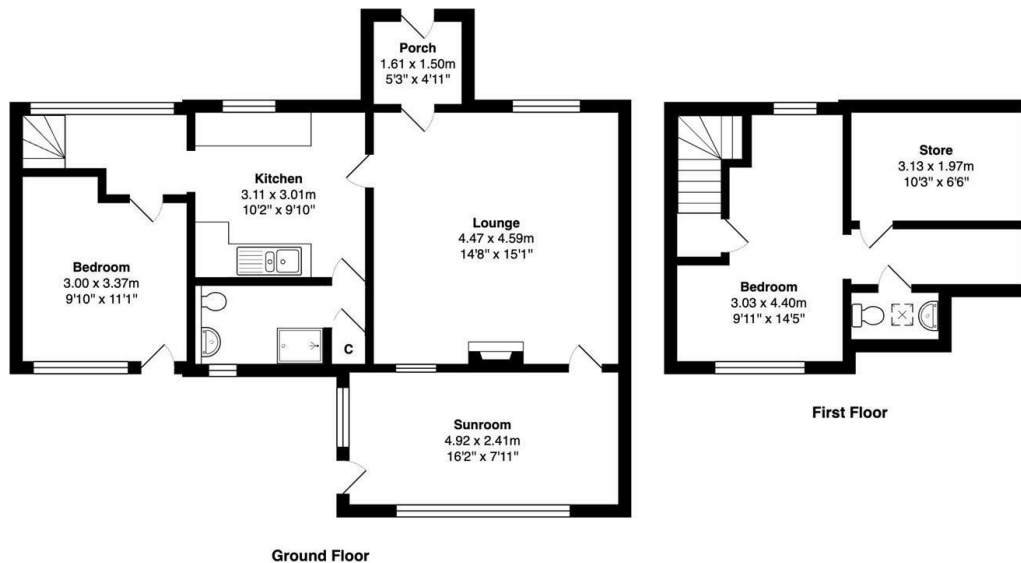

7 Buckden Court, Buckden, BD23 5JX

Asking Price £249,950

- UNIQUE COTTAGE STYLE HOME
- FABULOUS VIEWS
- YORKSHIRE DALES NATIONAL PARK
- CALL NOW TO ARRANGE A VIEWING
- TWO BEDROOMS
- TWO ALLOCATED PARKING SPACES
- IDEAL RESIDENTIAL HOME OR HOLIDAY LET
- SOUTH FACING GARDENS
- GARDEN ROOM EXTENSION
- SOUGHT AFTER SETTING



Total Area: 90.8 m² ... 977 ft²

All measurements are approximate and for display purposes only

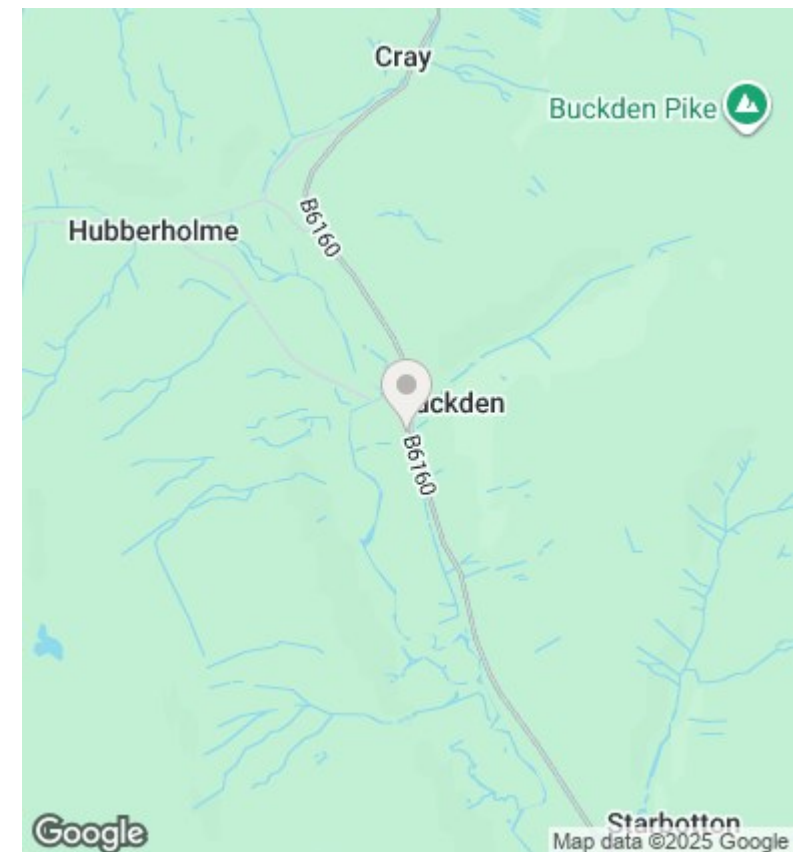

Directions

Viewings

Viewings by arrangement only. Call 01756 753341 to make an appointment.

Council Tax Band

C

EPC Rating:

E

Energy Efficiency Rating		
	Current	Potential
Very energy efficient - lower running costs		
(92-plus) A		
(81-91) B		
(69-80) C		75
(55-68) D		
(39-54) E	50	
(21-38) F		
(1-20) G		
Not energy efficient - higher running costs		
England & Wales		EU Directive 2002/91/EC