



Greenacres Drive, Keighley, BD20 6NF

Asking Price £219,950

- NO UPPER CHAIN
- TWO DOUBLE BEDROOMS
- ATTRACTIVE FRONT AND REAR GARDEN
- DETACHED BUNGALOW
- DRIVEWAY AND GARAGE
- FAR REACHING VIEWS

Greenacres Drive, Keighley, BD20 6NF

Wilman & Lodge are delighted to present this TWO DOUBLE BEDROOM DETACHED BUNGALOW to the open market, with NO UPPER CHAIN. This property boasts PLEASANT VIEWS, ATTRACTIVE GARDENS and a DETACHED GARAGE.



Council Tax Band: D

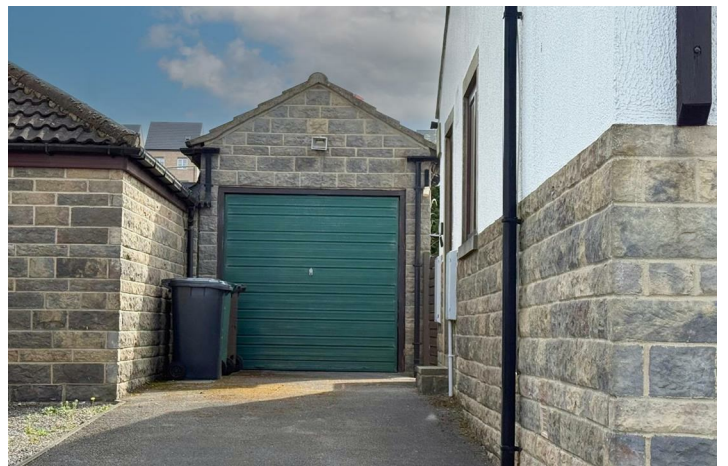

PROPERTY DETAILS

Wilman & Lodge are delighted to present this two double bedroom detached bungalow to the open market, with no upper chain. Located in a popular modern development off Shann Lane, this bungalow boasts pleasant views to the front elevation and spacious living accommodation, ideal for those looking to downsize. The property features attractive gardens at the front and rear, a side driveway and a detached garage.

The layout includes an entrance hallway, a cloakroom with a window to the side and a lounge/diner with a gas fire and windows to the front and side, offering far-reaching views. The kitchen is equipped with a range of wall and base units, a sink, an oven, a hob, a window to the rear and a side entrance door. An inner hall with a storage cupboard leads to two double bedrooms and a modern shower room with a walk-in shower, WC, wash basin and a window to the rear. Additional benefits include gas central heating and double glazing.

Viewing is highly recommended to fully appreciate the location and charm of this wonderful home.



Viewings

Viewings by arrangement only. Call 01535 655212 to make an appointment.

EPC Rating:

D

Energy Efficiency Rating		Current	Potential
Very energy efficient - lower running costs			
(92 plus) A			
(81-91) B			82
(69-80) C			
(55-68) D		62	
(39-54) E			
(21-38) F			
(1-20) G			
Not energy efficient - higher running costs			
England & Wales		EU Directive 2002/91/EC	

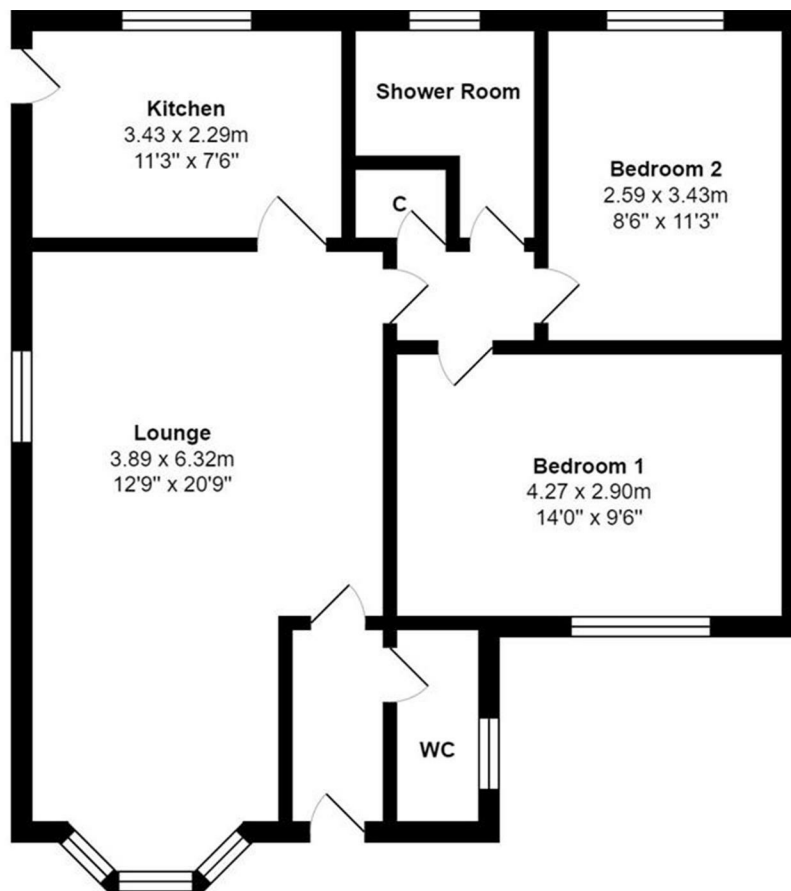

All measurements are approximate and for display purposes only