



Bobbin Mill Court, Steeton, BD20 6PU

Asking Price £209,950

- NO UPPER CHAIN
- TWO DOUBLE BEDROOMS
- LOW MAINTENANCE REAR GARDEN
- FITTED WARDROBES IN MASTER BEDROOM
- SOUGHT AFTER LOCATION
- STONE BUILT TERRACED PROPERTY
- PRIVATE PARKING
- SPACIOUS LIVING DINING AREA
- SHOW HOME CONDITION
- EXCELLENT TRANSPORT LINKS

Bobbin Mill Court, Steeton, BD20 6PU

If you're searching for a beautifully presented two double-bedroom stone-built home, tucked away in a quiet cul-de-sac within a highly sought-after village, then this exceptional property could be exactly what you've been looking for. Lovingly upgraded and meticulously maintained by the current owner, this stunning home is presented in true show-home condition. With homes of this quality rarely remaining on the market for long, early viewing is highly recommended to avoid disappointment.



Council Tax Band: B



PROPERTY DETAILS

If you're searching for a beautifully presented two double-bedroom stone-built home, tucked away in a quiet cul-de-sac within a highly sought-after village, then this exceptional property could be exactly what you've been looking for.

Lovingly upgraded and meticulously maintained by the current owner, this stunning home is presented in true show-home condition, reflecting a keen eye for interior design and attention to detail throughout. Offering a genuine turn-key opportunity, this property is ready to move straight into and is sure to appeal to a wide range of buyers. With homes of this quality rarely remaining on the market for long, early viewing is highly recommended to avoid disappointment.

The charming village location benefits from an excellent range of amenities, including a village shop, traditional pub, primary school and convenient bus and rail links. Ideally positioned between Cross Hills and Silsden, the property offers easy access to surrounding towns and countryside alike.

To the front of the property is private off-road parking, together with a useful entrance porch featuring attractive tiled flooring and practical storage space. The welcoming entrance hall is generously proportioned and features stylish wood-effect flooring, an open staircase to the first floor and flows seamlessly into the impressive contemporary breakfast kitchen. Beautifully fitted, the kitchen includes a breakfast bar, modern finishes, and pleasant views to the front.

To the rear, the spacious living and dining room provides an ideal space for both relaxing and entertaining, enjoying attractive outlooks and direct access to the garden.

The first floor offers a spacious landing. There are two well-proportioned double bedrooms, the master having fitted wardrobes and a cosy second bedroom. Completing the accommodation is a stylish and modern house bathroom, together with a large built-in airing cupboard.

Externally, the front of the property features private parking and attractive pebbled borders, while the rear garden has been designed for low-maintenance living with a combination of paving and decorative stone. A charming picket fence, hedge, and gateway provide access to the rear lane, creating a delightful outdoor space to enjoy.

For buyers seeking a beautifully finished home in immaculate, move-in-ready condition, this outstanding property is an absolute must-see.

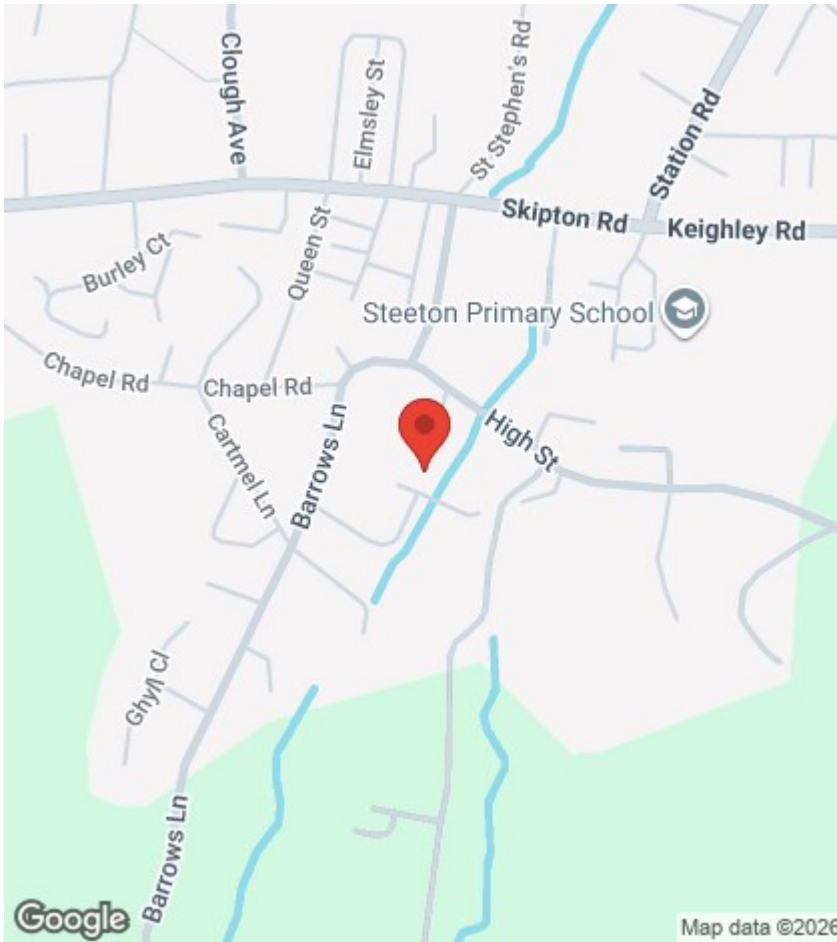

Viewings

Viewings by arrangement only. Call 01535 636238 to make an appointment.

EPC Rating:

C

Energy Efficiency Rating		Current	Potential
Very energy efficient - lower running costs			
(92 plus) A			
(81-91) B			87
(69-80) C		74	
(55-68) D			
(39-54) E			
(21-38) F			
(1-20) G			
Not energy efficient - higher running costs			
England & Wales		EU Directive 2002/91/EC	

Approx Gross Internal Area
62 sq m / 669 sq ft

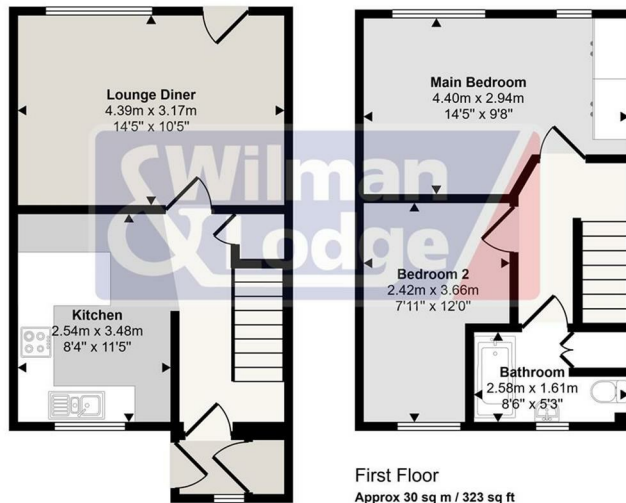

Ground Floor
Approx 32 sq m / 346 sq ft

First Floor
Approx 30 sq m / 323 sq ft

This floorplan is only for illustrative purposes and is not to scale. Measurements of rooms, doors, windows, and any items are approximate and no responsibility is taken for any error, omission or mis-statement. Icons of items such as bathroom suites are representations only and may not look like the real items. Made with Made Snappy 360.