



18 Taylor Road

, Norwich, NR5 8LZ

£1,850 Per Calendar Month

**Perfect for a group of five! This spacious house features five double bedrooms and is located within walking distance of UEA. With a sociable kitchen/diner and an enclosed garden, it's an ideal choice. A utility-inclusive package can be added for an additional £24.00 per person per week.**

- 5 bedroom student property      ▪ Available From: 19.08.2026
- Weekly Rent: Approx. £108 pppw    ▪ Monthly Rent: £2,350.00 (Excluding Utilities)
- 12 month agreements preferred    ▪ Bedrooms: 5 doubles



For a group of five wanting fairness and convenience, this house is the perfect find. Its prime location on Taylor Road means you can save on bus fare and enjoy a short walk to lectures and the library. Crucially, the property boasts five genuine double bedrooms, ensuring no one in the group has to compromise on space. The large kitchen/diner acts as the social hub of the home, perfect for group meals and catching up. A private enclosed garden provides a great retreat for sunny days. This is a fantastic opportunity to live in a spacious house right on the doorstep of the university. A utility-inclusive package is available for an additional £24.00 per person per week.

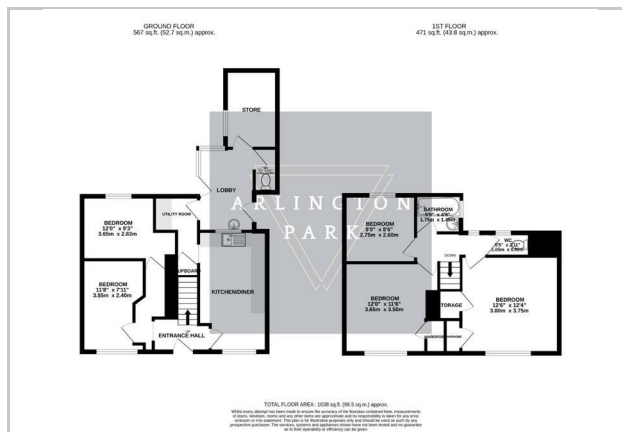

These particulars, whilst believed to be accurate are set out as a general outline only for guidance and do not constitute any part of an offer or contract. Intending purchasers should not rely on them as statements of representation of fact, but must satisfy themselves by inspection or otherwise as to their accuracy. No person in this firm's employment has the authority to make or give any representation or warranty in respect of the property.



Energy Efficiency Rating		Current	Potential
Very energy efficient - lower running costs			
(92 plus)	A		
(81-91)	B		
(69-80)	C		
(55-68)	D		
(39-54)	E		
(21-38)	F		
(1-20)	G		
Not energy efficient - higher running costs			
<b>England &amp; Wales</b>		73	
		EU Directive 2002/91/EC	

**25a Earlham Road, Norwich, Norfolk, NR2 3AD**  
**Tel: 01603 577255 Email: [youragent@arlingtonpark.co.uk](mailto:youragent@arlingtonpark.co.uk) <https://www.arlingtonpark.co.uk/>**