



**2 Bed
Apartment
located
in Wandsworth
Road**

£2,000 Per Month





Amesbury tower, SW8

CAPTURE DATE 17/03/2023 LASER SCAN POINTS 35,557,781

GROSS INTERNAL AREA

57.36 sqm / 617.42 sqft

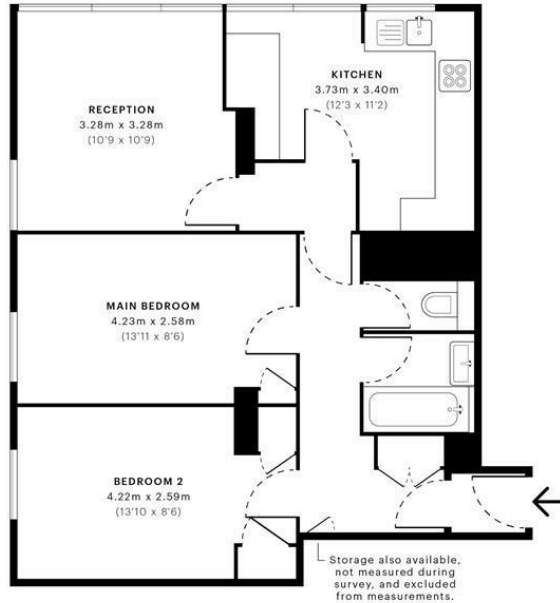

— Twelfth Floor



Specified floor plans are produced in accordance with:
Royal Institution of Chartered Surveyors Property Measurement Standards.
Plans and gardens are illustrative only and excluded from all area calculations.
Due to rounding, numbers may not add up precisely.
All measurements shown are the maximum room heights and widths.
All measurements shown are the maximum points of measurements captured in the scan.

PHOTO MEASUREMENTS: 1000mm, 1000mm, 1000mm
www.orlandoreid.co.uk

spec id: 56411an64d-45750a80d30540

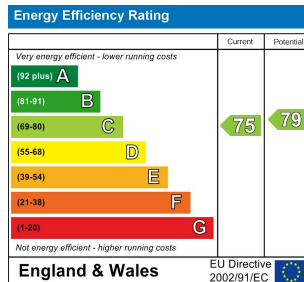

DIRECTIONS

CONTACT

1-3 Old Town
Clapham
London
SW4 0JT

E: lettings@orlandoreid.co.uk
T: 020 7627 3197
www.orlandoreid.co.uk

