



**1 Bed
Apartment
located in Wood
Green**

£1,750 Per Month



Willingdon Road N22 6SE

Approx Gross Internal Area = 45.6 sq m / 490 sq ft

Shed = 10.6 sq m / 114 sq ft

Total = 56.2 sq m / 604 sq ft

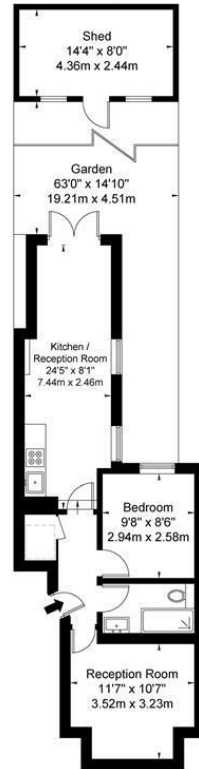

Ground Floor

Ref

Copyright

**B L E U
P L A N**

The Floor plan is not to scale and measurements and areas shown are approximate and therefore should be used for illustrative purposes only. The plan has been prepared in accordance with the RICS code of Measuring Practice and whilst we have confidence in the information produced it must not be relied on. If there is any aspect of particular importance, you should carry out or commission your own inspection of the property.

Copyright @ BLEUPLAN

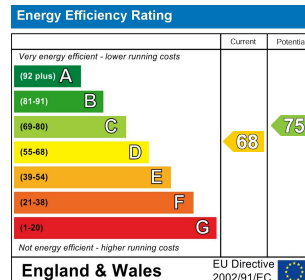

DIRECTIONS

CONTACT

1-3 Old Town
Clapham
London
SW4 0JT

E: lettings@orlandoreid.co.uk
T: 020 7627 3197
www.orlandoreid.co.uk

