



## Laburnham House Middleton Street

, Llandrindod Wells, LD1 5ET

£118,000



Laburnham House is situated in the heart of the Historic Spa town of Llandrindod Wells, located in a terrace of similar Victorian properties. This property affords any prospective purchaser the opportunity to live in the centre of this Elegant Spa Town which is renowned for its stunning Victorian architecture.

The accommodation is spread over 3 floors with access from the pavement provided by an entrance door to the right of the shop. On entering the property through the front door, the entrance hall on the ground floor has stairs that lead up to the first floor which comprises separate W.C plus main family bathroom, large kitchen/breakfast room with door at the end of this room providing access out to the rear garden area down a flight of wooden stairs.

The second floor of the property has two large double bedrooms and one single bedroom, the landing has stairs that lead up third floor which again benefits from a large landing with doors off to the two double bedrooms and one single bedroom.

The area around Llandrindod Wells is noted for its stunning scenery and the range of outdoor activities on offer.  
Gas Central Heating: Council Tax Band TBC: Mains Electric Water & Drainage



## Area Map



## Floor Plans

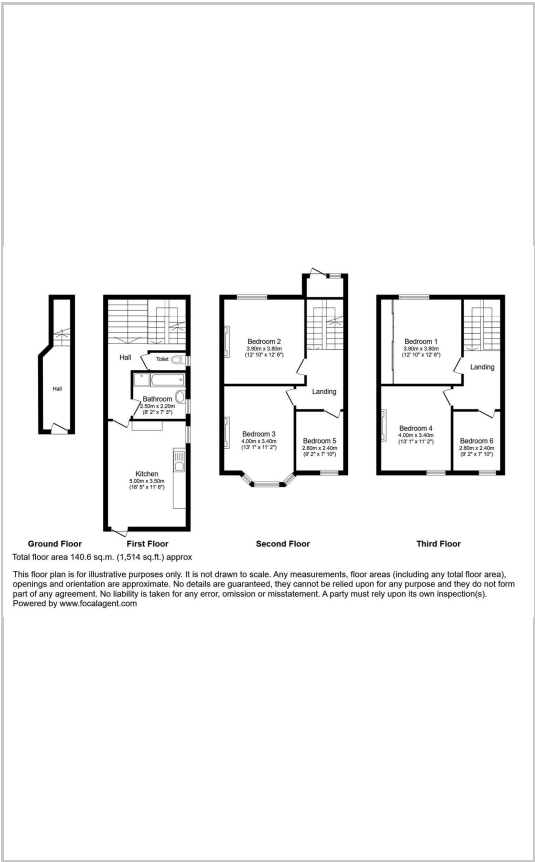

## Energy Efficiency Graph

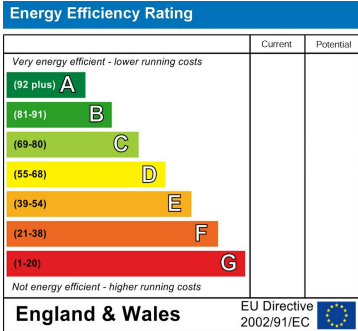

These particulars, whilst believed to be accurate are set out as a general outline only for guidance and do not constitute any part of an offer or contract. Intending purchasers should not rely on them as statements of representation of fact, but must satisfy themselves by inspection or otherwise as to their accuracy. No person in this firm's employment has the authority to make or give any representation or warranty in respect of the property.