



## The School Masters House Crabtree Walk

, Knighton, LD7 1EW

Auction Guide £65,000



\*\*For Auction On The 14th-16th April With Paul Fosh Auctions\*\*

\*\* VIEWING DATES \*\*

Tuesday 31st March - 2pm

Thursday 9th April 2 pm

Saturday 11th April - 2pm



## Area Map



## Floor Plans

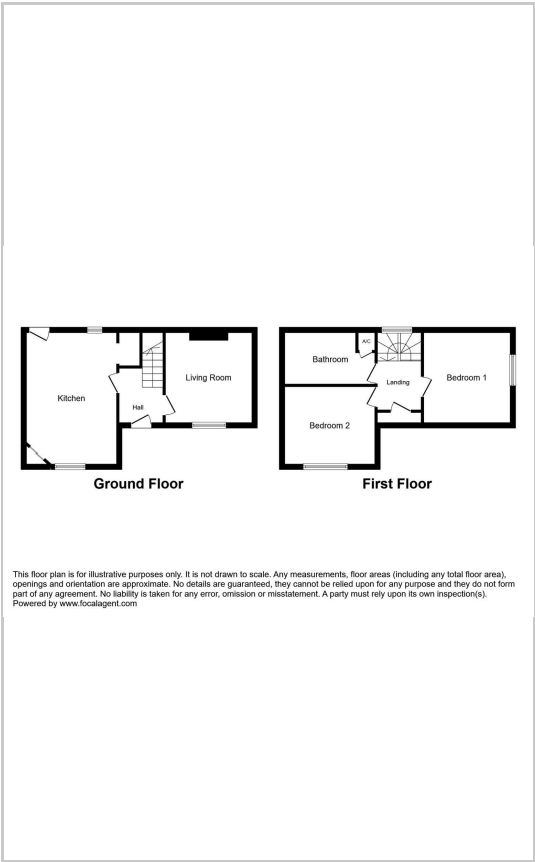

## Energy Efficiency Graph

Energy Efficiency Rating		Current	Potential
<i>Very energy efficient - lower running costs</i>			
(92 plus) <b>A</b>			
(81-91) <b>B</b>			
(69-80) <b>C</b>			
(55-68) <b>D</b>			
(39-54) <b>E</b>			
(21-38) <b>F</b>			
(1-20) <b>G</b>			
<i>Not energy efficient - higher running costs</i>			
<b>England &amp; Wales</b>		EU Directive 2002/91/EC 	

These particulars, whilst believed to be accurate are set out as a general outline only for guidance and do not constitute any part of an offer or contract. Intending purchasers should not rely on them as statements of representation of fact, but must satisfy themselves by inspection or otherwise as to their accuracy. No person in this firms employment has the authority to make or give any representation or warranty in respect of the property.