



## 19 Valley View

Fulwood, Preston, PR2 8HA

Offers Over £230,000



Located in a quiet and well-regarded area of Fulwood, this beautifully maintained 3-bedroom semi-detached home offers spacious and stylish living, perfect for families or professionals seeking comfort and convenience.

The ground floor features a welcoming porch and hallway, leading into a bright and airy open-plan lounge and dining room, created by opening up the original layout. The modern kitchen provides plenty of storage and flows seamlessly through patio doors into a lovely rear garden—ideal for relaxing or entertaining.

A standout feature of the garden is the charming summer house, which will remain with the property—perfect for use as a home office, studio, or additional relaxation space.

Upstairs, there are three well-sized bedrooms, including a rear bedroom with Juliet balcony overlooking the garden, and a stylish family bathroom with both a walk-in shower and separate bathtub.

This is an ideal home for families, professionals, or anyone looking to settle in a peaceful yet well-connected area. Early viewing is highly recommended.



Ground Floor

Entrance Hall 6'2" x 6'1" (1.88m x 1.86m)

Lounge 14'6" x 11'5" (4.42m x 3.49m)

Kitchen 18'0" x 6'9" (5.51m x 2.08m)

First Floor

Bedroom One 10'7" x 9'11" (3.25m x 3.04m )

Bedroom Two 11'4" x 8'7" (3.46m x 2.64m )

Bedroom Three 7'0" x 6'10" (2.14m x 2.10m)

Bathroom 8'10" x 5'9" (2.71m x 1.77m)

Area Map



Floor Plans

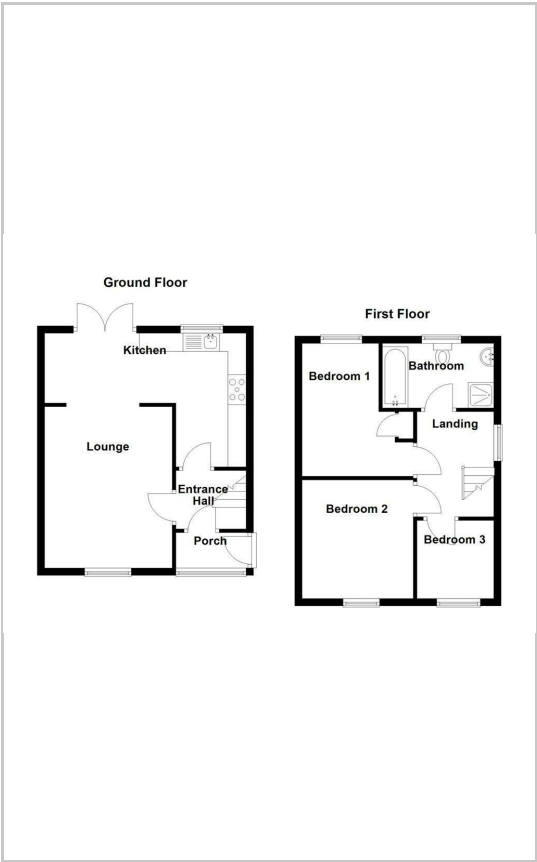

Energy Efficiency Graph

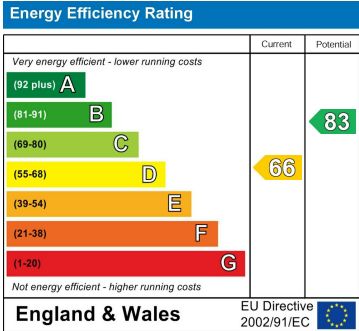

These particulars, whilst believed to be accurate are set out as a general outline only for guidance and do not constitute any part of an offer or contract. Intending purchasers should not rely on them as statements of representation of fact, but must satisfy themselves by inspection or otherwise as to their accuracy. No person in this firms employment has the authority to make or give any representation or warranty in respect of the property.