



30 Ashton Bank Way

Ashton-On-Ribble, Preston, PR2 1BF

Offers Over £145,000



Welcome to Ashton Bank Way, a well-maintained and modern 2-bedroom mid-terrace home situated in the highly sought-after area of Ashton-On-Ribble, Preston. This fully electric property offers a comfortable, energy-efficient lifestyle with a thoughtful layout and contemporary finishes throughout.

Inside, the home features a spacious master bedroom, a well-sized second bedroom, a modern bathroom, and an additional downstairs toilet for added convenience. The open-plan living and dining area flows effortlessly into a sleek kitchen, making it perfect for both relaxing and entertaining.

Outside, enjoy a generously sized rear garden, ideal for outdoor dining, family activities, or gardening enthusiasts. The property also benefits from two private parking spaces, a rare find in this location.



Ground Floor

Entrance Hall

Kitchen 10'11" x 6'4" (3.34m x 1.95m)

Open Plan Living Area 16'4" x 14'10" (4.98m x 4.54m)

WC 3'7" x 3'7" (1.1m x 1.1m)

First Floor

Bedroom One 14'10" x 10'6" (4.54m x 3.21m)

Bedroom Two 9'2" x 7'10" (2.8m x 2.4m)

Bathroom 6'9" x 5'9" (2.07m x 1.76m)

Area Map



Floor Plans

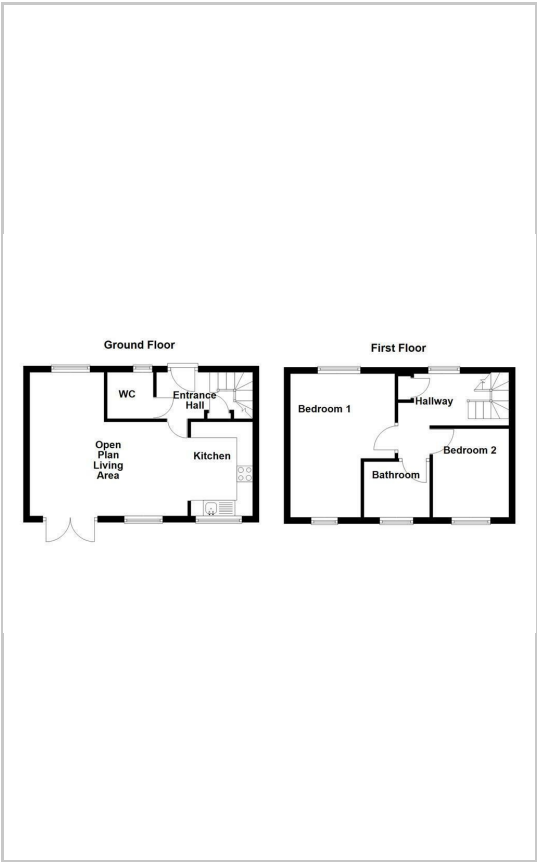

Energy Efficiency Graph

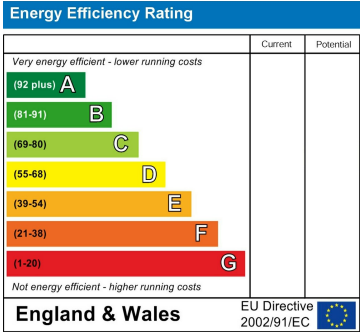

These particulars, whilst believed to be accurate are set out as a general outline only for guidance and do not constitute any part of an offer or contract. Intending purchasers should not rely on them as statements of representation of fact, but must satisfy themselves by inspection or otherwise as to their accuracy. No person in this firms employment has the authority to make or give any representation or warranty in respect of the property.