



Flat 4 Millbrook Court Millbrook Street, Cheltenham, Gloucestershire,

GL50 2DD
£800 PCM

TO LET



- AVAILABLE FROM 8/7/26
- WASHING MACHINE
- ALLOCATED PARKING
- MODERN DECOR
- EPC C
- OPEN PLAN
- FRIDGE FREEZER
- DOUBLE BEDROOM
- COUNCIL TAX BAND A
- CLOSE TO TRAIN STATION & TOWN

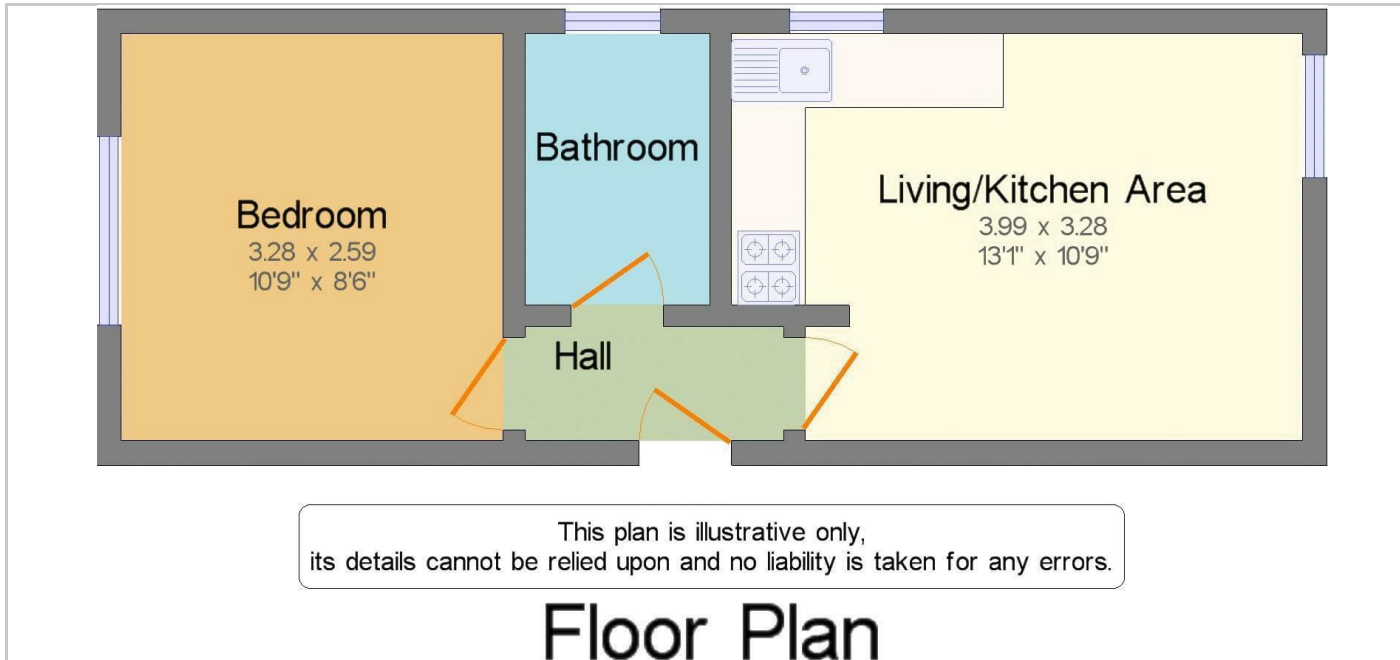

Directions

THE PROPERTY

****Allocated parking outside the front door****

Chosen Estate Agents are delighted to offer this immaculately presented, first floor, one bed apartment located within easy walking distance of Cheltenham town centre and the train station. Situated in a quiet cul de sac location, just off Millbrook Street the flat consists of :- secure door entry system, entrance hall, open plan living room, fitted kitchen with electric oven and hob, washing machine and fridge freezer, double bedroom and bathroom with shower over the bath. There are grey carpets fitted to compliment the white walls. New electric heating installed and double glazed throughout.

There is allocated parking for one car outside the main entrance which is a huge advantage this close to town.

The head lease dictates nopets allowed.

Holding Deposit: £184.00 based on 1 weeks' rent of asking price

Security Deposit: £923.00 based on 5 weeks' rent of asking price

Council Tax band: A Local Authority: Cheltenham Borough Council

EPC Band: C

Electricity supply: Mains Gas Supply: Mains Water supply: Mains Sewerage: Mains

Heating: Electric Heating Mobile phone coverage: i.e EE, Vodaphone, Three, O2

If satisfactory references are not obtained or you withdraw your application any financial loss to Chosen Estate Agents or the Landlord will be deducted from your holding deposit. If you or your guarantor provides information that is inaccurate, false, incomplete, or adverse credit not being disclosed then we may retain your holding deposit and reject your application.

SITUATION