

CURRAN  
BIRDS  
+ CO

Littleover House, 451. Burton  
Road, Littleover, Derby, DE23  
6FL





# CURRAN BIRDS + CO

Welcome to CB+CO, where *dedication* meets *excellence*, and impeccable service is our hallmark.



LITTLEOVER COMMUNITY SCHOOL & BEMROSE SCHOOL CATCHMENT – A beautifully furnished and inviting, three-bedroom apartment located in this highly convenient Littleover setting. Boasting generous living space (approx. 1,002sqft / 93sqm) and modern styling throughout, the property includes a large master bedroom with ensuite, two additional double bedrooms opening onto a private, low-maintenance garden, and an open-plan kitchen and lounge with breakfast island and integrated appliances. This home offers superb functionality and comfort, enhanced by thoughtful touches such as a roll-top bath and separate shower in the family bathroom, plentiful natural light, ample storage, a secure intercom system, and rear garden access to parking and storage. Situated close to well-regarded schools, local amenities, excellent transport links, and Derby city centre, this apartment blends peaceful suburban living with convenience – making it highly desirable for both families and professionals alike.

















CURRAN BIRDS + CO















## Littleover House, Burton Road, Littleover, Derby, DE23 6FL

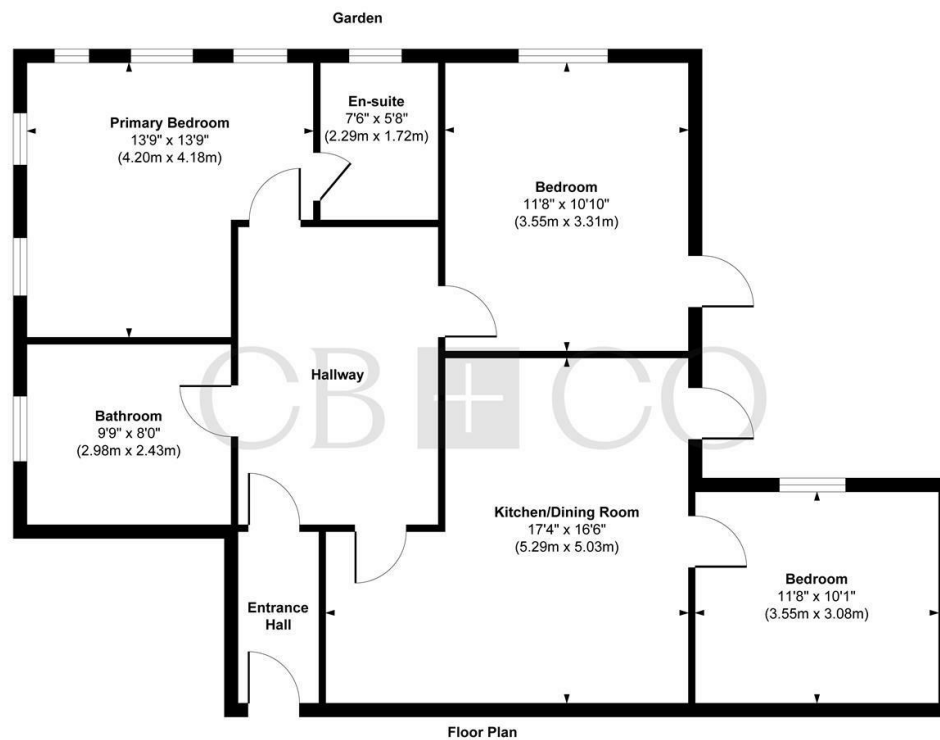

**Approx. Gross Internal Floor Area 1003 sq. ft / 93.26 sq. m**

Illustration for identification purposes only, measurements are approximate, not to scale.  
Produced by Elements Property

## The Particulars

- Spacious And Stylish Three-Bedroom Apartment In Littleover
- Fully Furnished Rooms Filled With Natural Light
- Large Master Bedroom With Ensuite And Garden Views
- Open-Plan Kitchen And Lounge With Breakfast Island
- Modern Family Bathroom With Roll-Top Bath And Separate Shower
- Patio Doors Leading To Private, Low-Maintenance Garden
- Integrated Appliances Including Dishwasher, Washing Machine, Fridge, And Freezer
- Rear Garden Access To Parking And Storage Facilities
- Convenient Intercom System And Ample Storage Cupboards
- Excellent Location Close To Schools, Shops, Transport, And Derby City Centre

### Size

Approx 1001.05 sq ft

### Energy Performance Certificate (EPC)

Rating D

### Council Tax Band

C



# CURRAN BIRDS + CO

Let's *Talk*

01332 411050  
hello@curranbirds.co  
curranbirds.co

The particulars above are a guide, not an offer or contract. Descriptions photographs and plans are not statements or representations of fact. Measurements are approximate and not to scale. Prospective purchasers must verify the accuracy of the information within the particulars. Curran Birds + Co does not give any representations or warranties; nor represent the Seller legally. Curran Birds + Co has no liability, for any costs, losses or expenses incurred by the Seller or a prospective buyer relating to the sales and buying transaction. Our Sales Disclaimer, trading names and privacy policy on how your data is processed and used is found in full on our website in our Privacy Statement.

© Curran Birds + Co 2024 All rights Reserved