



45 Shirley Road, Derby, DE21 4LA
£1,150 Per month





45 Shirley Road

Derby, DE21 4LA

- High Quality Fully Furnished Property
- Large L- Shaped Lounge Diner
- Three Good Sized Bedrooms
- Downstairs WC
- Large Mature Garden
- Available Now
- Well Appointed Kitchen & Utility Room
- Modern Family Bathroom
- Ample Parking
- Close to Local Schools & Shops

STYLISH THREE-BEDROOM HOME WITHIN A POPULAR AREA - A beautifully presented fully furnished three-bedroom semi-detached home located on the sought-after Shirley Road in Chaddesden, ideally positioned for easy access to Derby City Centre, Pride Park, and local amenities including schools and the Meteor Centre with its cinema and retail outlets. This fully furnished property offers well-proportioned living space, including an L-shaped lounge diner, a modern kitchen with utility room, and a generous mature garden. With its high-quality furnishings throughout and ample parking, this home is perfect for professionals seeking both comfort and convenience. Immediate availability makes this a fantastic opportunity not to be missed.

£1,150 Per month



The Detail

The Location





Directions





Floor Plans

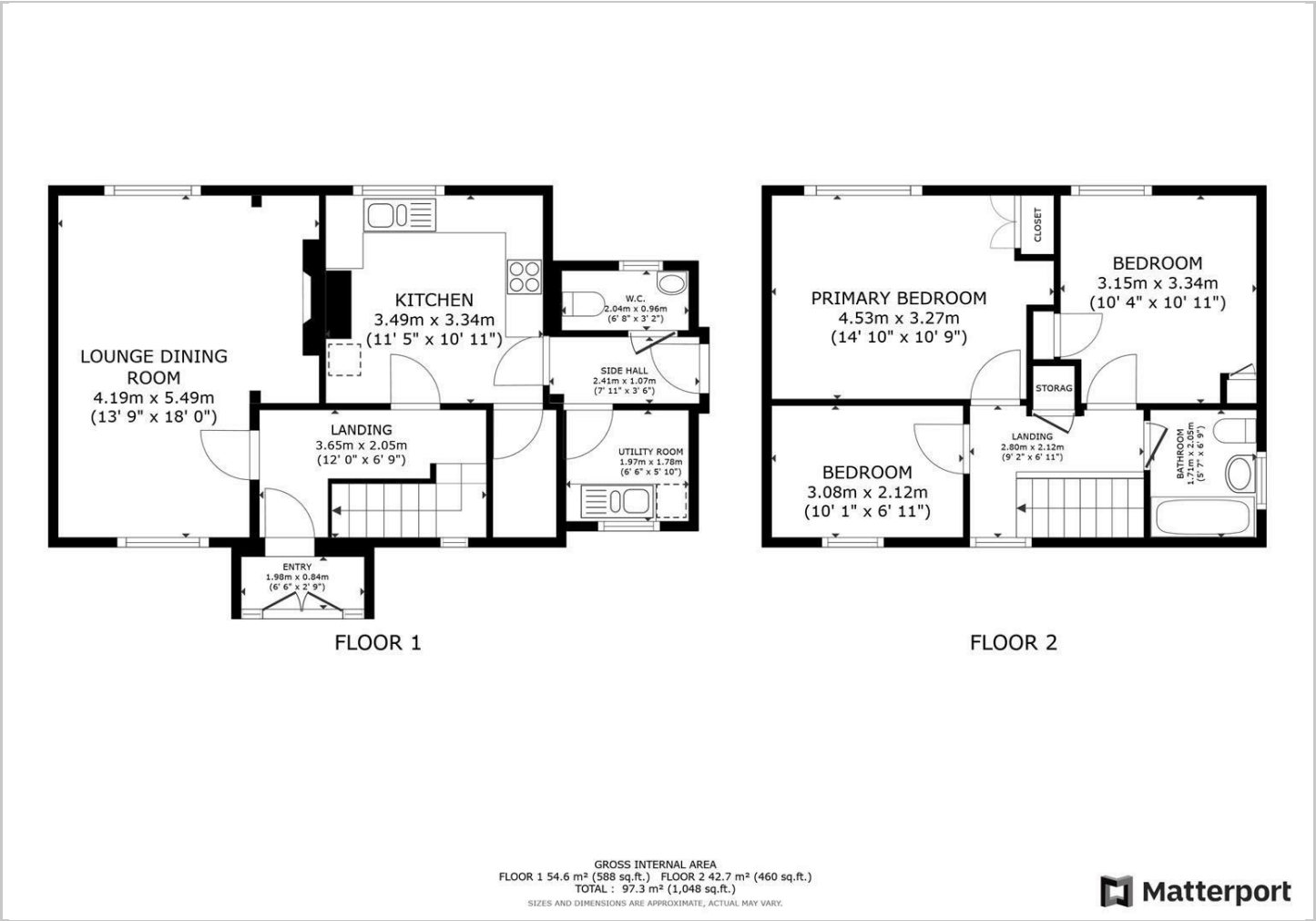

Location Map

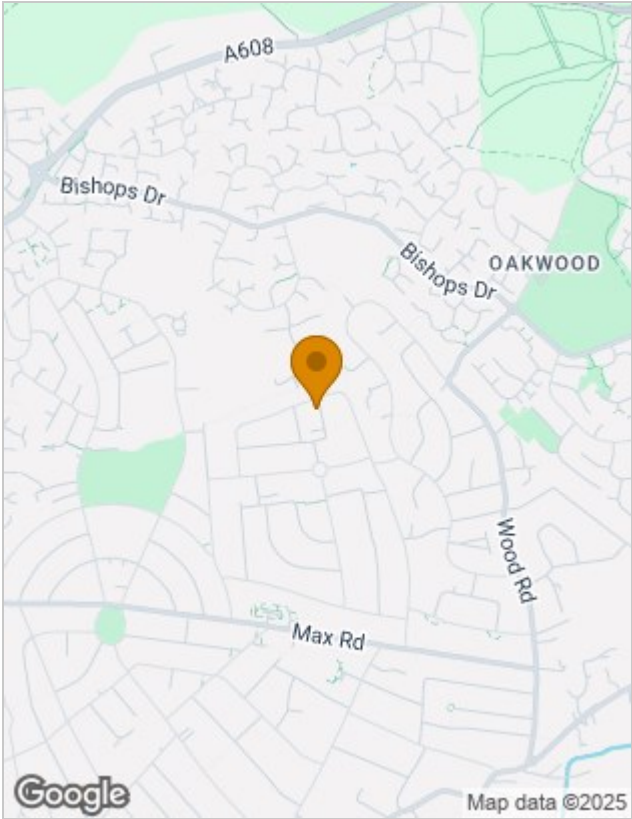

Energy Performance Graph



Viewing

Please contact our Derby Lettings Office on 01332 411050 if you wish to arrange a viewing appointment for this property or require further information.

The particulars are set out as a general outline only for the guidance of intended purchasers or lessees, and do not constitute, any part of a contract. Nothing in these particulars shall be deemed to be a statement that the property is in good structural condition or otherwise nor that any of the services, appliances, equipment or facilities are in good working order. Purchasers should satisfy themselves of this prior to purchasing.