

7 Auriga Court, Derby, DE1 3RH  
£950 Per month



£950 Per month

# 7 Auriga Court

Derby, DE1 3RH

- Luxury First Floor Executive Apartment
- Stunning Floor-To-Ceiling Windows
- Juliette Balcony
- En-Suite Shower Room To Primary Bedroom
- Permit Parking
- Fully Furnished Throughout
- Bright Open Plan Living Space
- Two Large Double Bedrooms
- Jack & Jill Bathroom Access
- Sought After Chester Green Location

LUXURY CITY LIVING | STYLISH FULLY FURNISHED APARTMENT | CHESTER GREEN LOCATION — A beautifully presented and exceptionally spacious first floor two bedroom executive apartment, located within the highly sought-after Chester Green area of Derby. Offering contemporary open-plan living, stunning floor-to-ceiling windows and a Juliette balcony, this stylish apartment is ideal for professionals seeking modern city living in a prime residential location. Finished to an excellent standard throughout, the property benefits from a generous primary bedroom with fitted wardrobes and en-suite shower room, a second large double bedroom with Jack & Jill bathroom access, permit parking and excellent transport links close by. Early viewing is highly recommended.



The Detail

The Location

Reservation Fee & Deposit



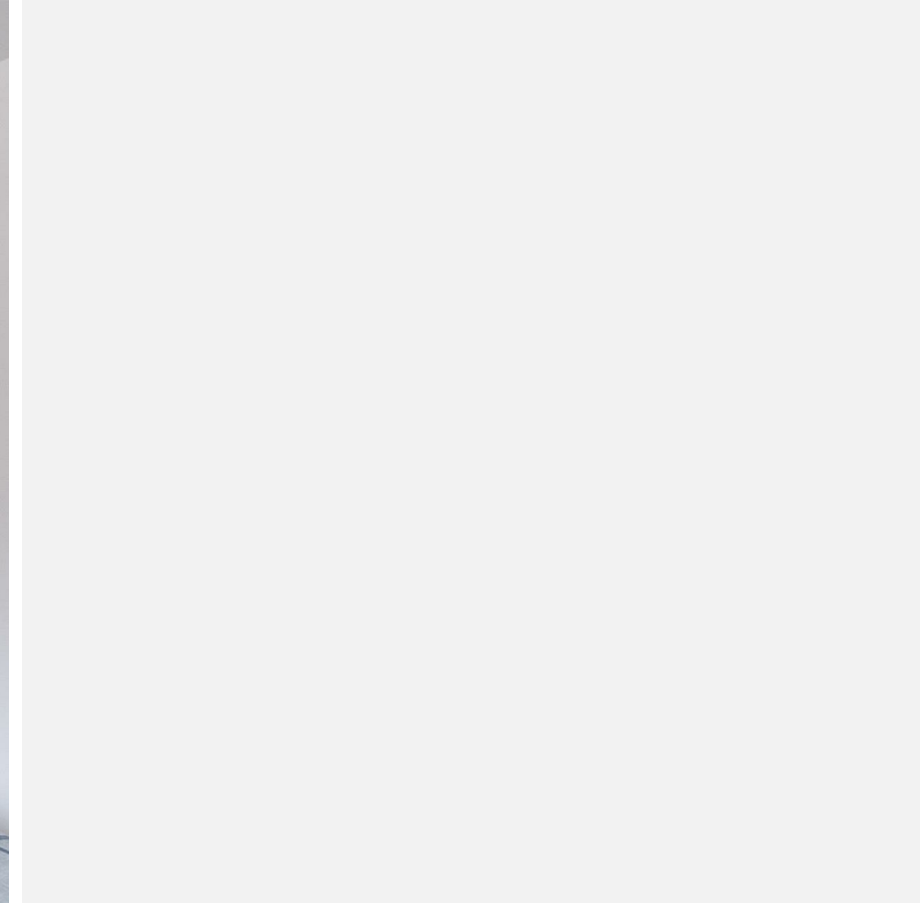

Directions





## Floor Plans

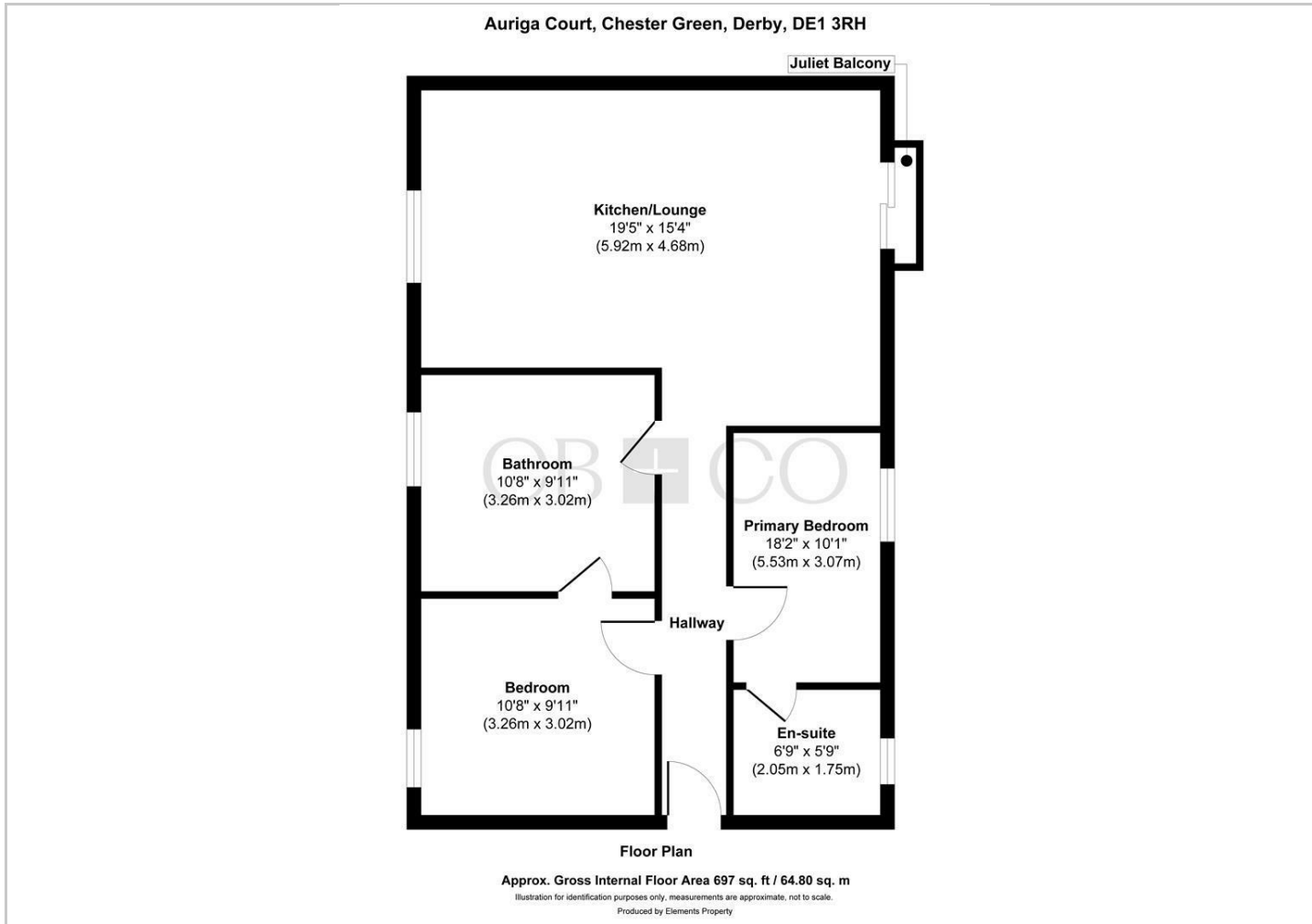

## Viewing

Please contact our Lettings Office on 01332 411050 if you wish to arrange a viewing appointment for this property or require further information.

The particulars are set out as a general outline only for the guidance of intended purchasers or lessees, and do not constitute, any part of a contract. Nothing in these particulars shall be deemed to be a statement that the property is in good structural condition or otherwise nor that any of the services, appliances, equipment or facilities are in good working order. Purchasers should satisfy themselves of this prior to purchasing.

First Floor, Darley Abbey Mills Middle Mill, Darley Abbey, Derby, DE22 1DZ  
Tel: 01332 411050 Email: hello@curranbirds.co

## Location Map

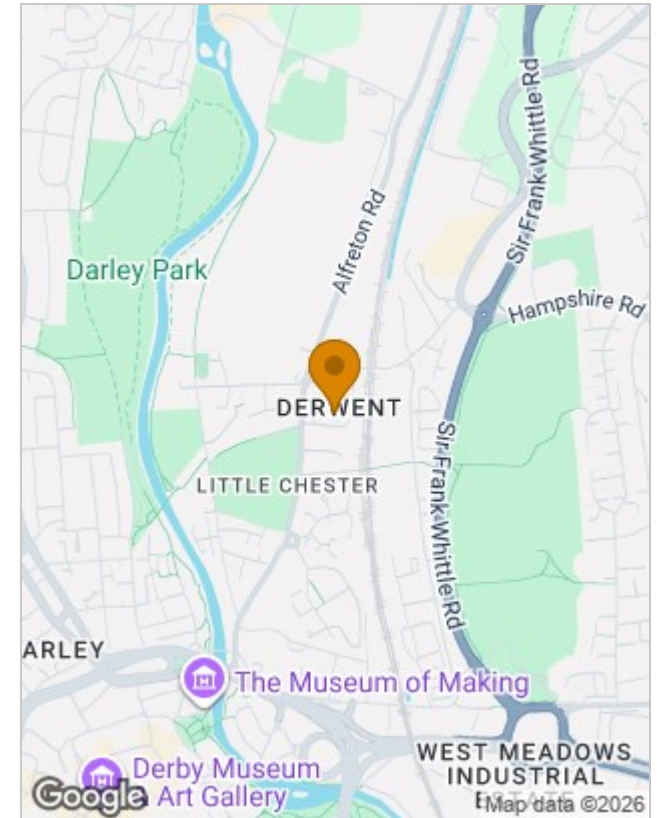

## Energy Performance Graph

