



Apartment 124 Fox House Erasmus Drive, Derby, DE1 2EL
£800 Per month



1



1



1



B



£800 Per month

Apartment 124 Fox House Erasmus Drive

Derby, DE1 2EL

- Luxury City Living Within The Prestigious Nightingale Quarter Development
- Highly Sought-After Fox House Building On Erasmus Drive
- Integrated Dishwasher, Washer/Dryer, Microwave, Oven And Ceramic Hob
- Stylish Three-Piece Bathroom With Heated Towel Rail And Vanity Storage
- Walking Distance To Derby City Centre and Railway Station
- Executive One Bedroom Apartment Finished To An Exceptional Standard
- Spacious Open-Plan Living Dining Kitchen With Contemporary Design
- Generous Double Bedroom With Mirrored Fitted Wardrobes
- Secure Key Fob Entry System With Lift Access To All Floors
- Exclusive On-Site Gym And Bistro Restaurant Within The Development

LUXURY CITY LIVING – An exceptionally stylish and beautifully appointed one bedroom executive apartment, forming part of the highly desirable Nightingale Quarter development in Derby. Situated within the sought-after Fox House building on Erasmus Drive, this contemporary apartment offers sophisticated open-plan living with a high specification finish throughout. Designed with modern professionals in mind, the property combines elegant interiors with practical design, featuring integrated appliances, mirrored fitted wardrobes and secure lift access. The development itself continues to establish itself as one of Derby's premier residential addresses, offering an exciting lifestyle setting within walking distance of Derby City Centre, Derby Railway Station and the Royal Derby Hospital.



The Detail

The Location

Reservation Fee & Deposit



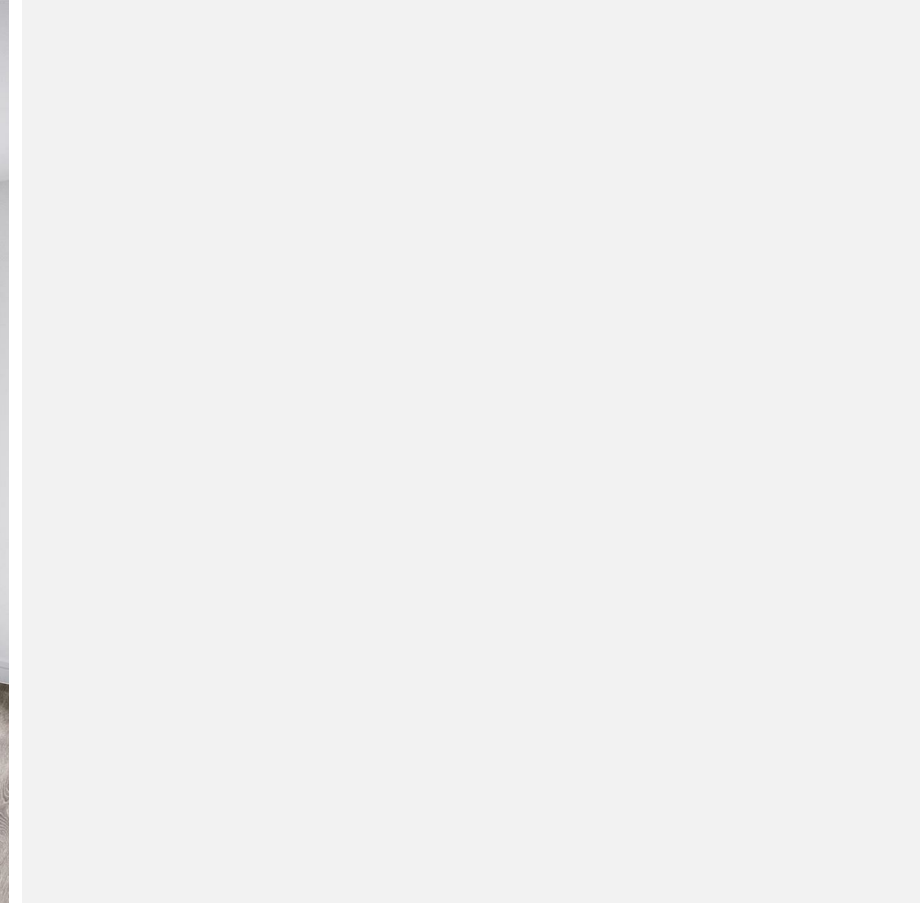

Directions





Floor Plans

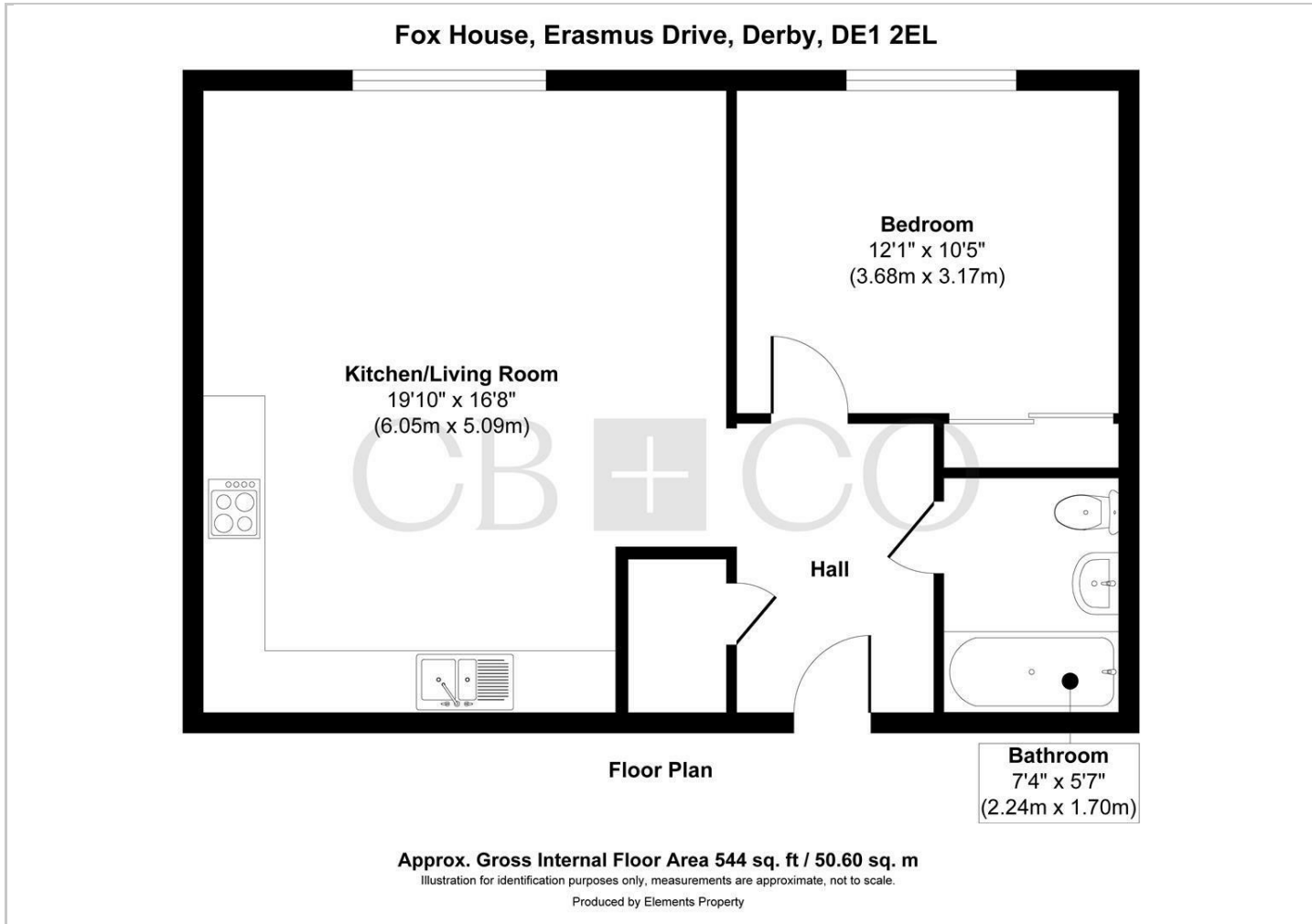

Location Map

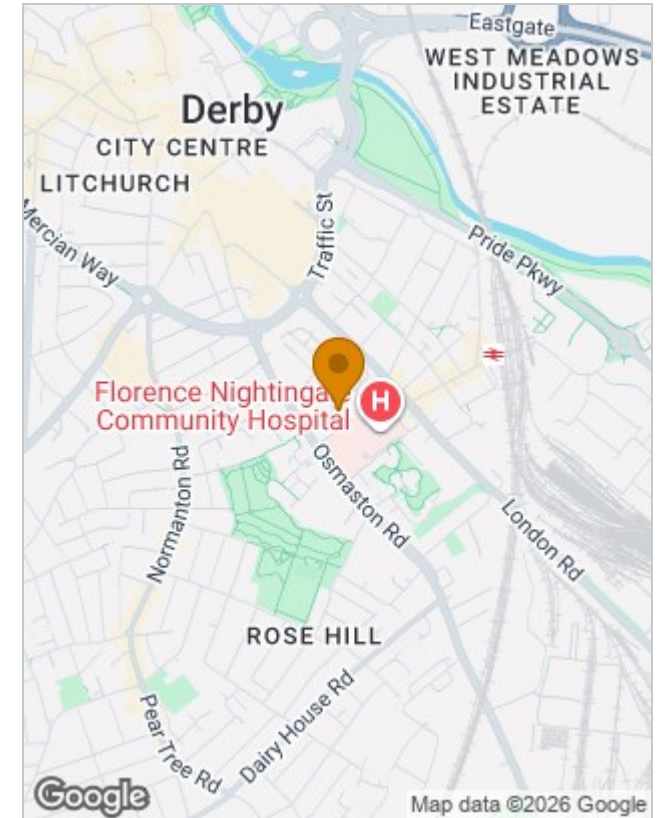

Energy Performance Graph

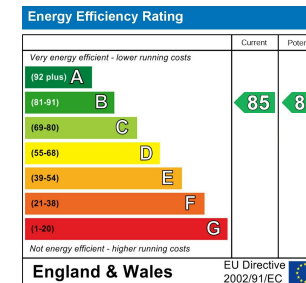

Viewing

Please contact our Lettings Office on 01332 411050 if you wish to arrange a viewing appointment for this property or require further information.

The particulars are set out as a general outline only for the guidance of intended purchasers or lessees, and do not constitute, any part of a contract. Nothing in these particulars shall be deemed to be a statement that the property is in good structural condition or otherwise nor that any of the services, appliances, equipment or facilities are in good working order. Purchasers should satisfy themselves of this prior to purchasing.