



10 SWALE DRIVE

LITTLE CRAKEHALL, BEDALE, DL8 1FZ

£1,295 PCM

Take a look at this contemporary styled three bed semi detached home with a fabulous layout, private garden with attractive views beyond and off street parking. Located in the conveniently positioned village of Little Crakehall, this great home benefits from an air source heat pump, contemporary style and is ideal for Bedale, Leyburn & Richmond as well as the A1(M) for commuters.

NORMAN F. BROWN

Est. 1967

Ground Floor

Approx. 46.6 sq. metres (501.2 sq. feet)

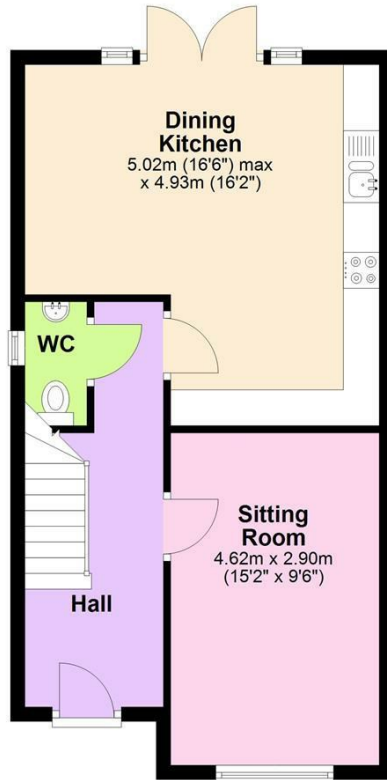

First Floor

Approx. 44.0 sq. metres (474.0 sq. feet)



Total area: approx. 90.6 sq. metres (975.2 sq. feet)



Energy Efficiency Rating		Current	Potential
Very energy efficient - lower running costs			
(92 plus) A			98
(81-91) B		87	
(69-80) C			
(55-68) D			
(39-54) E			
(21-38) F			
(1-20) G			
Not energy efficient - higher running costs			
England & Wales		EU Directive 2002/91/EC	

Agents Note: Whilst every care has been taken to prepare these particulars, they are for guidance purposes only. All measurements are approximate and are for general guidance purposes only and whilst every care has been taken to ensure their accuracy, they should not be relied upon and potential buyers/tenants are advised to recheck the measurements

Bedale Office Lettings
6 Bridge Street
Bedale
North Yorkshire
DL8 2AD

01677 422282
bedale@normanfbrown.co.uk
www.normanfbrown.co.uk

NORMAN F. BROWN

Est. 1967