



**34 ROMAN ROAD, LEEMING,
NORTHALLERTON, DL7 9SW**

**£175,000
FREEHOLD**

A well presented End Terraced House conveniently situated for Bedale, Northallerton and the A1(M). The property benefits from spacious rooms, an enclosed rear garden and garage. The property is perfect for those wanting to put their own stamp onto a home and is offered for sale with no onward chain.

NORMAN F. BROWN

Est. 1967

Ground Floor

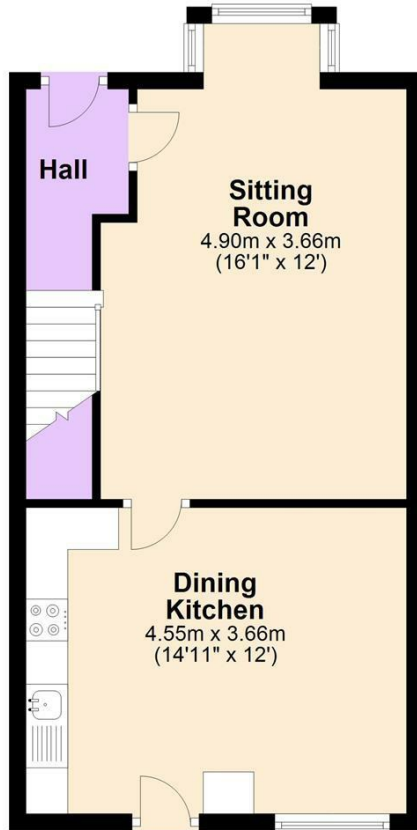

First Floor

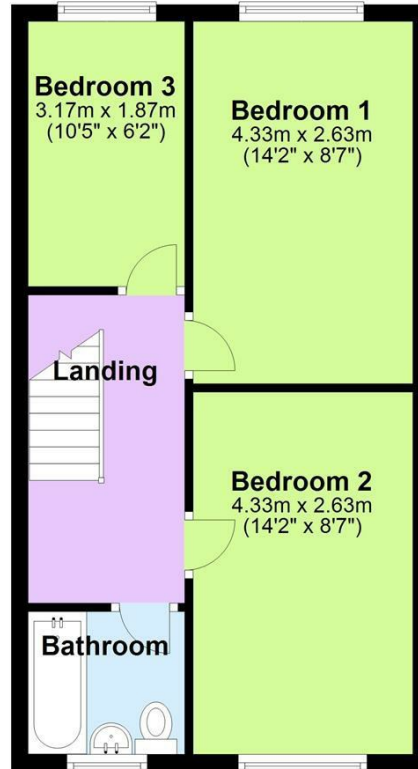

Energy Efficiency Rating		Current	Potential
Very energy efficient - lower running costs			
(92 plus) A			
(81-91) B			
(69-80) C			
(55-68) D			
(39-54) E			
(21-38) F			
(1-20) G			
Not energy efficient - higher running costs			
England & Wales		EU Directive 2002/91/EC	
			81
		55	

Agents Note: Whilst every care has been taken to prepare these particulars, they are for guidance purposes only. All measurements are approximate and are for general guidance purposes only and whilst every care has been taken to ensure their accuracy, they should not be relied upon and potential buyers/tenants are advised to recheck the measurements

Bedale Office Sales
6 Bridge Street
Bedale
North Yorkshire
DL8 2AD

01677 422282
bedale@normanfbrown.co.uk
www.normanfbrown.co.uk

