



56 Willersey Road, Evesham, WR11 7HB

Guide price £210,000



CHRISTIAN  
LEWIS  
—PROPERTY—



# 56 Willersey Road

Evesham, WR11 7HB

- No onward chain
- Popular village location
- Lounge and separate dining room
- Enclosed rear garden and parking space for 1 vehicle
- Two bedroom mid-terrace home
- Opportunity to modernise and personalise
- Ground floor bathroom
- Ideal first-time buy or investment purchase

Offered to the market with no onward chain, this charming two-bedroom mid-terrace home presents an excellent opportunity for buyers looking to put their own stamp on a property. Situated within the sought-after village of Badsey and enjoying attractive countryside views, the property offers well-proportioned accommodation, a private rear garden and off-road parking for one vehicle.

The accommodation briefly comprises an entrance hall, a comfortable lounge to the front and a separate dining room, creating flexible living space ideal for both everyday living and entertaining. To the rear of the property is a generously sized kitchen with a useful utility area and access to the garden, whilst the ground floor bathroom is conveniently positioned between the living accommodation and kitchen.

Upstairs, there are two bedrooms, including a spacious principal bedroom with fitted wardrobes and pleasant open views across neighbouring fields and countryside. The second bedroom offers flexibility as a guest room, nursery or home office.

Externally, the rear garden is predominantly laid to low-maintenance landscaping with a variety of mature planting, useful outbuildings and access leading to the rear parking area, where there is off-road parking for one vehicle.

Located on Willersey Road, the property enjoys a convenient position within the popular village of Badsey, offering easy access to local amenities, countryside walks and nearby Evesham, whilst also being well placed for transport links to surrounding towns and villages.

An ideal purchase for first-time buyers, investors or those seeking a property with scope to personalise, early viewing is highly recommended.



## Additional Information

**Tenure:** We understand that the property for sale is Freehold

**Local Authority:** Wychavon District Council

**Council Tax Band:** We understand that the Council Tax Band for the property is Band B

**EPC Rating** D

## Disclaimer

Whilst we make enquiries with the Seller to ensure the information provided is accurate, Christian Lewis makes no representations or warranties of any kind with respect to the statements contained in the particulars which should not be relied upon as representations of fact. All representations contained in the particulars are based on details supplied by the Seller. Your Conveyancer is legally responsible for ensuring any purchase agreement fully protects your position. Please inform us if you become aware of any information being inaccurate.







## Floor Plans

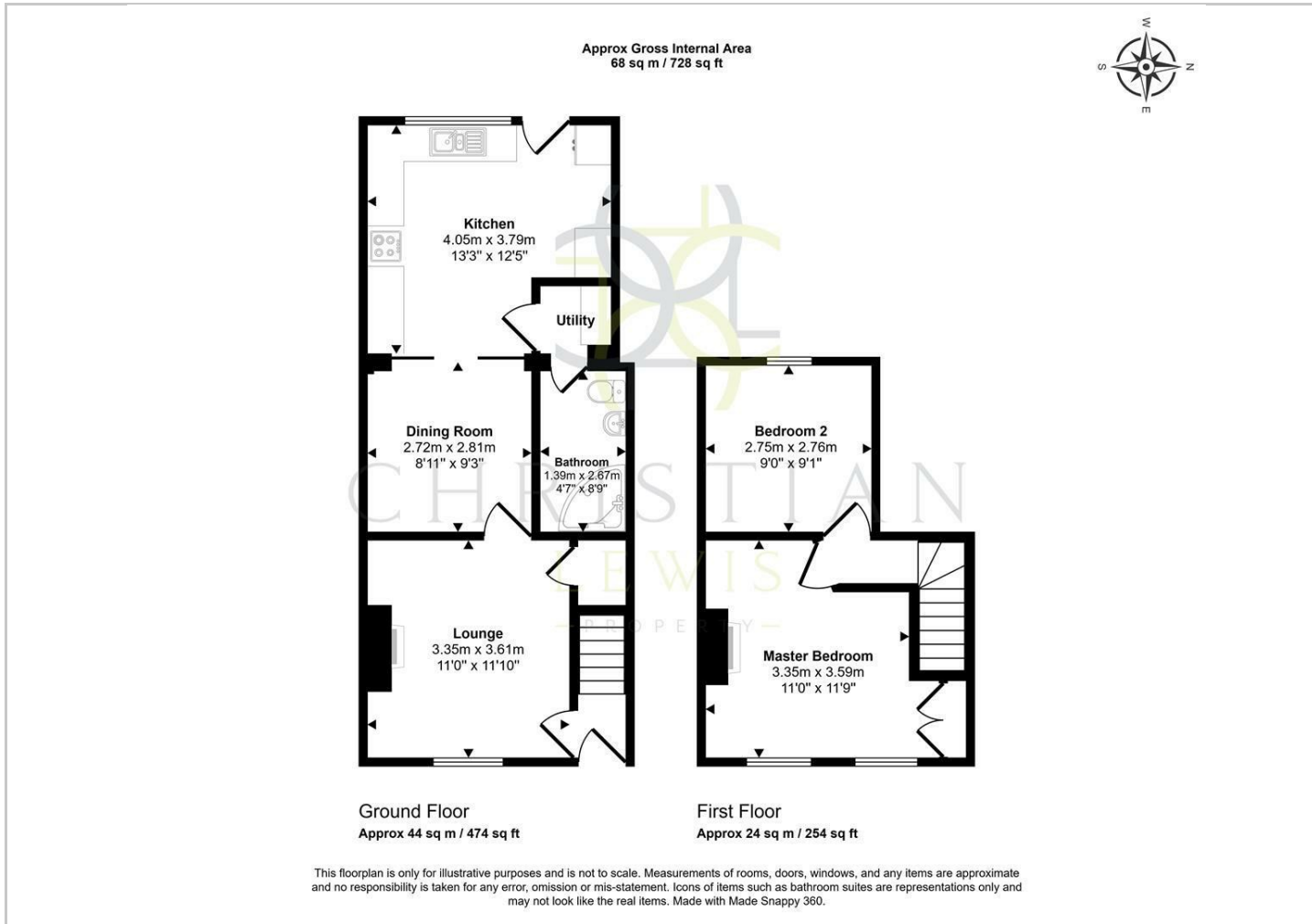

## Location Map

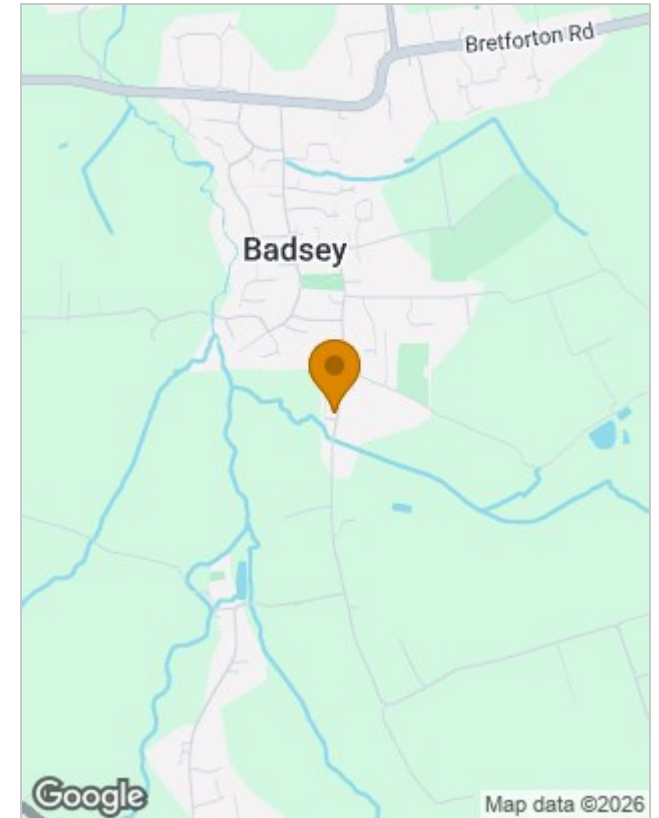

## Energy Performance Graph

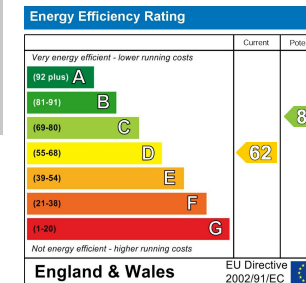

## Viewing

Please contact our Evesham Office on 01386 442929 if you wish to arrange a viewing appointment for this property or require further information.

The particulars are set out as a general outline only for the guidance of intended purchasers or lessees, and do not constitute, any part of a contract. Nothing in these particulars shall be deemed to be a statement that the property is in good structural condition or otherwise nor that any of the services, appliances, equipment or facilities are in good working order. Purchasers should satisfy themselves of this prior to purchasing.