

EDEN MIDCALF
— SALES & LETTINGS —

Furlong Court

PCM

£640 PCM
Furlong Lane

Halesowen, B63 2TH

GROUND FLOOR
377 sq.ft. (35.0 sq.m.) approx.

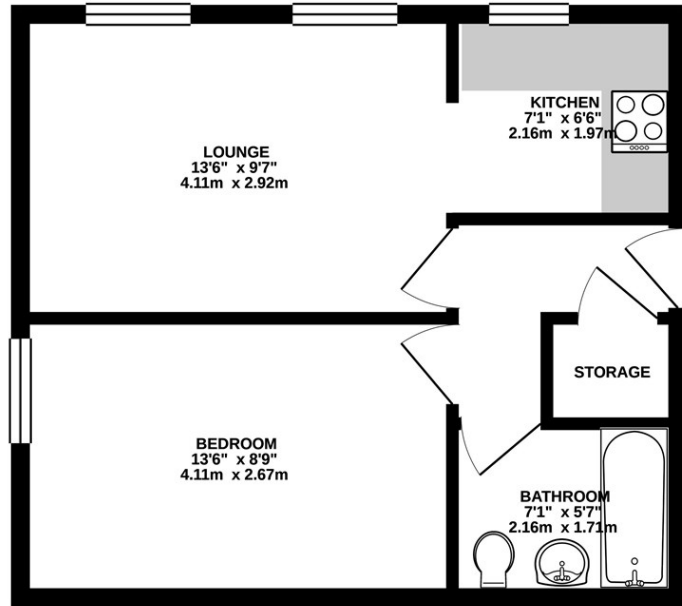

TOTAL FLOOR AREA : 377 sq.ft. (35.0 sq.m.) approx.
Whilst every attempt has been made to ensure the accuracy of the floorplan contained herein, measurements of doors, windows, rooms and any other items are approximate and no responsibility is taken for any error, omission or mis-statement. This plan is for illustrative purposes only and should be used as such by any prospective purchaser. The services, systems and appliances shown have not been tested and no guarantee as to their operability or efficiency can be given.
Made with Metropix ©2021



Energy Efficiency Rating		Current	Potential
Very energy efficient - lower running costs			
(92 plus) A			81
(81-91) B			
(69-80) C			
(55-68) D		60	
(39-54) E			
(21-38) F			
(1-20) G			
Not energy efficient - higher running costs			
England & Wales		EU Directive 2002/91/EC	

Agents Note: Whilst every care has been taken to prepare these particulars, they are for guidance purposes only. All measurements are approximate and are for general guidance purposes only and whilst every care has been taken to ensure their accuracy, they should not be relied upon and potential buyers/tenants are advised to recheck

EDEN MIDCALF
SALES & LETTINGS

42 Hagley Road
Stourbridge
West Midlands
DY8 1QD

01384 443434
lettings@edenmidcalf.co.uk
<https://www.edenmidcalf.co.uk/>
us/