



EDEN MIDCALF
— SALES & LETTINGS —

£288,000
Lime Grove
Stourbridge, DY7 6JQ

PROPERTY SUMMARY

A well presented two bedroom semi-detached house enjoying views towards a green situated opposite and located within a popular address in historic Kinver village. The property is within easy reach of village amenities and offers a well proportioned and attractively appointed layout, plus off-road parking for two cars, a garage and a beautifully landscaped rear garden. Available with No Upward Chain.

2



1



1





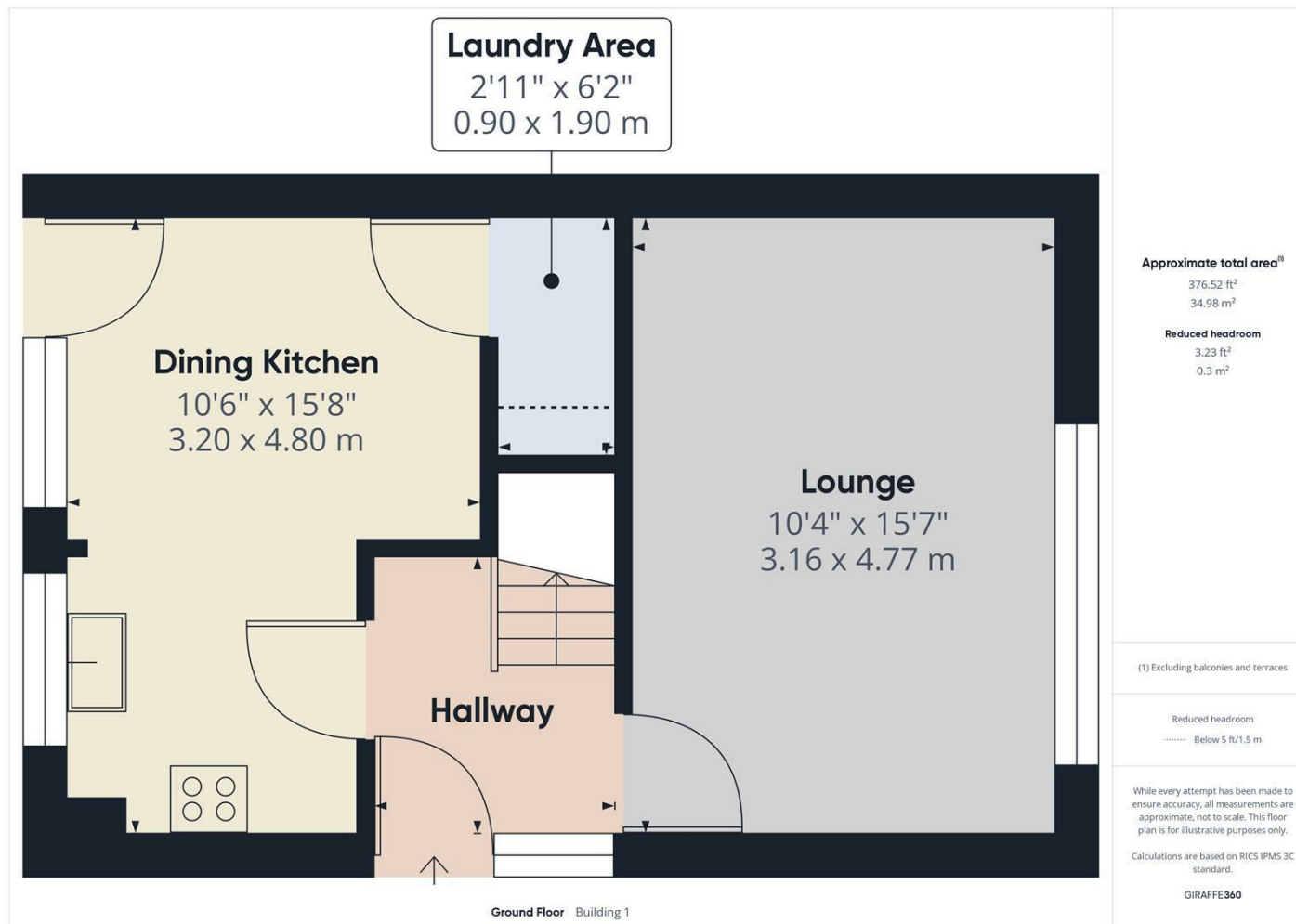

LOCAL AUTHORITY
South Staffordshire District Council

TENURE
Freehold

COUNCIL TAX BAND
C

VIEWINGS
By prior appointment only

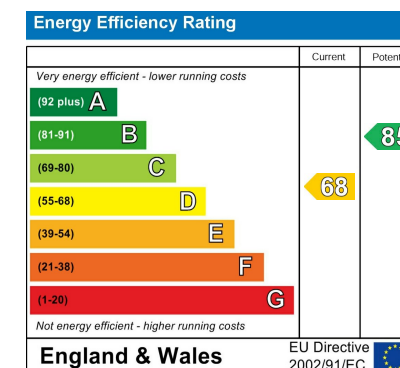

Agents Note: Whilst every care has been taken to prepare these particulars, they are for guidance purposes only. All measurements are approximate and are for general guidance purposes only and whilst every care has been taken to ensure their accuracy, they should not be relied upon and potential buyers/tenants are advised to recheck the measurements.

EDEN MIDCALF
SALES & LETTINGS

28 High Street
Kinver
DY7 6HF

01384 878000

<https://www.edenmidcalf.co.uk/us/>