

EDEN MIDCALF  
— SALES & LETTINGS —

ASKING PRICE

£205,000

Cedar Grange

Kinver, DY7 6BN

## PROPERTY SUMMARY

A luxury, high specification, one bedroom, ground floor apartment within historic and much sought after Kinver. Well placed for amenities within Kinver's thriving High Street and close to wonderful greenbelt countryside, the apartment offers generous accommodation, plus secure off-road car parking.

1



1



1







GROUND FLOOR  
810 sq.ft. (75.3 sq.m.) approx.

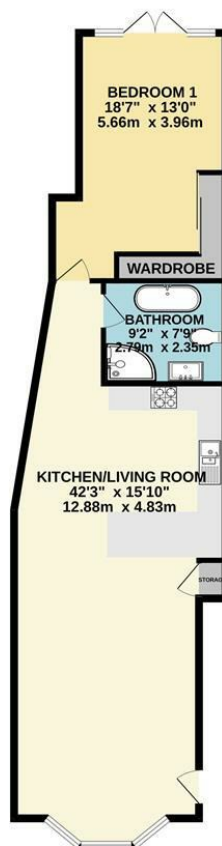

TOTAL FLOOR AREA : 810 sq.ft. (75.3 sq.m.) approx.

Whilst every attempt has been made to ensure the accuracy of the floorplan contained here, measurements of doors, windows, rooms and any other items are approximate and no responsibility is taken for any error, omission or mis-statement. This plan is for illustrative purposes only and should be used as such by any prospective purchaser. The services, systems and appliances shown have not been tested and no guarantee as to their operability or efficiency can be given.  
Made with Metropix ©2023

**LOCAL AUTHORITY**  
South Staffordshire Council

**TENURE**  
Leasehold

**COUNCIL TAX BAND**  
B

**VIEWINGS**  
By prior appointment only

Energy Efficiency Rating		
	Current	Potential
Very energy efficient - lower running costs		
(92 plus) <b>A</b>		
(81-91) <b>B</b>		
(69-80) <b>C</b>		
(55-68) <b>D</b>		
(39-54) <b>E</b>		
(21-38) <b>F</b>		
(1-20) <b>G</b>		
Not energy efficient - higher running costs		
<b>England &amp; Wales</b>	EU Directive 2002/91/EC	

Agents Note: Whilst every care has been taken to prepare these particulars, they are for guidance purposes only. All measurements are approximate and are for general guidance purposes only and whilst every care has been taken to ensure their accuracy, they should not be relied upon and potential buyers/tenants are advised to recheck the measurements.

**EDEN MIDCALF**  
— SALES & LETTINGS —

28 High Street  
Kinver  
DY7 6HF

01384 878000

[https://www.edenmidcalf.co.uk/  
us/](https://www.edenmidcalf.co.uk/us/)