



EDEN MIDCALF  
— SALES & LETTINGS —

PCM

**£1,000 PCM**  
**Drake Crescent**

Kidderminster, DY11 6EE



## 30 Drake Crescent

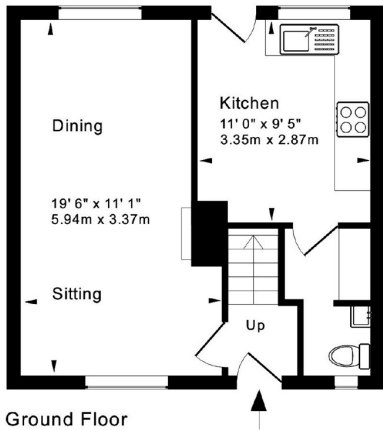

Ground Floor

Approx. Gross Internal Floor Area House: 885 Sq. Ft. / 82.5 Sq. M  
Includes Conservatories, Garages, Porches etc.  
Plan Ref. 300-374j

This plan is for guidance only and must not be relied upon as a statement of fact. Attention is drawn to the Important Notice on the last page of text of the Particulars.

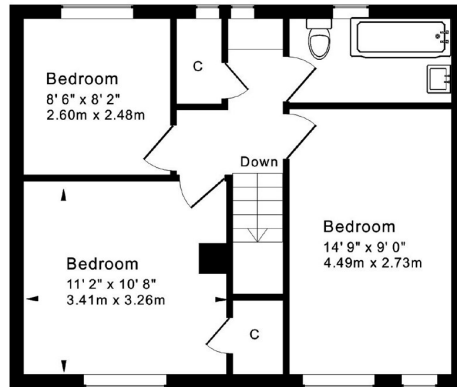

First Floor



Energy Efficiency Rating		Current	Potential
Very energy efficient - lower running costs			
(92 plus)	A		
(81-91)	B		
(69-80)	C		
(55-68)	D		
(39-54)	E		
(21-38)	F		
(1-20)	G		
Not energy efficient - higher running costs			
England & Wales		57	71
		EU Directive 2002/91/EC	

Agents Note: Whilst every care has been taken to prepare these particulars, they are for guidance purposes only. All measurements are approximate and are for general guidance purposes only and whilst every care has been taken to ensure their accuracy, they should not be relied upon and potential buyers/tenants are advised to recheck

**EDEN MIDCALF**  
— SALES & LETTINGS —

42 Hagley Road  
Stourbridge  
West Midlands  
DY8 1QD

01384 443434  
lettings@edenmidcalf.co.uk  
<https://www.edenmidcalf.co.uk/>