

EDEN MIDCALF  
— SALES & LETTINGS —

PCM

£925 PCM  
Eleanor Harrison Drive

Kidderminster, DY10 3TY



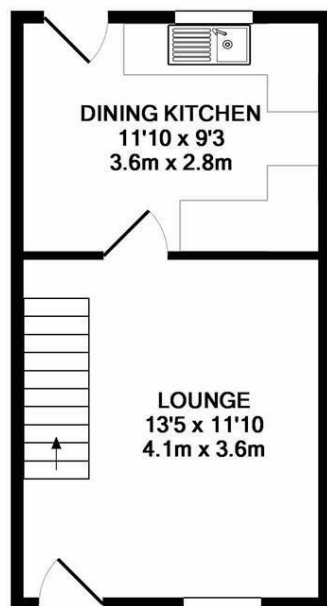

GROUND FLOOR

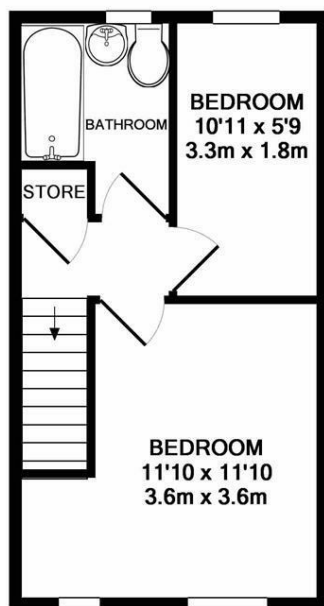

1ST FLOOR



Whilst every attempt has been made to ensure the accuracy of the floor plan contained here, measurements of doors, windows, rooms and any other items are approximate and no responsibility is taken for any error, omission, or mis-statement. This plan is for illustrative purposes only and should be used as such by any prospective purchaser. The services, systems and appliances shown have not been tested and no guarantee as to their operability or efficiency can be given  
Made with Metropix ©2019

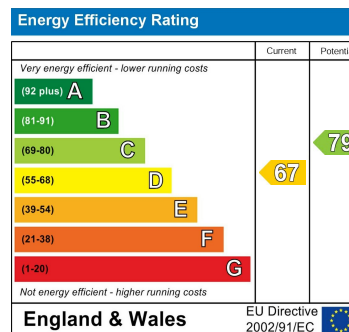

Agents Note: Whilst every care has been taken to prepare these particulars, they are for guidance purposes only. All measurements are approximate and are for general guidance purposes only and whilst every care has been taken to ensure their accuracy, they should not be relied upon and potential buyers/tenants are advised to recheck

**EDEN MIDCALF**  
SALES & LETTINGS

42 Hagley Road  
Stourbridge  
West Midlands  
DY8 1QD

01384 443434  
lettings@edenmidcalf.co.uk  
<https://www.edenmidcalf.co.uk/>