



BRECHIN PLACE, SOUTH KENSINGTON, LONDON SW7

£810 per week (£3,510 pcm)

FEATURES

- Two bedroom two bathroom apartment
- Presented in excellent decorative order
- high ceilings and lots of natural light
- 0.3 miles to South Kensington tube and Fulham Road
- Cool and contemporary flat with wood flooring throughout
- Built in storage in both bedrooms
- Quiet residential street



Maskells

9 Brechin Place, London, SW7
TOTAL AREA: 68.9 m² - 741 ft²

▼ 2nd Floor

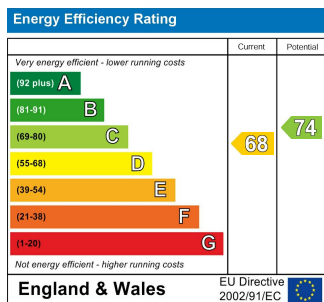
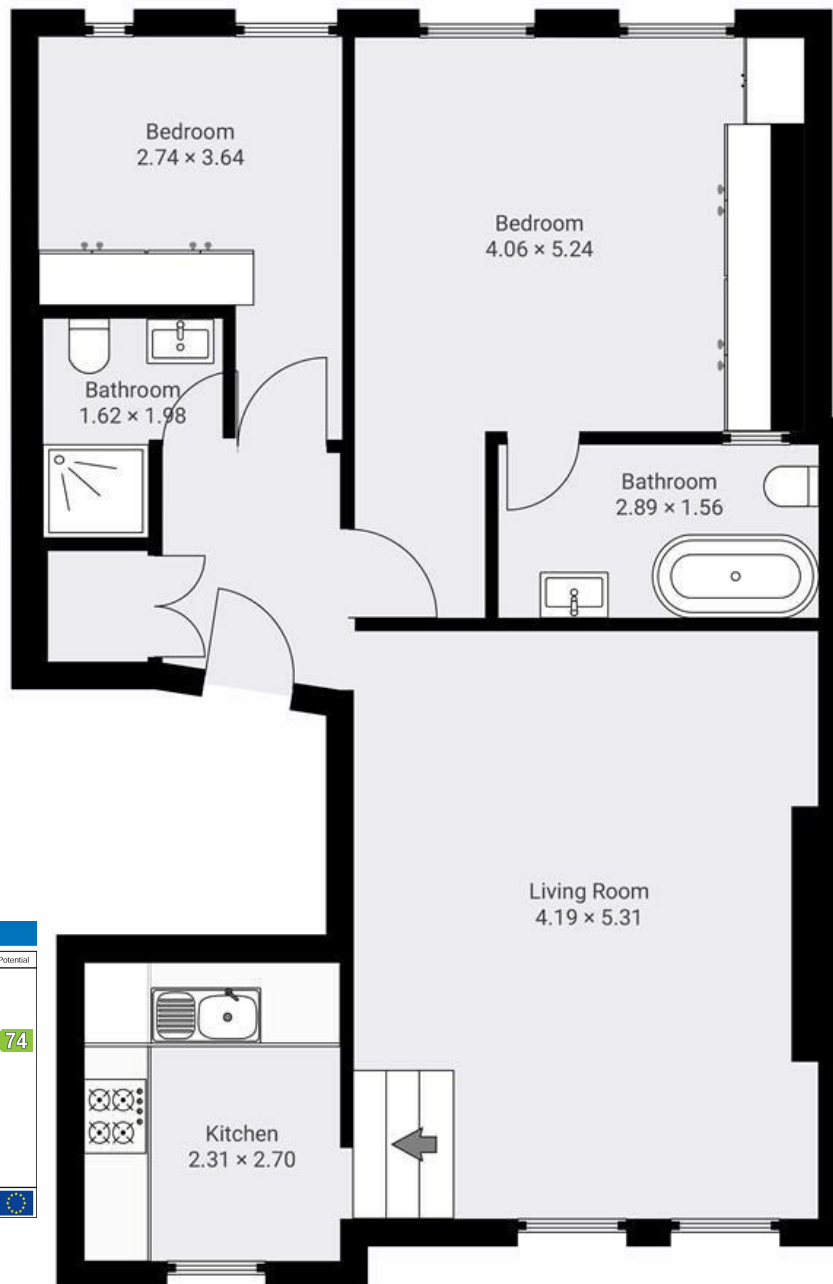

All measurements are approximate and for display purposes only

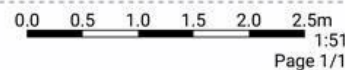

Call us on 0207 581 2216

lettings@maskells.com

www.maskells.com

Council Tax Band F

A stylish and beautifully presented two bedroom two bathroom apartment, situated on the second floor of a period building, located on a quiet residential street just off Gloucester Road and only a short walk (0.3 miles) from both South Kensington underground station and Fulham Road.

The apartment, which extends to over 740 Sq. ft, offers wood flooring throughout which, allied to high ceilings and period features, create a cool and contemporary feel. This look is augmented by the modern bath and shower rooms and the flat further benefits from excellent storage by way of the bespoke cupboards in both bedrooms. EPC D.

All potential tenants should be advised that administration fees may be applicable when renting a property. Please contact us for more details of these charges. Maskells are members of Propertymark the leading membership body for property agents. We are part of the Propertymark Client Money Protection scheme and a member of The Property Ombudsman Scheme (approved by the Office of Fair Trading) and subscribe to its Codes of Practice for Letting Agents.

Agents Note: Whilst every care has been taken to prepare these particulars, they are for guidance purposes only. All measurements are approximate and are for general guidance purposes only and whilst every care has been taken to ensure their accuracy, they should not be relied upon and potential buyers are advised to recheck the measurements.

Maskells