



# FAWCETT STREET, LONDON, SW10

## £575 Per Week

### FEATURES

- Newly redecorated 1 bedroom apartment
- Large bright reception room and separate eat-in kitchen
- Raised ground floor
- Well proportioned with 518 Sq ft of internal accommodation
- 0.3 miles to King's Road
- 0.6 miles to Earls Court tube



# Maskells

A most charming and desirable 1 bedroom apartment, situated on the raised ground floor of an end of terrace period building. The flat, which offers 518 Sq ft (circa 50 Sq m) of internal accommodation, has been newly redecorated and is presented in excellent condition. Of particular note is the large reception room with high ceilings and a beautiful bay window overlooking the street, as well as the fully fitted eat-in kitchen (including a dishwasher) and quiet double bedroom with built in wardrobes and large window with juliet balcony.

Fawcett Street is conveniently located on a few minutes walk from the array of amenities offered on King's Road and Fulham Road, and only 0.6 miles from Earls Court tube (Piccadilly, District and Circle lines). EPC D.

Call us on  
**0207 581 2216**

**lettings@maskells.com**  
**www.maskells.com**

Council Tax Band  
**E**

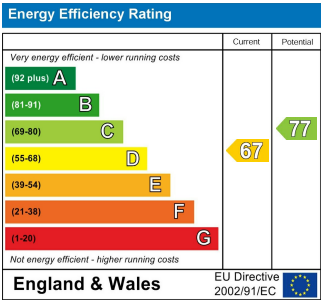
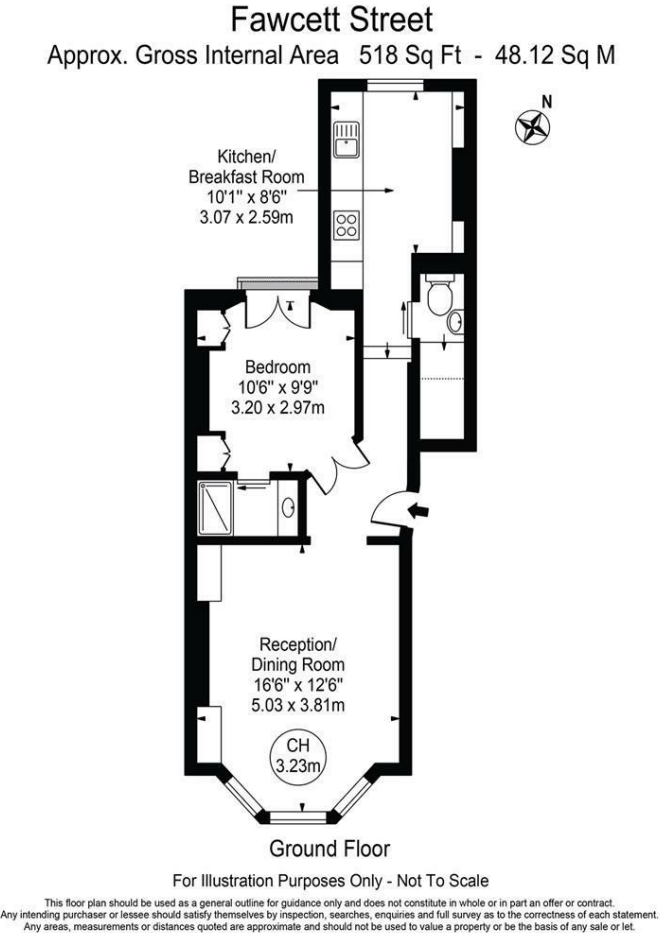

Agents Note: Whilst every care has been taken to prepare these particulars, they are for guidance purposes only. All measurements are approximate and are for general guidance purposes only and whilst every care has been taken to ensure their accuracy, they should not be relied upon and potential buyers are advised to recheck the measurements.

