



The Marlborough
Walton Street, SW3



A beautifully presented one-bedroom apartment set within The Marlborough, an attractive building on Walton Street on the border of Chelsea and Knightsbridge.



Accommodation and Amenities

- One-bedroom apartment
- Bright reception room with fitted shelving
- Separate modern kitchen with good storage
- Double bedroom with fitted wardrobes
- Communal courtyard
- Portered building





The apartment is bright and well arranged, with a generous reception room featuring large windows, bespoke fitted shelving and a calm neutral finish throughout. The space works well for both relaxing and entertaining, with a stylish, contemporary feel.

The separate kitchen is modern and practical, offering sleek cabinetry, good storage and workspace. The double bedroom benefits from fitted wardrobes, while the bathroom is finished in a clean, contemporary style with a walk-in shower and chrome fittings.

The building also enjoys access to a smart communal courtyard, creating a peaceful outdoor setting for residents.

Located on Walton Street, the apartment is ideally placed for the boutiques, cafés and restaurants of Chelsea, South Kensington and Knightsbridge, with King's Road, Sloane Square and the amenities of SW3 all within easy reach.





APPROXIMATE GROSS INTERNAL AREA

459 Sq Ft / 42.64 Sq M

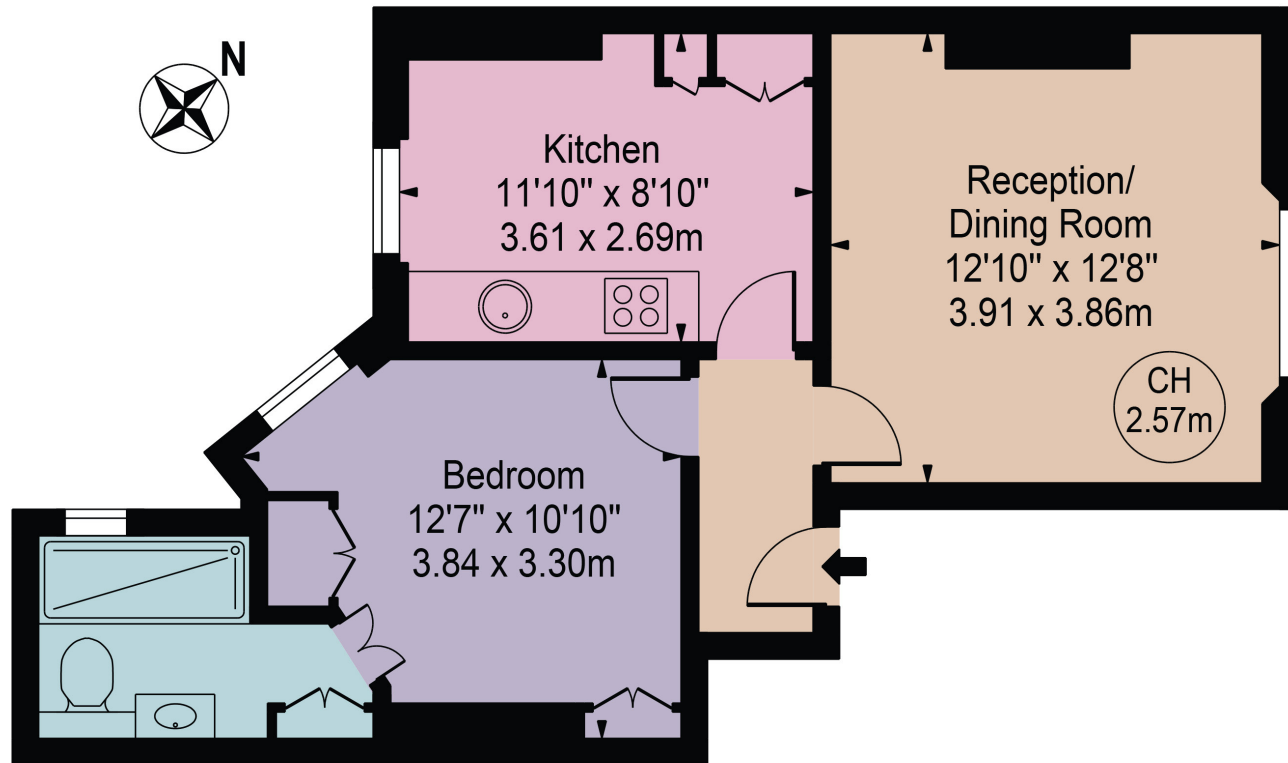

RAISED GROUND FLOOR

We wish to advise prospective purchasers that we have prepared these sales particulars as a rough guide. We have not carried out a detailed survey or tested the services, appliances or specific fittings. Measurements are approximate.

ASKING PRICE

£725,000

TENURE

Share of Freehold - 999 years from 25th December 1991

SERVICE CHARGE

£4,123.96 per annum

GROUND RENT

Peppercorn

LOCAL AUTHORITY

The Royal Borough of Kensington and Chelsea

COUNCIL TAX BAND

F

EPC RATING

C



71 Walton Street, London, SW3 2HT

Tel: 020 7581 2216

sales@maskells.com

lettings@maskells.com

maskells.com

We wish to advise prospective purchasers that we have prepared these sales particulars as a rough guide. We have not carried out a detailed survey or tested the services, appliances or specific fittings. Measurements are approximate.