

BENSON HOUSE
KENSINGTON, W14





Located in the recently concluded Royal Warwick Square development is the wonderful, split level, 2-bedroom flat. The flat benefits from a large, open plan living and kitchen which optimises modern living in a sought after and award winning development.

A beautifully designed split-level apartment located in the prestigious 375 Kensington High Street development. Situated within the elegant Benson House, this two-bedroom duplex features two luxurious en-suite bathrooms and a spacious open-plan kitchen and living area. The apartment benefits from a desirable west-facing aspect, flooding the space with natural light through floor-to-ceiling windows, creating a bright and airy atmosphere.

The bedrooms are positioned on the lower level, offering a sense of separation and privacy—ideal for those seeking the feel of a London city townhouse.

Residents enjoy access to a 24-hour concierge and security service, along with exclusive amenities including a fully equipped gym, swimming pool, private cinema, and spa facilities.



- Stylish split-level duplex apartment
- Two en-suite bedrooms
- Bright, west facing aspect with floor to ceiling windows
- Exclusive access to concierge and amenities



GROSS INTERNAL AREA (APPROX.)

1,294 sq m (120.2 sq ft)

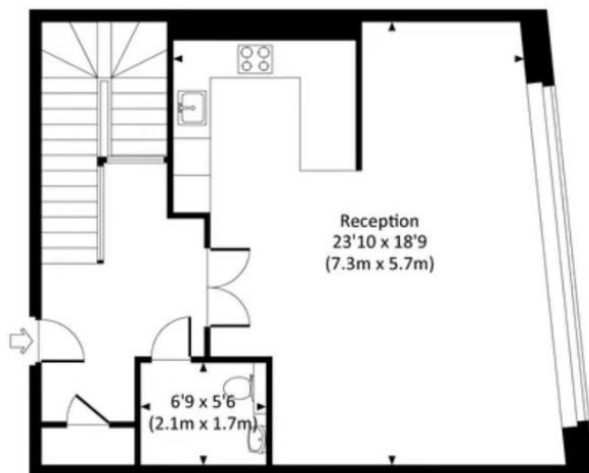

GROUND FLOOR



LOWER GROUND FLOOR

TERMS

Asking Price: £1,300,000

Tenure: Leasehold 999 years from 1 January 2011

EPC: C

Council Tax Band: G

Local Authority: Royal Borough of
Kensington and Chelsea

Let's talk Mortgages Maskells has
partnered with Private Finance, an independent
mortgage broker, directly authorised with specialist
knowledge and whole of market access. **CLICK**
HERE Privatefinance@maskells.com

Your home may be repossessed if you do not keep up
repayments on your mortgage

Maskells

71 Walton Street, London SW3 2HT

Tel: 0207 581 2216

sales@maskells.com

lettings@maskells.com

maskells.com

We wish to advise prospective purchasers that we have prepared these sales particulars as a rough guide. We have not carried out a detailed survey or tested the services, appliances or specific fittings. Measurements are approximate.