



**5 Wellingar Close**

Thorpe Astley, Braunstone, LE3 3SA

**£1,250**





Available End of September! Located in Thorpe Astley in a CUL-DE-SAC location is this well presented three bedroom detached home.

The property comprises of; entrance hall with cloaks hanging, downstairs cloaks / WC, living room, open plan family dining kitchen with storage cupboard, conservatory with views over the garden.

On the first floor the landing gives way to three bedrooms with a range of fitted bedroom furniture to the master, and a family bathroom.

Outside is a front garden with a driveway providing off road parking. To the rear there are private and enclosed gardens with tree lined rear aspect. EPC Rating C

- Detached Family Home
- Three Bedrooms
- Downstairs Cloaks / WC
- Cul De Sac Setting
- Off Road Parking
- Enclosed Rear Garden
- Internet - Standard, Superfast & Ultrafast Available
- Council Tax Band C
- EPC Rating C
- GARAGE NOT INCLUDED



**Tenancy Information**

- Price : £1250.00
- Holding Deposit: £288.00
- Deposit : £1442.00 (including the holding deposit)
- Length of tenancy : 12 Months
- Council tax band : C

**GARAGE**

GARAGE NOT INCLUDED





Floor Plan

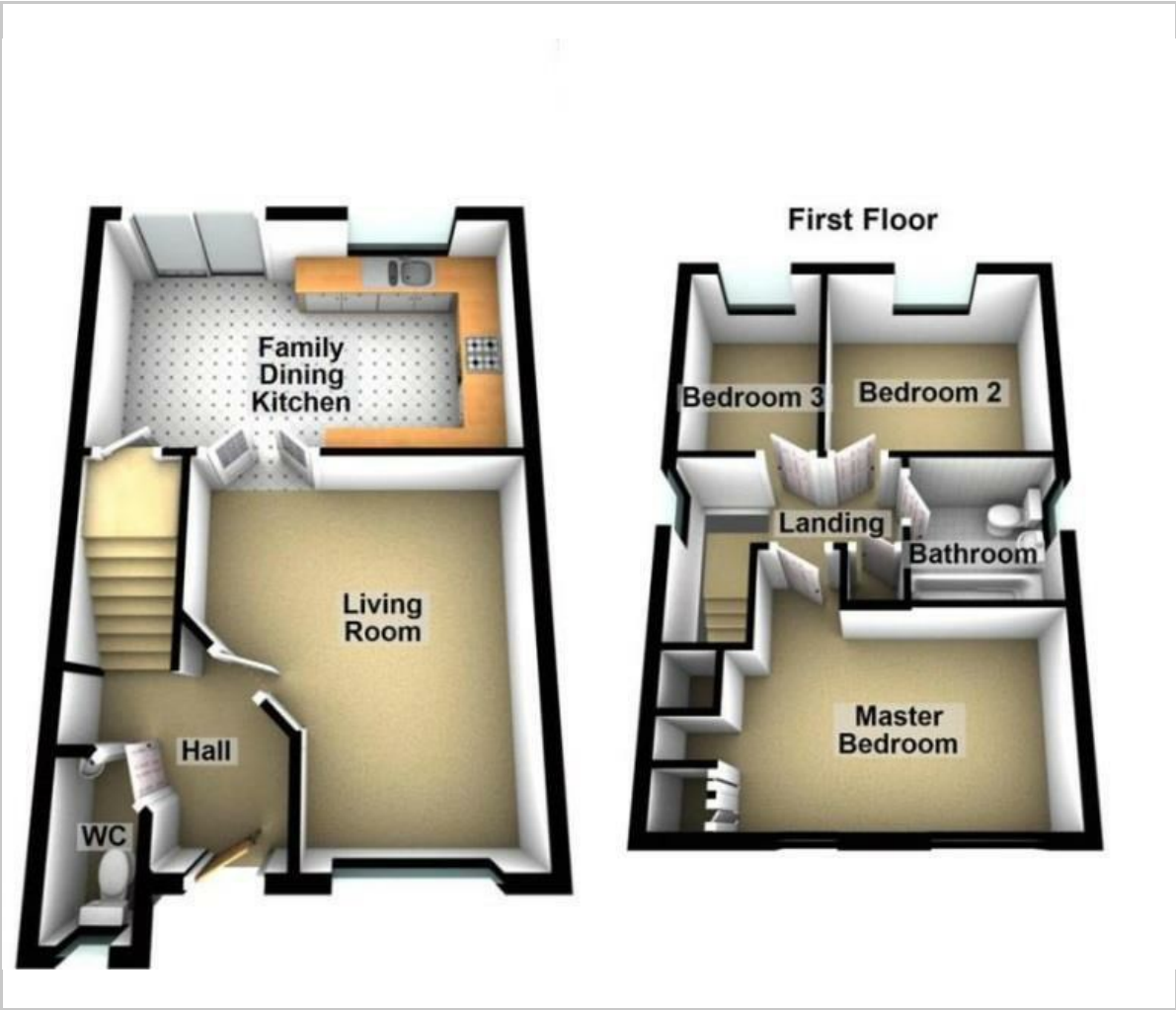

Viewing

Please contact our Wigston Lettings Office on 0116 2883872 if you wish to arrange a viewing appointment for this property or require further information.

These particulars, whilst believed to be accurate are set out as a general outline only for guidance and do not constitute any part of an offer or contract. Intending purchasers should not rely on them as statements of representation of fact, but must satisfy themselves by inspection or otherwise as to their accuracy. No person in this firms employment has the authority to make or give any representation or warranty in respect of the property.

67 67 Long Street, Wigston, Leicestershire, LE18 2AJ  
Tel: 0116 2883872 Email: [lettings@astonandco.co.uk](mailto:lettings@astonandco.co.uk)  
<https://astonandco.co.uk/>

Area Map



Energy Efficiency Graph

