



9 Nidderdale Road  
, Wigston Meadows, LE18 3XW  
**£950 Per Month**





Available Now! This Two Bedroom mid town house is well presented throughout and ready to let. The property is located on Nidderdale Road on the Wigston Meadows Estate. Features and benefits include: Gas central heating, upvc double glazing, fitted kitchen & bathroom, front & rear gardens and off road parking. Internal viewing is essential to avoid disappointment.

- Two Double Bedrooms
- Town House
- Available Immediately.
- Integrated Fridge Freezer
- Gas Centreal Heating & Double Glazed
- Enclosed Rear Garden
- Close to Local Schools & Local Amenities
- Internet - see Ofcom Checker
- Council Tax Band B
- EPC Rating D



### Viewing Arrangements

Please note, as part of the process and services to our landlord, all prospected tenants must view the property before submitting an application. For your application to be considered by the landlord, all adults must fill out one of our application forms following on from the viewing with one of our agents.

### Tenancy Information

- Price : £950.00 PCM
- Holding Deposit: £219.00 (one weeks rent)
- Deposit : £1096.00 (including the holding deposit)
- Length of tenancy : 6 Months
- Council tax band : B





Floor Plan

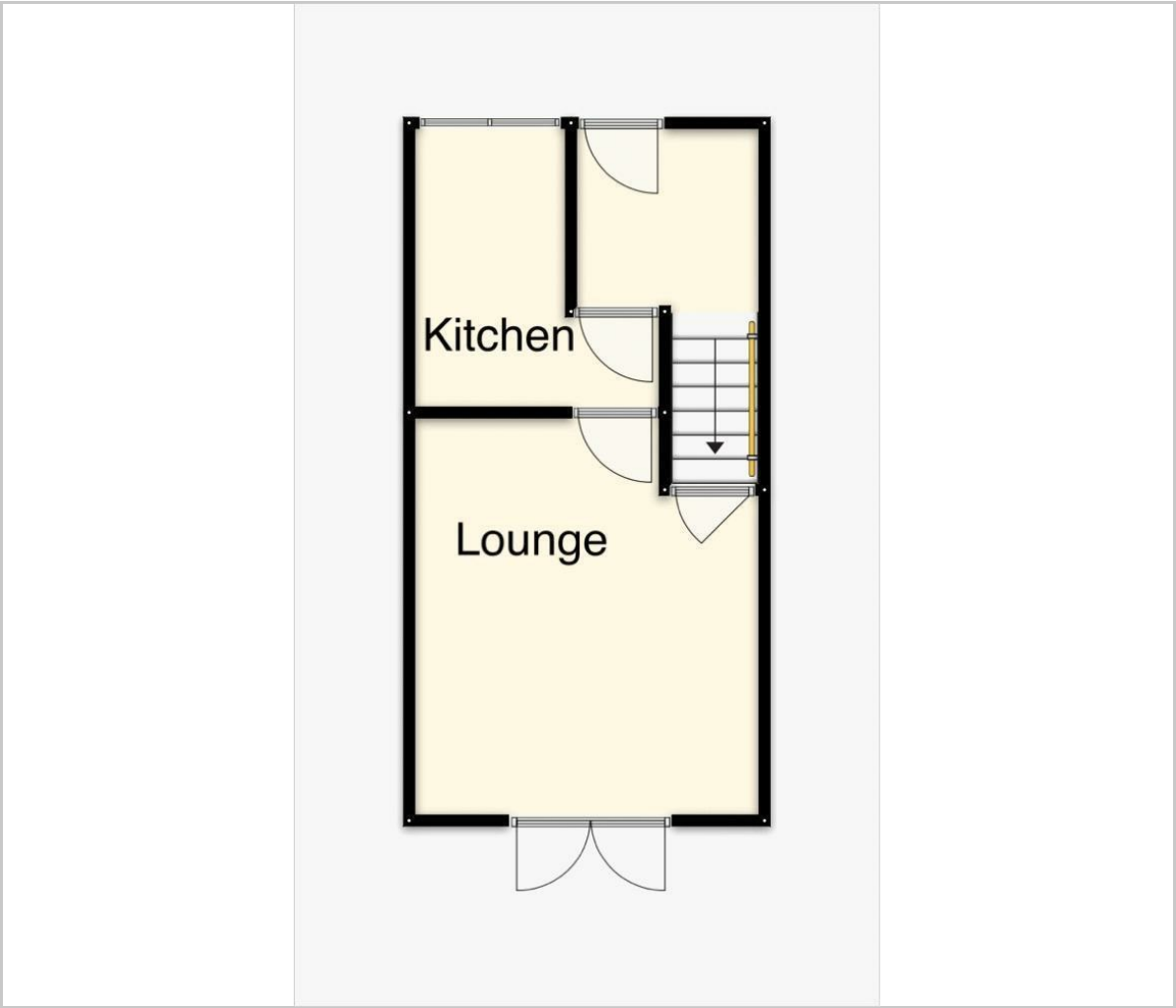

Viewing

Please contact our Wigston Lettings Office on 0116 2883872 if you wish to arrange a viewing appointment for this property or require further information.

These particulars, whilst believed to be accurate are set out as a general outline only for guidance and do not constitute any part of an offer or contract. Intending purchasers should not rely on them as statements of representation of fact, but must satisfy themselves by inspection or otherwise as to their accuracy. No person in this firms employment has the authority to make or give any representation or warranty in respect of the property.

67 67 Long Street, Wigston, Leicestershire, LE18 2AJ  
Tel: 0116 2883872 Email: [lettings@astonandco.co.uk](mailto:lettings@astonandco.co.uk)  
<https://astonandco.co.uk/>

Area Map

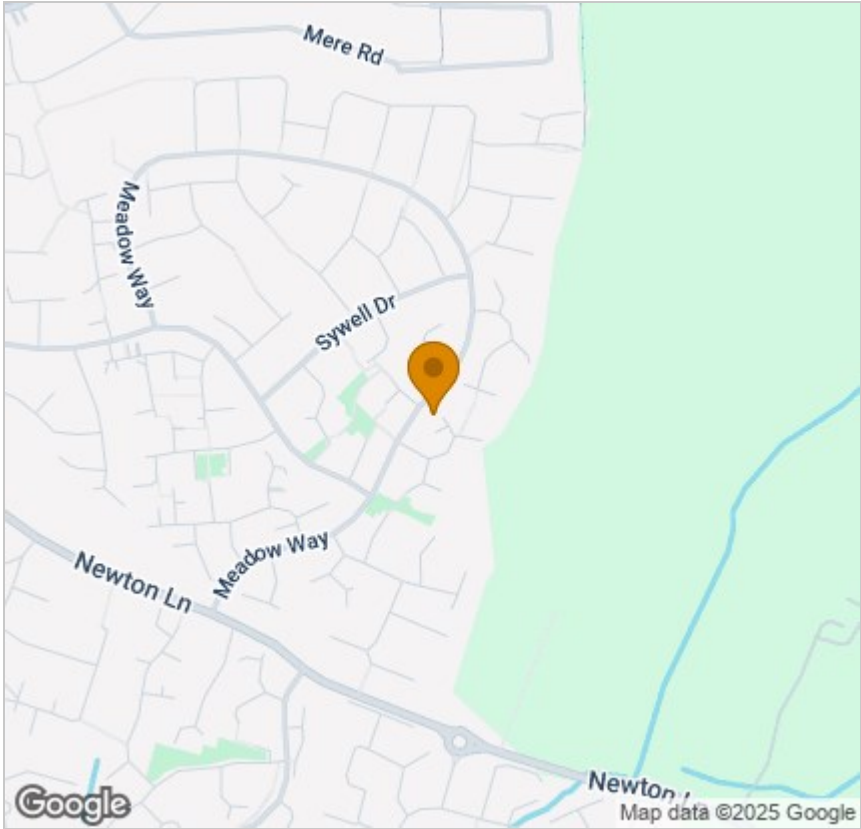

Energy Efficiency Graph

