



38 Stretton Road
Great Glen, Leicester, LE8 9GN
Offers In Excess Of £500,000

Aston & Co
Exclusive Homes

THE GUILD
PROPERTY
PROFESSIONALS



COMING SOON, THIS SUPERBLY PRESENTED FAMILY HOME IN THE HIGHLY DESIRABLE SOUTH LEICESTERSHIRE VILLAGE OF GREAT GLEN. MIDWAY BETWEEN LEICESTER & MKT HARBOROUGH, EXCELLENT TRANSPORT LINKS, CONVENIENT FOR STATE & PRIVATE SCHOOLING

- DETACHED FAMILY HOME
- BEAUTIFULLY PRESENTED
- 2 RECEPTION ROOMS
- REFITTED KITCHEN WITH UTILITY ROOM
- GROUND FLOOR WC
- 4 BEDROOMS
- RE FITTED BATHROOM
- VILLAGE LOCATION WITH RIVER / FIELD VIEWS
- COUNCIL TAX BAND E EPC RATING tbc
- Available Broadband - standard - superfast . Ultrafast See ofcom broadband checker



▪ This charming 4 bedroom village home with riverside views will be available to view after 11th Feb. Contact us now for more information, to express your interest and arrange a viewing

Floor Plan

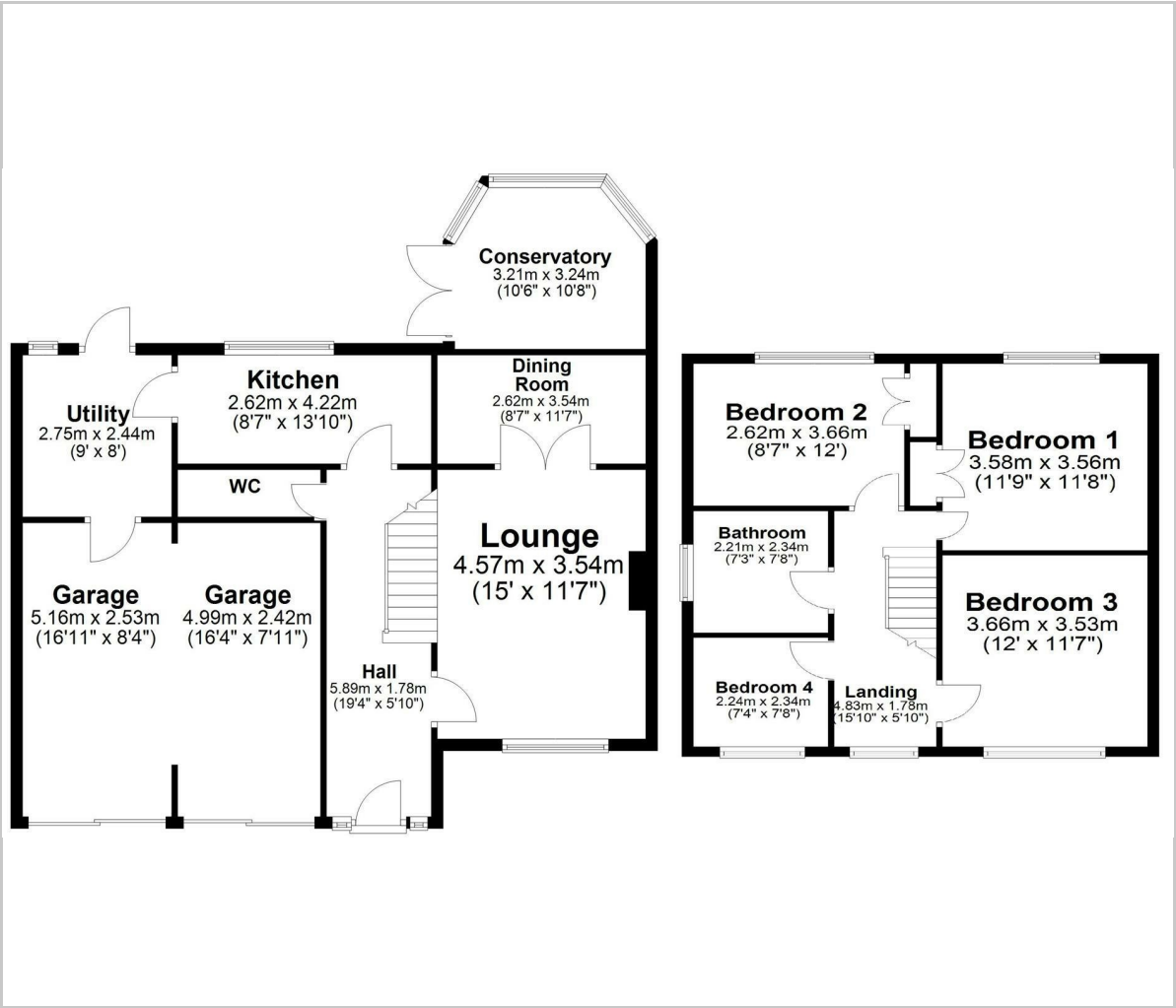

Viewing

Please contact our Wigston Sales Office on 0116 2883872 if you wish to arrange a viewing appointment for this property or require further information.

These particulars, whilst believed to be accurate are set out as a general outline only for guidance and do not constitute any part of an offer or contract. Intending purchasers should not rely on them as statements of representation of fact, but must satisfy themselves by inspection or otherwise as to their accuracy. No person in this firms employment has the authority to make or give any representation or warranty in respect of the property.

Aston & Co Estate Agents 67 Long Street, Wigston, Leicestershire, LE18 2AJ
Tel: 0116 2883872 Email: info@astonandco.co.uk <https://astonandco.co.uk/>

Area Map

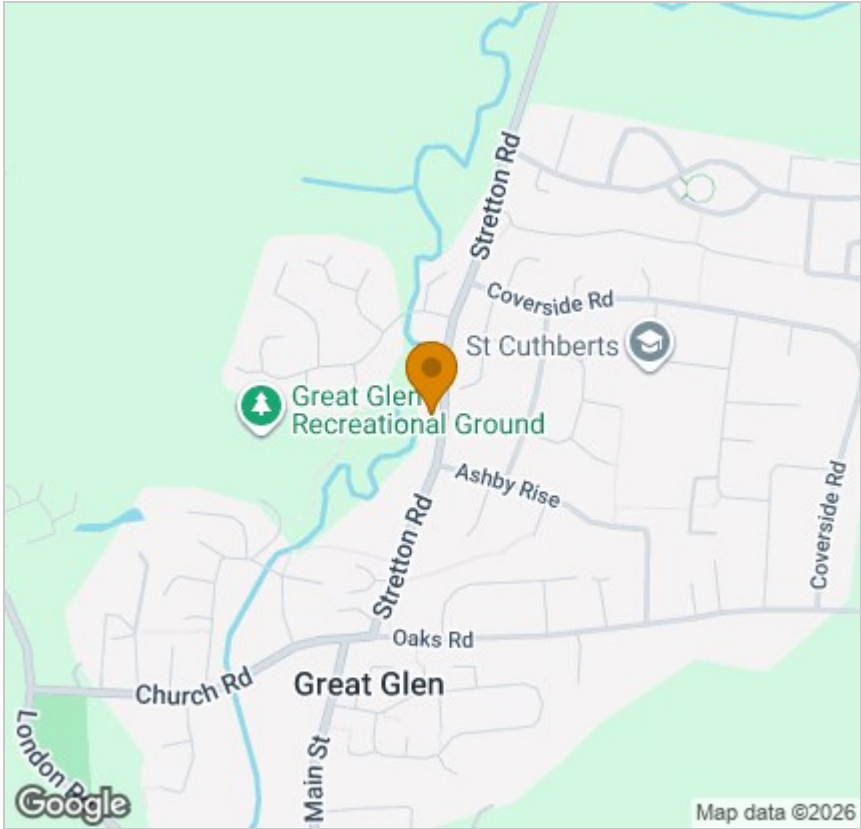

Energy Efficiency Graph

