



Heron Drive, Audenshaw,

 1 |  1 |  0

£70,000



Property Details

Heron Drive, Audenshaw,

Key Features

Studio Apartment – Audenshaw INVESTORS AND CASH BUYERS ONLY

Located in a lovely, quiet cul-de-sac, this well-presented first floor studio apartment offers a cosy and convenient home, perfect for those seeking low-maintenance living.

The property is offered part furnished and includes a kitchen table with chairs and a comfortable two-seater sofa. The kitchen has space for a washer dryer, making it practical as well as stylish.

Situated in a sought-after area of Audenshaw, the apartment is ideally positioned close to the motorway network, providing excellent transport links for commuters.

A great opportunity for a first time buyer or anyone looking for a compact and welcoming home in a peaceful setting.

Cash buyers only

Bedroom Area

2.81 x 2.67m

Studio bedroom area with space for a double bed

Lounge Kitchen Area

4.05 x 3.07m

Open plan kitchen dining living room

Bathroom

3.6 x 1.2m

Three piece white suite with shower over bath



At Spencer Harvey, we are delighted to say that we are independent estate agents, which means that we will put your needs first at all times. If you want to learn more about why we are amongst the fastest growing independent estate agents in Manchester, please get in touch to arrange an appointment.



Contact Us



137 Shaw Heath Stockport



0161 480 8888



Sales@spencerharvey.co.uk

www.spencerharvey.co.uk

OR SEND US A
MESSAGE

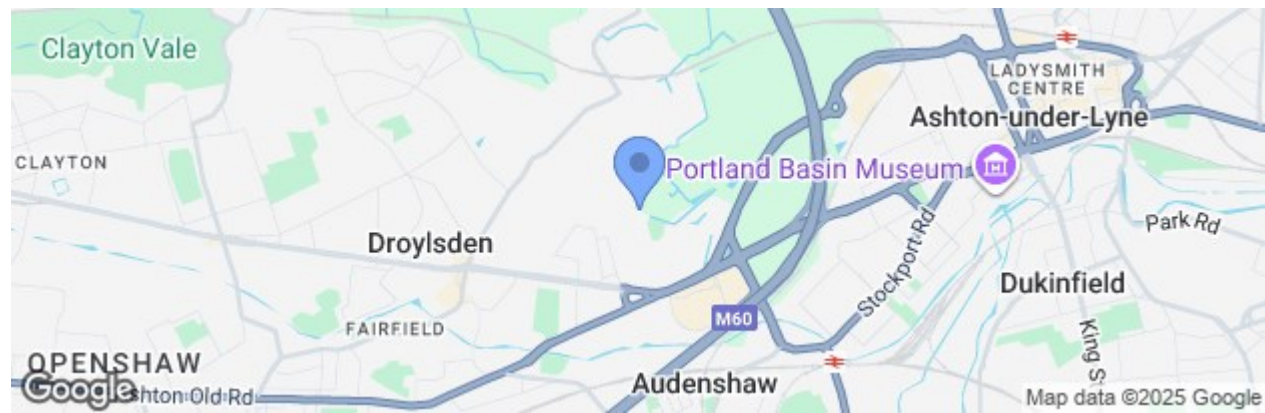

GROUND FLOOR

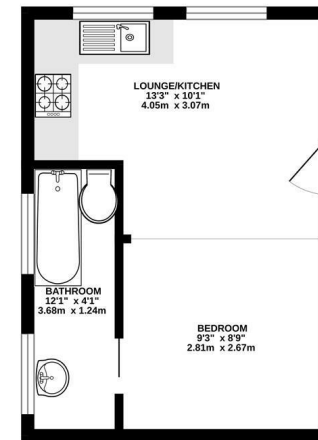

While every attempt has been made to ensure the accuracy of the floorplan contained here, measurements of doors, windows, rooms and the other items are approximate and no responsibility is taken for any errors, omissions or misstatements. This plan is for guidance purposes only and should not be relied on for any legal or prospective purchase. The services, systems and appliances shown have not been tested and no guarantee is given for their operation or efficiency over time.

COUNCIL TAX BAND:

C

TENURE:

Leasehold

EPC RATING:

D

LOCAL AUTHORITY:

Tameside