



6 Pulker Close, Oxford, OX4 3LG

£1,495 PCM

- AVAILABLE FROM 21st September 2025
- A refurbished mid 20th Century 1st floor apartment
- Independent access to the property
- Good scale dual aspect Sitting / Dining Room
- Well equipped kitchen
- 2 Double Bedrooms
- Green backdrop with the surrounding treescape
- A property flooded with light
- Walk to local supermarket / general shops
- Oxford City Centre c.2.4 miles Oxford Railway Station c.2.2 miles

TEMPLE COWLEY  
Oxford City Centre c.2.4 miles Oxford Railway Station c.2.2 miles

Located within a quiet residential mid 20th Century apartment building, a refurbished first and second floor maisonette with a light interior of good scale benefitting from the green backdrop of the surrounding treescape. Independent access. Sitting / dining room of good scale, Fully equipped kitchen, 2 bedrooms of good proportions. Private gated communal gardens. Parking. A short walk to a supermarket and general shopping. Available from 21st September 2025.  
(TOTAL FLOOR AREA: c.733 sq ft / c.m2)

QUOTING RENT: £1,500pcm

## THE PROPERTY

A mid 20th Century 2 bedroom unfurnished maisonette with private ground floor entrance and main accommodation on first and second floors.

### 6 Pulker Close

Approximate Gross Internal Area = 68.1 sq m / 733 sq ft

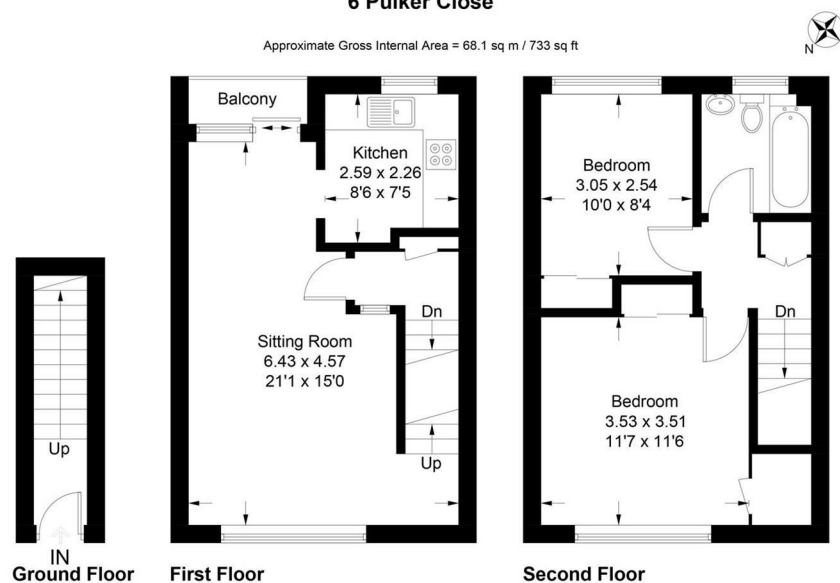

Illustration for identification purposes only, measurements are approximate, not to scale. Fourlabs.co © (ID1236922)

## SITUATION

Contact: Gavin West  
(t) 01865 510000 (e) gavin@west-tpc.co.uk

## Directions

From the Littlemore roundabout on Oxford's eastern bypass take the exit on to A4158 through Rosehill heading in the direction of central Oxford. As you head down the hill take the right hand turn at the Between Towns Road traffic lights and proceed to the next set of traffic lights and turn right by the Templars Square shopping centre multi-storey car park and proceed up the hill and Pulker Close is the second turning on your right hand side. WHAT3WORDS Co-Ordinate:- ///cracks.cloth.marker