

west
THE PROPERTY CONSULTANCY



Oakleigh Cottage Main Street, Over Norton, Chipping Norton, Oxfordshire, OX7 5PR

£1,750 PCM

- Peacefully located very attractive period cottage
- Edge of the Cotswolds location close to Chipping Norton
- Hand crafted kitchen and laundry
- 3 Vaulted bedrooms with exposed timbers
- Well appointed principal bathroom
- Landscaped private south facing cottage garden
- Picturesque village setting with wonderful Cotswold Way walks
- Chipping Norton 0.7 miles, Daylesford Organic c. 7 miles
- Oxford 22 miles
- VIEWING BEING BOOKED FROM 10th April 2026

OVER NORTON, Nr.CHIPPING NORTON
Chipping Norton 0.7 miles, Daylesford Farm c. 7 miles, Soho Farmhouse c. 7.5 miles, Oxford 22 miles

Situated in the heart of picturesque Over Norton, a short distance from the historic market town of Chipping Norton, a period 3 bedroom terraced cottage featuring bespoke handmade kitchen and laundry, Cloakroom with Roca sanitaryware and limestone floors throughout the ground floor.

On the first floor the property offers 3 bedrooms and a principal bathroom, The rear garden has been thoughtfully landscaped and provides a truly tranquil and private place to relax. On street parking. VIEWING FROM: 10th April 2026. (TOTAL FLOOR AREA: c.865 sq ft / 80 m2)

QUOTING RENT: £1,750pcm

THE PROPERTY

ATMOSPHERIC AND TRANQUIL COTTAGE ON THE EDGE OF CHIPPING NORTON

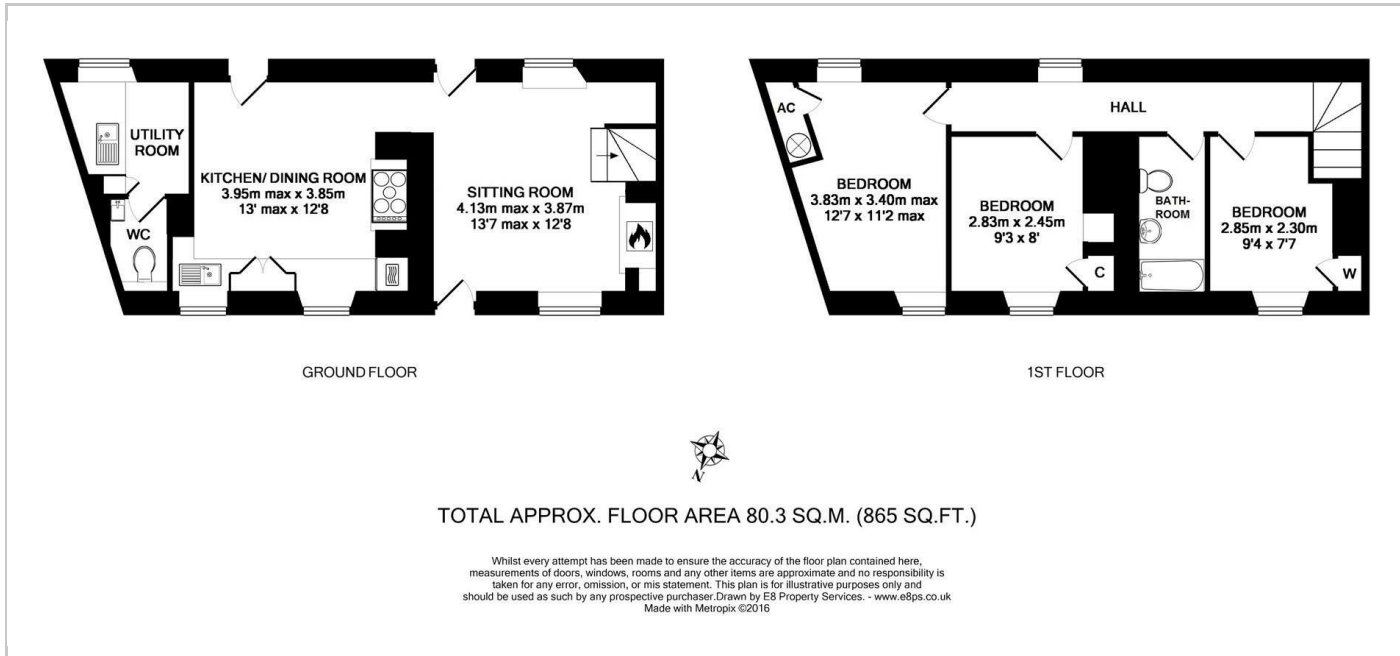

SITUATION

Contact: Gavin West
(t) 01865 510000 (e) gavin@west-tpc.co.uk

A holding deposit of 1 weeks rent will apply and be taken when making an application to secure a tenancy through WEST-The Property Consultancy. Please contact the office for further details if required.

Directions

From Oxford, proceed North on the A44 and at the roundabout with Blenheim Palace, proceed straight over to continue on the A44 through Woodstock for approximately 10.5 miles and turn left signed to Chipping Norton, to follow the A44. At the bottom of the hill at the double roundabout, take the second exit for the B4026 and proceed up the hill into Over Norton. Bear right and Oakleigh Cottage will be found on the right hand side after approximately 100 yards. WHAT3WORDS Co-ordinate:- ///gradually.riverside.universal