



1 Gloucester Mews
Faringdon, SN7 7JT
£1,095 Per Month



1 Gloucester Mews, Faringdon, SN7 7JT

FARINGDON
 Shrivensham c. 6 miles Swindon c. 12.3 miles

A well presented property with two bedrooms, located in the heart of this historic market town with car parking. Developed from old barn buildings with a lounge & kitchen/diner. Private courtyard garden. One double and one single bedroom with exposed beams. Modern family bathroom with shower over the bath. Gas central heating and double glazing. Allocated Parking Space

(Total floor area: c. 484 sq ft) EPC Rating E.

Vale of White Horse DC
 Council Tax Band C £2350.01 2026/2027

Floor Plan

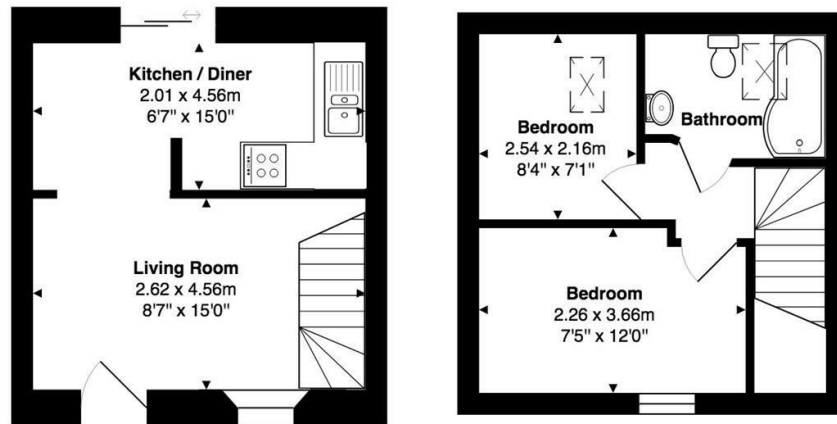

Total Area: 45.1 m² ... 486 ft²

Whilst every attempt has been made to ensure the accuracy of the floor plan contained here, measurements of doors, windows, rooms, and any other items are approximate. No responsibility is taken for any error, omission, or mis-statement. This plan is for illustrative purpose only and should be used as such.
 Drawn by E8 Property Services. www.e8ps.co.uk

- TUCKED AWAY SETTING CLOSE TO CENTRE OF TOWN
- OFF STREET PARKING SPACE
- COURTYARD GARDEN
- 2 BEDROOMS
- SITTING ROOM
- KITCHEN/DINING ROOM
- FIRST FLOOR BATHROOM
- FURNISHED
- DOUBLE GLAZING & GAS CENTRAL HEATING
- AVAILABLE EARLY MAY 2026

Area Map



Energy Efficiency Rating		Current	Potential
Very energy efficient - lower running costs			
(92 plus) A			93
(81-91) B			
(69-80) C			
(55-68) D		56	
(39-54) E			
(21-38) F			
(1-20) G			
Not energy efficient - higher running costs			
England & Wales		EU Directive 2002/91/EC	

These particulars, whilst believed to be accurate are set out as a general outline only for guidance and do not constitute any part of an offer or contract. Intending purchasers should not rely on them as statements of representation of fact, but must satisfy themselves by inspection or otherwise as to their accuracy. No person in this firm's employment has the authority to make or give any representation or warranty in respect of the property.

216 Banbury Road, Oxfordshire, OX2 7BY
 Tel: 01865 510000 Email: oxford@west-tpc.co.uk <https://www.west-tpc.co.uk>