

west
THE PROPERTY CONSULTANCY

TO LET

1B Temple Mews, 6 Temple Road, Temple Cowley, Oxford, OX4 2DY

£1,695 PCM



- Available Mid / End May 2025
- A very light duplex apartment
- Located in a small contemporary building
- Peaceful Temple Cowley location
- Large 'social' kitchen space
- Sitting area with balcony / outside space
- 2 Bedrooms of good scale
- Stylish shower room
- Dedicated parking space
- Walk to central Cowley or bus or cycle to the City Centre

TEMPLE COWLEY - Oxford
City Centre c.2.8 miles Oxford Station c. 2.9 miles

A very stylish duplex apartment, located in a contemporary apartment block. Set in a discreet East Oxford location that is quiet, yet conveniently close to the bustling and popular Cowley Road, with its shops, boutiques, bars, restaurants and concert venues. The apartment offers a large reception room with balcony, a fully integrated contemporary kitchen, gas fired central heating, 2 double bedrooms and a well appointed bath /shower room. The property has the rare benefit of 1 'off street' parking space. Close to central Cowley. (TOTAL FLOOR AREA: c.915 sq ft / 85 m2)

QUOTING RENT: £1,695 pcm

THE PROPERTY

A CONTEMPORARY DUPLEX APARTMENT IN A PEACEFUL TEMPLE COWLEY LOCATION

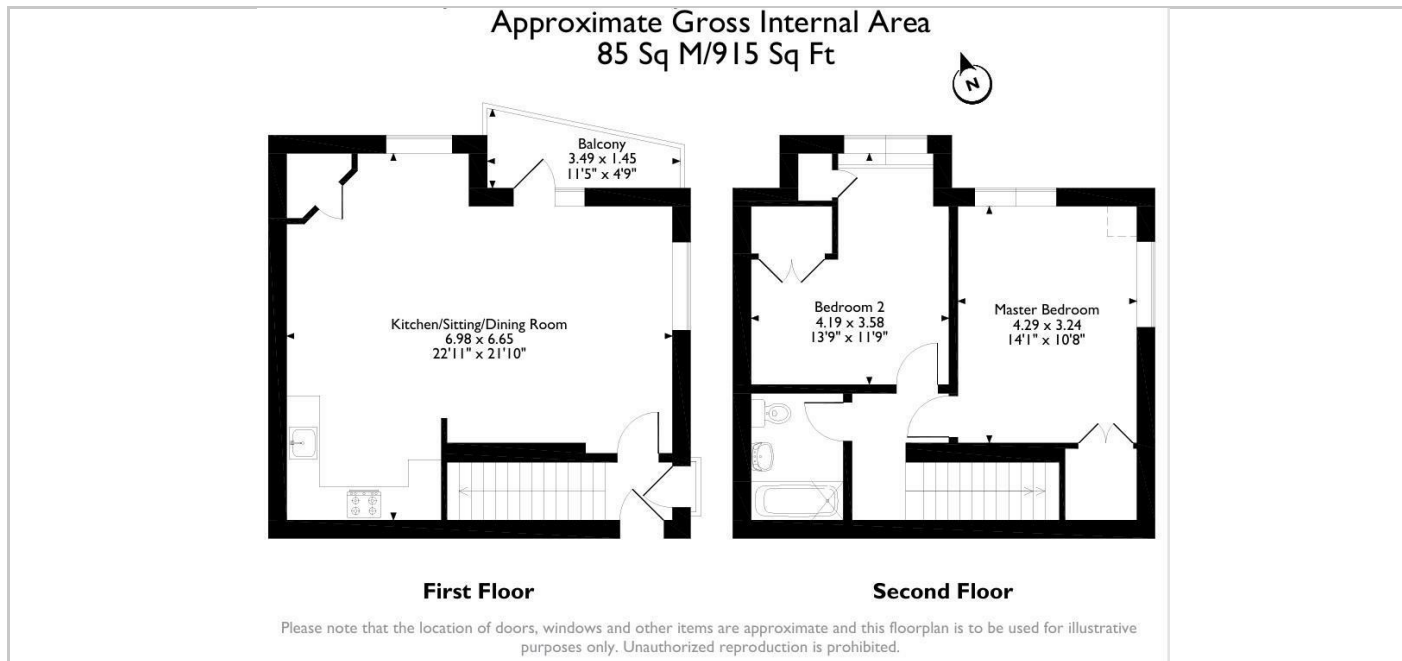

SITUATION

Contact: Gavin West
(t) 01865 510000 (e) gavin@west-tpc.co.uk

Directions

From the Oxford Ring Road, leave at the Cowley Junction (BMW Mini works) and proceed west along the Oxford Road to Cowley. Proceed over the Between Towns Road traffic lights continuing straight on and after about 500 yards take the second right hand turn in to Marsh Road passing The Marsh Harrier Public House on your right and then bear right in to Temple Road. Temple Mews is the small contemporary apartment block a short distance along on your right with the low metal railings to the front of the building. You can turn right at the far end of the building and the parking space will be found for No.1B a short distance along on your left.
WHAT3WORDS Co-ordinate:- [///shelf.actors/whites](https://www.what3words.com/#!/en/white/actors/shelf)

216 Banbury Road, Oxfordshire, OX2 7BY
Tel: 01865 510000 Email: oxford@west-tpc.co.uk <https://www.west-tpc.co.uk>