

west
THE PROPERTY CONSULTANCY

Martin Court
1-12

TO LET

Flat 6 Martin Court, Middle Way, Summertown, Oxford, OX2 7LF

£1,595 PCM



- A very desirable location
- Peaceful location
- Light reception room
- Refitted Kitchen with appliances
- Centrally Heated
- Central Summertown
- A first floor apartment
- Double Bedroom
- Furnished
- parking space

SUMMERTOWN

Central Oxford c. 2.3 miles, Oxford Railway Station c. 2.6 miles

A perfectly located one bedroom first floor apartment, positioned within a short walking distance of Summertown's numerous facilities, including restaurants, coffee shops, bars, supermarkets, boutique shopping etc. The property, peacefully situated at the rear of the building offers a refitted kitchen with integrated appliances, reception with large glass elevation, a double bedroom with fitted wardrobe and a well appointed bath / shower room. The property is centrally heated and also has the option of an allocated parking space.
(TOTAL FLOOR AREA c. 431 sq ft / 41 m2)

QUOTING RENT: £1,595 AVAILABLE: From 1st September 2025

THE PROPERTY

IN THE PEACEFUL HEART OF DESIRABLE SUMMERTOWN - A one bedroom first floor apartment within walking distance of restaurants, coffee shops and bars

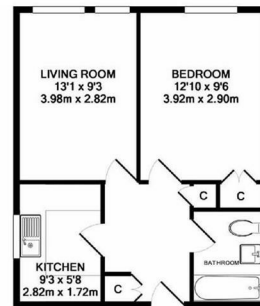

These measurements are the maximum & are approximate only, they do not take into account minimum measurements. Drawn by E55Survey.com
Made with Metopolis 62009

SITUATION

Contact: Lucy Self
(t) 01865 510000 (e) lucy@west-tpc.co.uk

A holding deposit of 1 weeks rent will apply and be taken only when an application to rent through WEST-The Property Consultancy has been accepted by the landlord subject to referencing. Please contact the office for further details if required.

Directions

From Oxford city centre proceed up along St Giles and up Woodstock Road. Go past St Edwards School and take the third turning right into Osberton Road and turn left at the bottom into Middle way and Martin Court will be found on your right hand side just past Hobson Road. There is parking to the rear of the building accessed off Hobson Road.