



TO LET

15 Willow Farm, Marcham, Oxfordshire, OX13 6FP

£1,475

- COMFORTABLE MODERN HOME
- 2 BEDROOMS, 2 BATHROOMS
- SITTING ROOM, FITTED KITCHEN/DINING ROOM
- GROUND FLOOR CLOAKROOM
- PRIVATE GARDEN
- 2 PARKING SPACES
- GAS CENTRAL HEATING, DOUBLE GLAZING
- COUNCIL TAX BAND C
- AVAILABLE MID-JULY 2025

A popular village well placed for easy access to Abingdon, A34, Oxford etc

THE PROPERTY

A VERY SMART MID TERRACE HOUSE ON A QUIET MODERN DEVELOPMENT. 2 BEDROOMS, 2 BATHROOMS, 2 PARKING SPACES. 1 RECEPTION ROOM, FITTED KITCHEN & GARDEN. DOUBLE GLAZING. GAS CENTRAL HEATING.

AVAILABLE MID JULY 2025

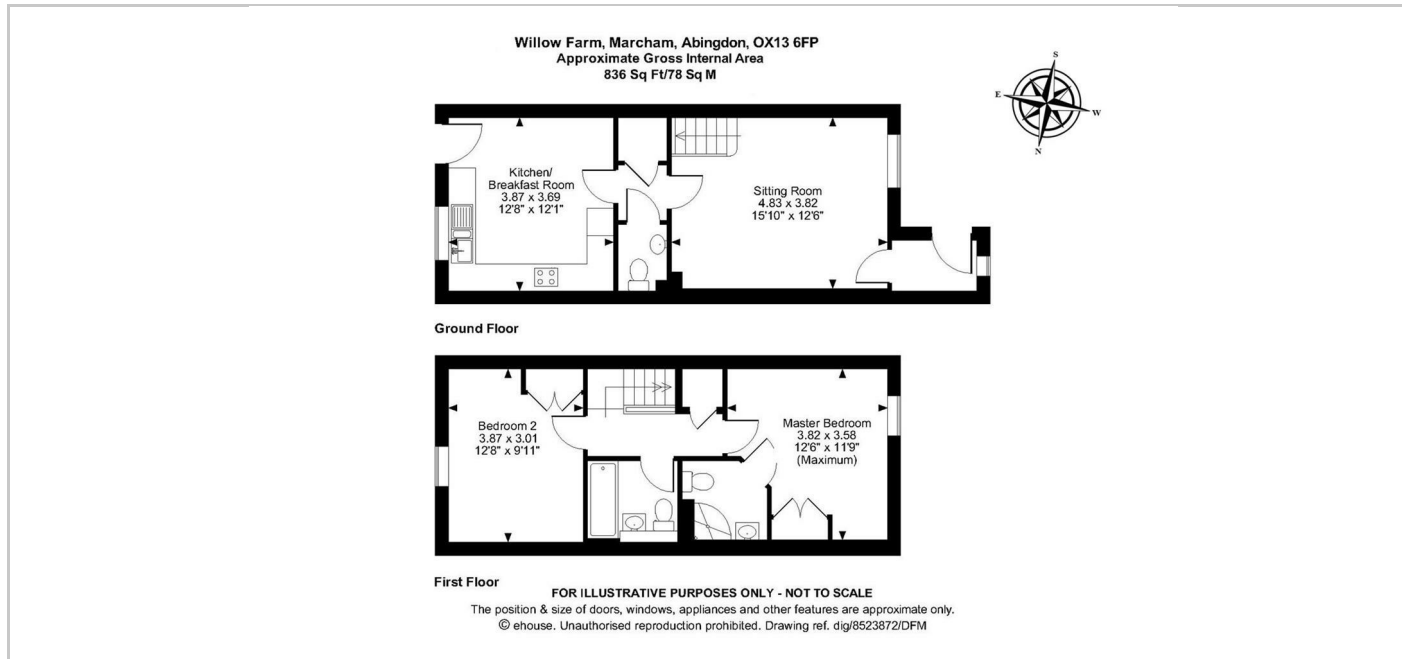

SITUATION

Directions

DIRECTIONS: From the A34 come off at Abingdon South, the junction with the A415. Take the A415 towards Wantage and Witney and after about 1.1 mile take the first left on reaching Marcham, into Willow Farm. Turn left at the first opportunity and No.15 will be ahead of you to your right. What3words:///differ.compound.sonic