

COMING SOON

TO LET

The Ashes Sunningwell, Abingdon On Thames, Oxfordshire, OX13 6RD

£2,400 PCM



- Picturesque Rural Village
- Quick access to Oxford
- 3/4 Bedrooms
- Private 'Cottage' Garden
- 'The Barn' popular village farm shop and cafe
- Quick access to Abingdon on Thames
- An individual detached house in a discreet setting
- 2 Bath/Shower Rooms
- On the periphery of the village cricket Pitch
- Pet considered with marginal rental value uplift

SUNNINGWELL

Oxford c.6.9 miles Abingdon on Thames c.2.7 miles Radley Station c. 2.3 miles

Set on the edge of the village cricket club ground, an individual detached house offering a high degree of privacy within an attractive setting. 2/3 Reception rooms. 3/4 Bedrooms. 2 Bath / Shower rooms. Contemporary kitchen. Driveway with ample parking facilities. Private cottage gardens. Good 'gastro' pub and farm shop in the village. Waitrose c.3 miles in nearby Abingdon on Thames. (TOTAL FLOOR AREA: 1492 sq ft / 139 m2)

QUOTING RENT: £2,400pcm or £2,475pcm if a pet accepted

THE PROPERTY

An individual detached village house on the periphery of the cricket club in picturesque Sunningwell.

AVAILABLE 16th SEPTEMBER 2025

£2,400pcm

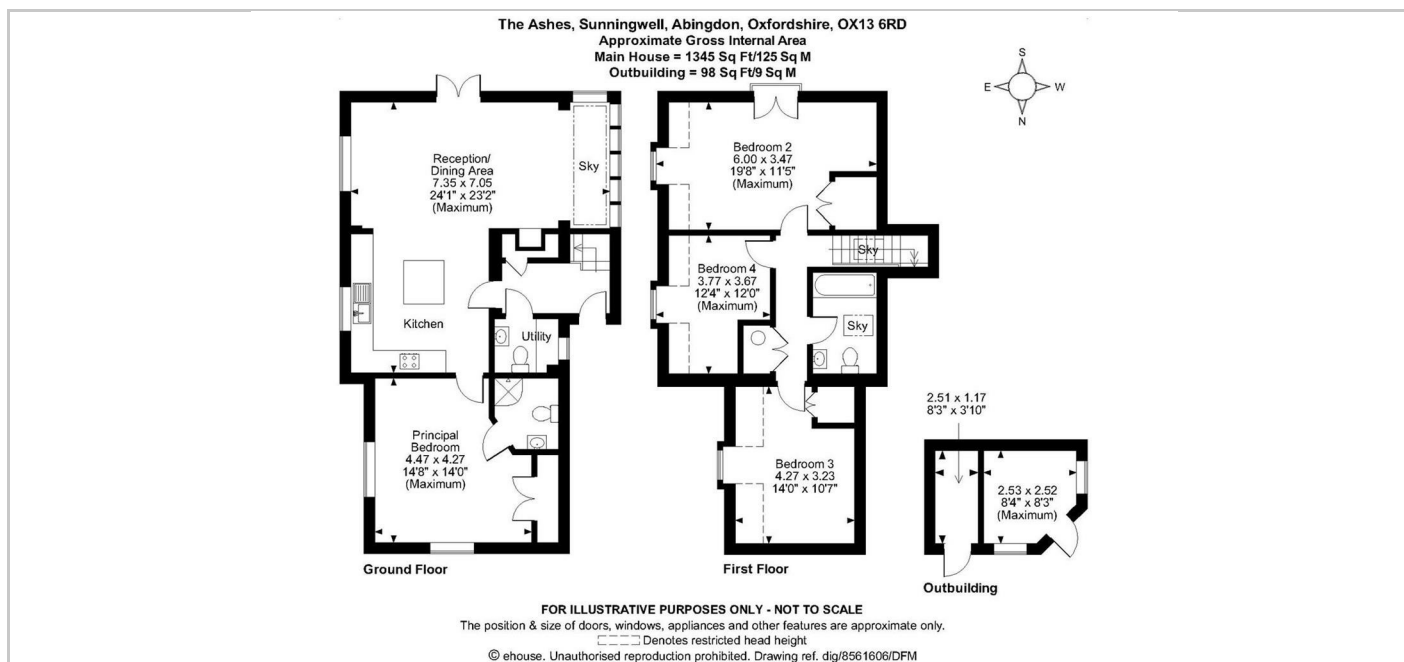

Directions

What3words:///appear.float.treat

SITUATION

Contact: Lucy Self
 (t) 01865 510000 (e) lucy@west-tpc.co.uk