

COMING SOON

TO LET

35 The Chilterns, Gloucester Green, Oxford, OX1 2DF

£1,750 PCM



- Prime City Centre location
- Spacious balcony taking in the atmosphere
- Available from 26th June 2026
- Short walk to Oxford Station
- Great choice of Restaurants & Bars
- Furnished one bedroom apartment
- Landmark City Centre address
- Study space
- Short walk to Westgate Oxford
- This is about as central as residential accommodation gets

CITY CENTRE LIVING
Oxford Train Station 0.6 miles, Westgate Shopping Centre 1.0 mile

A highly desirable one bedroom apartment complete with a balcony of good scale, providing atmospheric outside space. In a sought after location in the heart of Oxford in Gloucester Green, the property offers a large contemporary fully integrated kitchen/ living 'social' space, one bedroom and a bathroom. Currently there also exists an opportunity to rent an undercroft parking space independently at £160pcm. In all a very special place to be.
(TOTAL FLOOR AREA: c 512 sq ft / 48 m2).

QUOTING RENT: £1,750 pcm

FURNISHED

Leasehold covenants will apply

THE PROPERTY

A FURNISHED ONE BEDROOM APARTMENT
LOCATED IN THE HEART OF OXFORD IN
ATMOSPHERIC GLOUCESTER GREEN

Potential 'undercroft' secure parking space available
very close by at a rate of £160 pcm

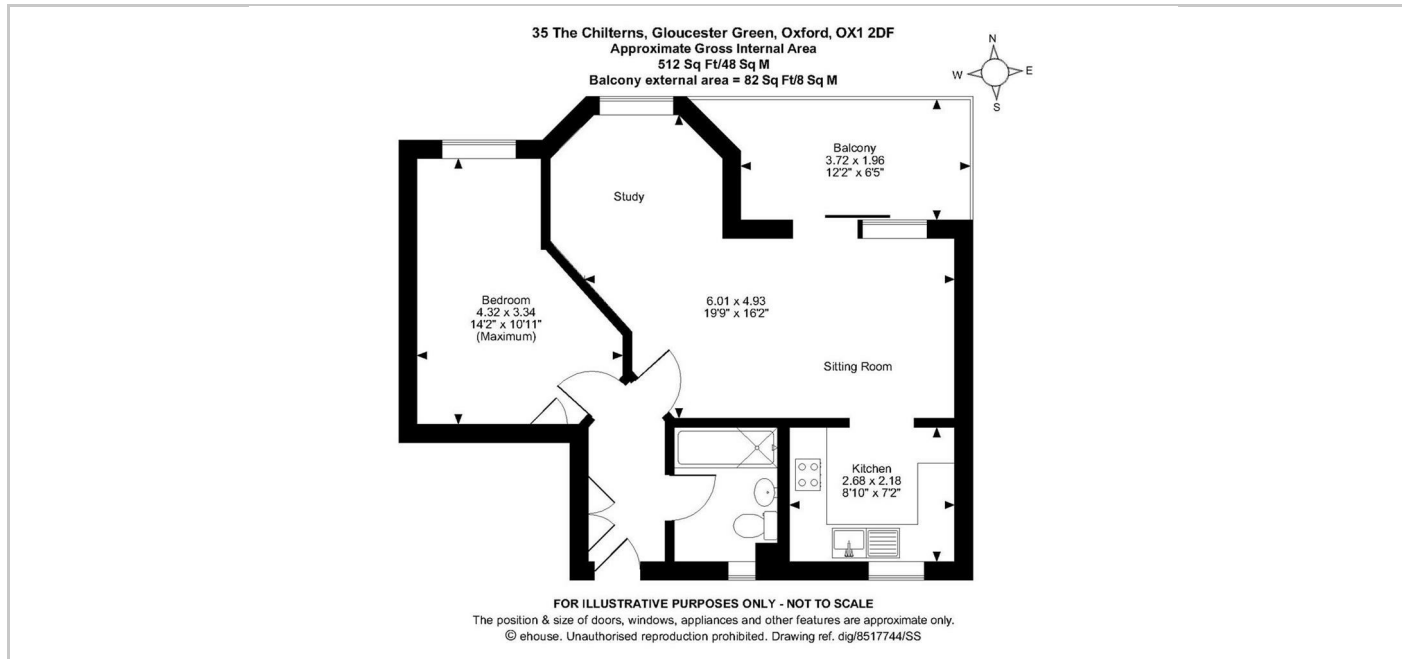

Directions

From St Giles turn right at the Randolph Hotel into Beaumont Street, and take the first left into Gloucester Street. After approximately 100m, turn right into Gloucester Green Square, and the entrance to the building to access number 35 will be found on the right hand side, the third entrance along.

SITUATION

Contact: Gavin West
(t) 01865 510000
(e) gavin@west-tpc.co.uk

A holding deposit of 1 weeks rent will apply and be taken when making an application to secure a tenancy through WEST-The Property Consultancy. Please contact the office for further details if required.