

west  
THE PROPERTY CONSULTANCY

TO LET

25 The Lion Brewery, St Thomas Street, Oxford, Oxfordshire, OX1 1JE

£2,595 Per Month



- Iconic Contemporary Apartment Building
- A short walk in to the heart of historic Oxford
- Sitting room with 'Juliet' balcony above a waterway
- Curzon Cinema close at hand
- Available immediately
- First class city centre location
- A short walk to Oxford Station
- Master Bedroom with en-suite facility and a walk in wardrobe
- Westgate Oxford also close at hand
- Offered Furnished

OXFORD CITY CENTRE  
Oxford Station c.0.2 mile Westgate c.0.31 mile

Located in one of the city's landmark central developments stylishly created on the former Morland Brewery site. A short walk to the city centre and railway station making this furnished second floor apartment highly desirable indeed. Offering an open plan sitting room with a 'Juliet' balcony overlooking the very attractive gated approach to The Lion Brewery. A contemporary fully integrated kitchen with high quality cabinetry. The master bedroom has an en-suite facility and walk in wardrobe. A highly thermally efficient building facilitating low running costs.  
(TOTAL FLOOR AREA c.774 sq ft / c.72 m<sup>2</sup>)

QUOTING RENT: £2,595pcm

## THE PROPERTY

ONE OF THE MUCH COVETED APARTMENTS IN  
THE CENTRALLY LOCATED THE LION BREWERY

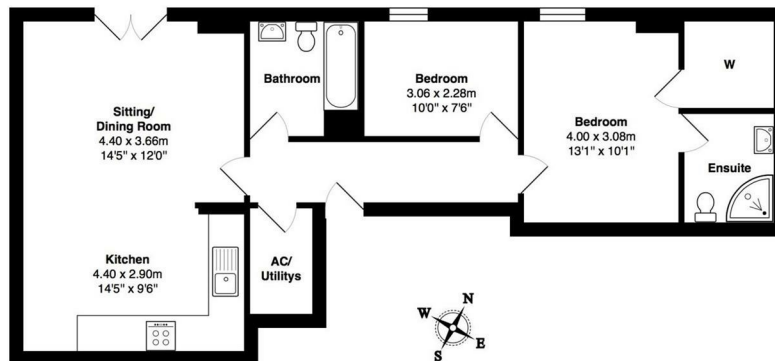

Gross Internal Area: 71.9 m<sup>2</sup> ... 774 ft<sup>2</sup>

Whilst every attempt has been made to ensure the accuracy of the floor plan contained here, measurements of doors, windows, rooms, and any other items are approximate. No responsibility is taken for any error, omission, or mis-statement. This plan is for illustrative purposes only and should be used as such.  
Drawn by E8 Property Services. [www.e8ps.co.uk](http://www.e8ps.co.uk)

## SITUATION

Contact: Gavin West  
(t) 01865 510000 (e) [gavin@west-tpc.co.uk](mailto:gavin@west-tpc.co.uk)

A holding deposit of 1 weeks rent will apply and be taken when making an application to secure a tenancy through WEST-The Property Consultancy. Please contact the office for further details if required.

## Directions

From St Giles turn right at the Randolph Hotel into Beaumont Street, continue over the traffic lights onto Hythe Bridge Street, at the traffic lights turn left and go straight over onto Hollybush Row, take the first turning on your left onto St Thomas Street and The Lion Brewery is located half way down on the right hand side through some wrought iron gates with two golden lions on either side. No 25. is accessed in the entrance in the left hand corner. WHAT3WORDS CO-Ordinate:- ///part.towers.novel