



7 Blenheim Orchard
East Hanney Wantage, OX12 0JA
£2,650 Per Month



EAST HANNEY
Oxford c. 10.8 miles Didcot c. 7.6 miles Wantage c. 3.8 miles

Area Map

Situated in the popular village of East Hanney is this stunning detached chalet style home. Finished to a high standard throughout the property offers a contemporary space with all the modern comforts, surrounded by the beautiful Oxfordshire countryside. On the ground floor there are two double bedrooms one with en-suite, separate bathroom, utility room, cloakroom, large living room with patio doors into the garden, spacious and fully equipped kitchen/breakfast room and separate dining room. To the first floor there is a further double bedroom with en-suite, storage, spacious master bedroom with built in wardrobes and en-suite. Further benefits include a gated driveway for several cars, garage and large garden mainly laid to lawn. Popular village, fabulous accommodation, large garden, great location for Oxford, Didcot Rail Station and the A34 - this property has it all!

Council Tax Band D

Gas Central Heating

Double Glazing

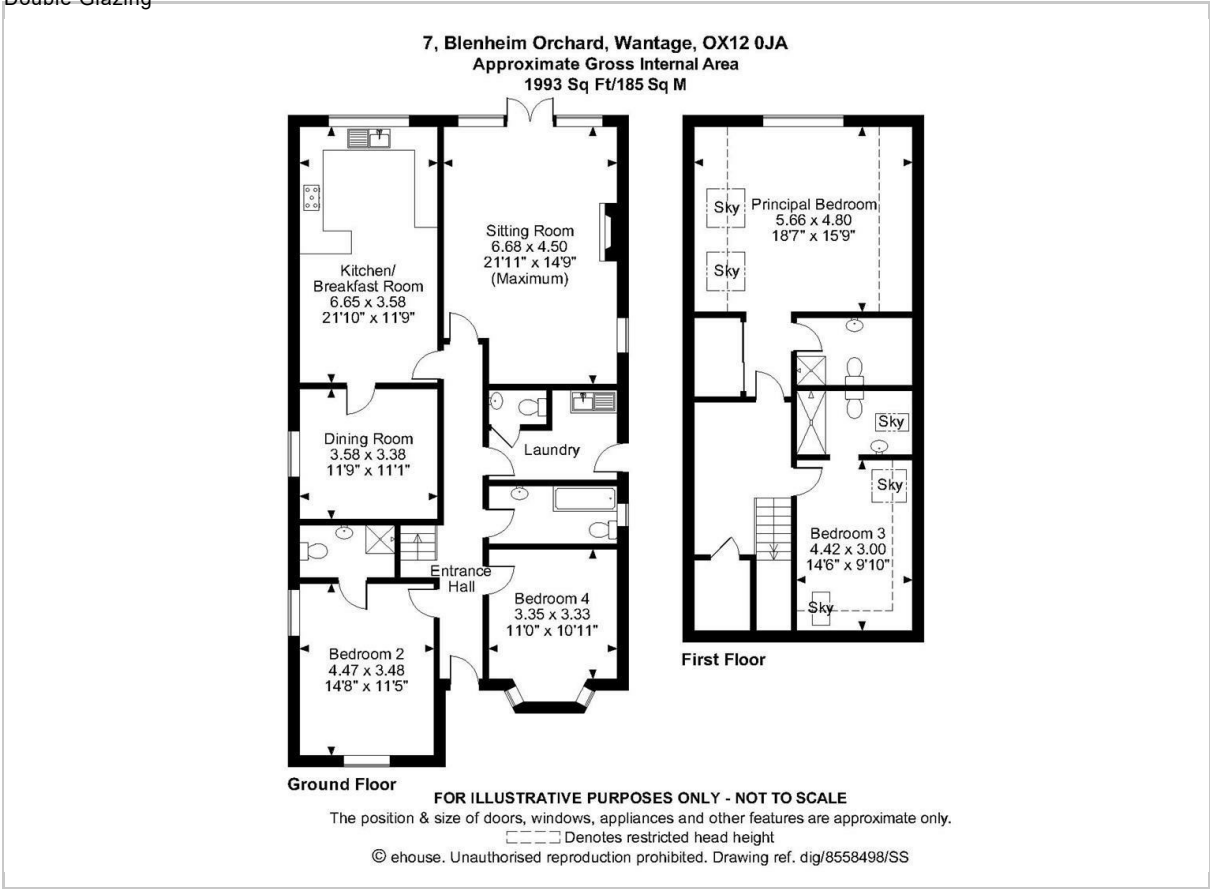

- POPULAR VILLAGE
- DETACHED HOME
- FOUR BEDROOMS
- FOUR BATHROOMS
- SPACIOUS ACCOMMODATION - c 1993sq fr gross internal floor area
- LIGHT & AIRY SPACES
- SPECTACULARLY LARGE GARDEN
- GARAGE
- AMPLE PARKING
- GAS CENTRAL HEATING



Energy Efficiency Rating		
	Current	Potential
Very energy efficient - lower running costs		
(92 plus) A		
(81-91) B		
(69-80) C		
(55-68) D		
(39-54) E		
(21-38) F		
(1-20) G		
Not energy efficient - higher running costs		
England & Wales	72	80
	EU Directive 2002/91/EC	

These particulars, whilst believed to be accurate are set out as a general outline only for guidance and do not constitute any part of an offer or contract. Intending purchasers should not rely on them as statements of representation of fact, but must satisfy themselves by inspection or otherwise as to their accuracy. No person in this firms employment has the authority to make or give any representation or warranty in respect of the property.