

west

THE PROPERTY CONSULTANCY



Hedgerley Littleworth
Faringdon, SN7 8ED
£2,375 PCM



Hedgerley Littleworth, Faringdon, SN7 8ED

LITTLEWORTH
Oxford c.16.6 miles Faringdon c.2.1 miles Swindon c.12.5 miles

A detached family home situated in this sought after village. The property offers flexible and well proportioned accommodation throughout and a beautiful south west facing rear garden. The accommodation comprises entrance hall, cloakroom, sitting room with open fireplace, fabulous kitchen/breakfast room with integrated appliances, large utility room, dining room, study, play room, four double bedrooms, family bathroom, ample driveway parking, garage The property benefits from oil central heating, solar panels and double glazing throughout.

Just about two miles from the Market town of Faringdon with Waitrose, Tesco and Aldi and much more besides and well placed for easy access to Oxford and Swindon. Plenty of countryside walks and only a short way from the Thames.

Littleworth is within easy reach of very good schools, primary, secondary, state and private.

Council Tax Band F

Floor Plan

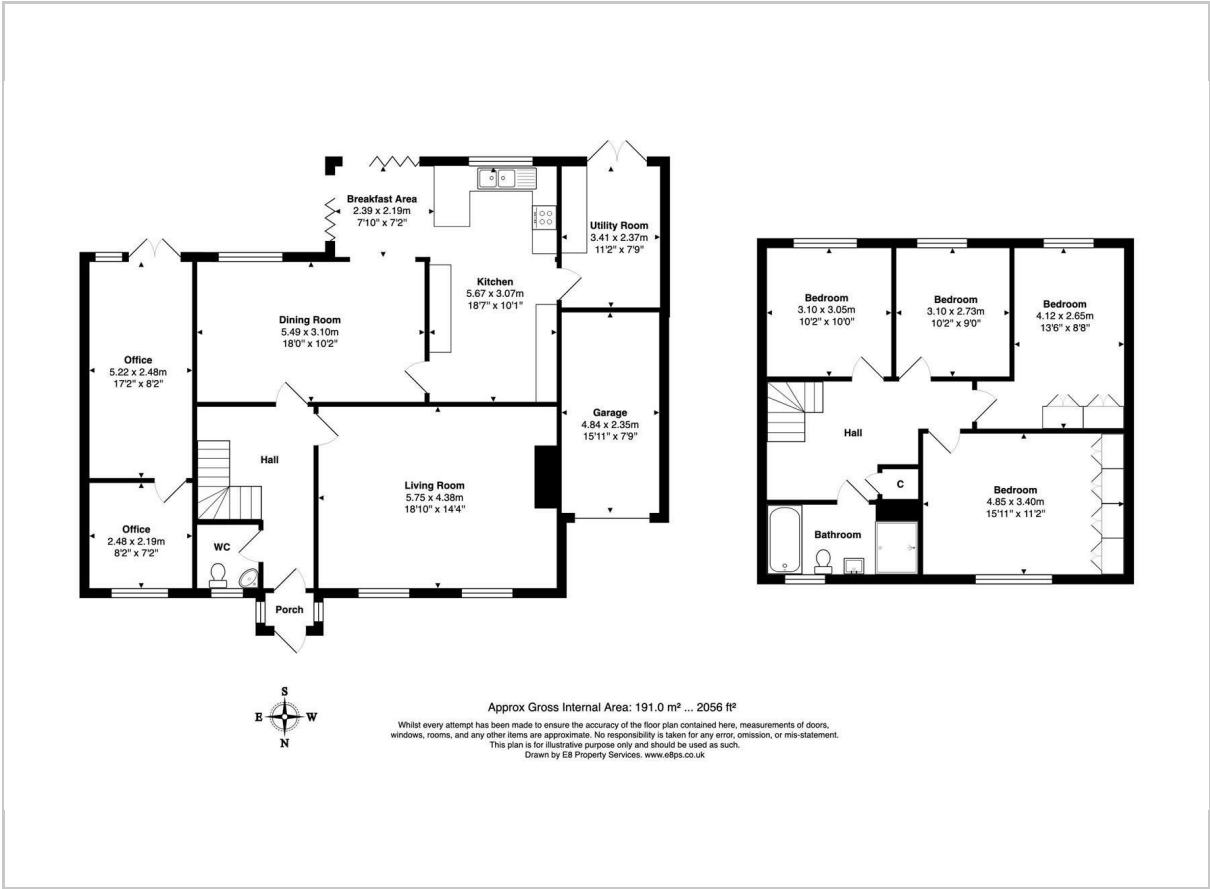

- Large Rear garden - South West
- Family room/Play Room
- Four double bedrooms
- Available 20/08/2025
- Unfurnished
- Over 2000 sq ft of space
- Fabulous Kitchen/Dining
- Family home
- Solar pannels
- Detached house

Energy Efficiency Rating		
	Current	Potential
Very energy efficient - lower running costs		
(92 plus) A		
(81-91) B		
(69-80) C		
(55-68) D		
(39-54) E		
(21-38) F		
(1-20) G		
Not energy efficient - higher running costs		
England & Wales	EU Directive 2002/91/EC	

Area Map



These particulars, whilst believed to be accurate are set out as a general outline only for guidance and do not constitute any part of an offer or contract. Intending purchasers should not rely on them as statements of representation of fact, but must satisfy themselves by inspection or otherwise as to their accuracy. No person in this firms employment has the authority to make or give any representation or warranty in respect of the property.

Tramway House, Mill Street, Wantage, Oxfordshire, OX12 9AQ
Tel: 01235 772299 Email: wantage@west-tpc.co.uk <https://www.west-tpc.co.uk>