

west
THE PROPERTY CONSULTANCY



TO LET

71 Harpes Road, North Oxford, OX2 7QJ

£1,850 PCM



- Available 29.05.2026
- Located just north of very popular Summertown
- Natural wood kitchen with the requisite appliances
- Bathroom featuring bath with shower over
- Oxford Parkway Station c.0.7 Mile
- A detached 2 bedroom house for a maximum of 3 people
- 2 Reception rooms (one can be used as an occasional 3rd bedroom)
- 2 Bedrooms on the 1st floor of good scale
- A private due south facing garden terrace
- Supermarkets, coffee shops, a good choice of bistros and restaurants close by.

NORTH OXFORD
Oxford c.2.2 Miles Oxford Parkway Station c.0.7 Mile

With its south facing courtyard garden, a detached house representing the perfect alternative to apartment living at this price point in this much coveted locality. The house on the ground floor comprises a good sized reception room space, with a second smaller social space which can be used a ground floor occasional bedroom. The natural wood kitchen is located at the far end of the house and is equipped with the required appliances. The first floor offers 2 bedrooms which are served by a bathroom. A private south facing paved terrace of good size is set to the front of the house and it is fully enclosed by high fencing and features some specimen trees. Central Summertown is located a 7 minute walk south of this property, where you will find supermarkets, coffee shops, a good choice of bistros and restaurants, a popular theatre and further boutique shopping. A rare find at this price point. The property has a license for 3 people.

THE PROPERTY

A SMALL DETACHED HOUSE PERFECTLY
LOCATED JUST NORTH OF SUMMERTOWN

71 Harpes Road, OX2 7QJ

Approximate Gross Internal Area 79.66 sq.m / 857 sq.ft

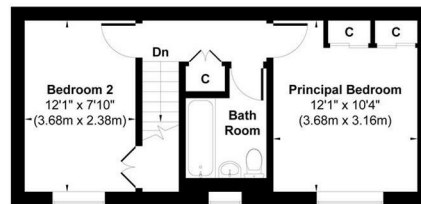

First Floor

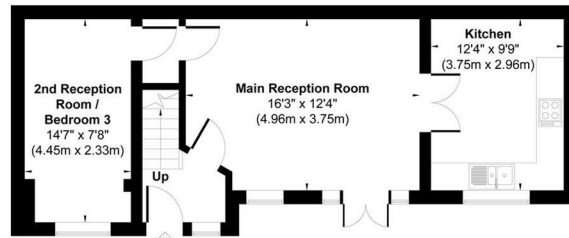

Ground Floor

Illustration for identification purpose only, measurements approximate and not to scale.

Directions

From the Summertown Roundabout on the Oxford Ring Road proceed south down the Banbury Road towards Summertown and after a third of a mile you will see a speed camera on your left and a pedestrian island in the middle of the road just after which you turn left in to Hernes Crescent where you proceed straight on for a short distance and bear left around the recent development of 3 storey town houses and then you come to where the road forks at which point you bear right in to Harpes Road and No.71 will be found on your left hand side as you approach the bottom end of the road. WHAT3WORDS Co-ordinate:- ///panels.poem.much

SITUATION

Contact: Gavin West
(t) 01865 510000 (e) gavin@west-tpc.co.uk