



SALES, LETTINGS, MANAGEMENT, MORTGAGES, LAND & NEW HOMES

David Phipps  
dp





£1,850 Per Month

# Bentham Walk

London, NW10 0UG

- 3 BEDROOMS
- SPACIOUS LIVING ROOM
- REFURBISHED KITCHEN
- BRAND NEW WHITE GOODS
- SEPARATE W/C
- PRIVATE GARDEN
- AMPLE STORAGE
- EXCELLENT TRANSPORT LINKS

Nestled in the heart of Bentham Walk NW10, this split-level maisonette epitomizes comfort and convenience. The property consists of Three bedrooms, family bathroom with a separate W/C, private garden and a newly refurbished kitchen. Brand new white goods. Council Tax £1,710.62. Available Now. £1950PCM







**Council Tax Band - C**

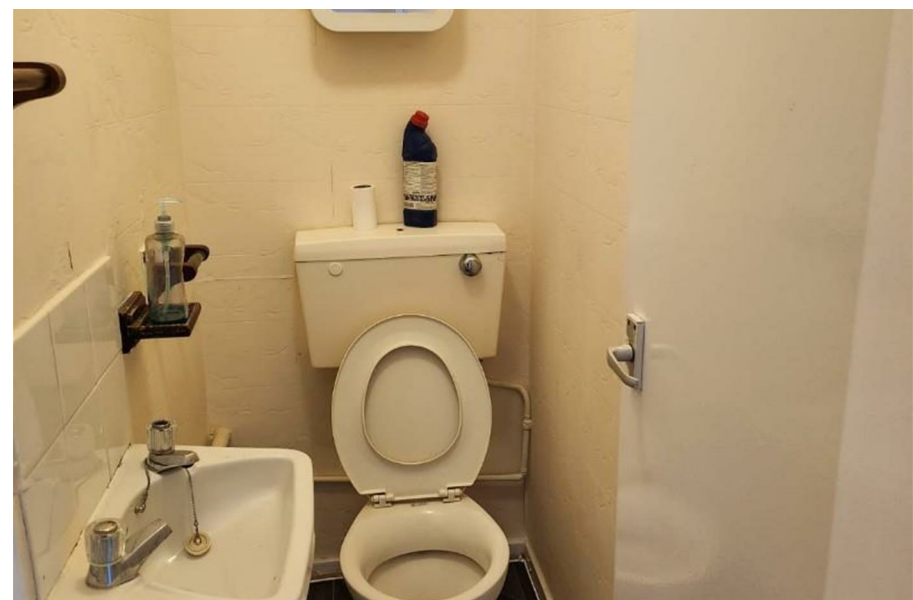







Floor Plans



Location Map

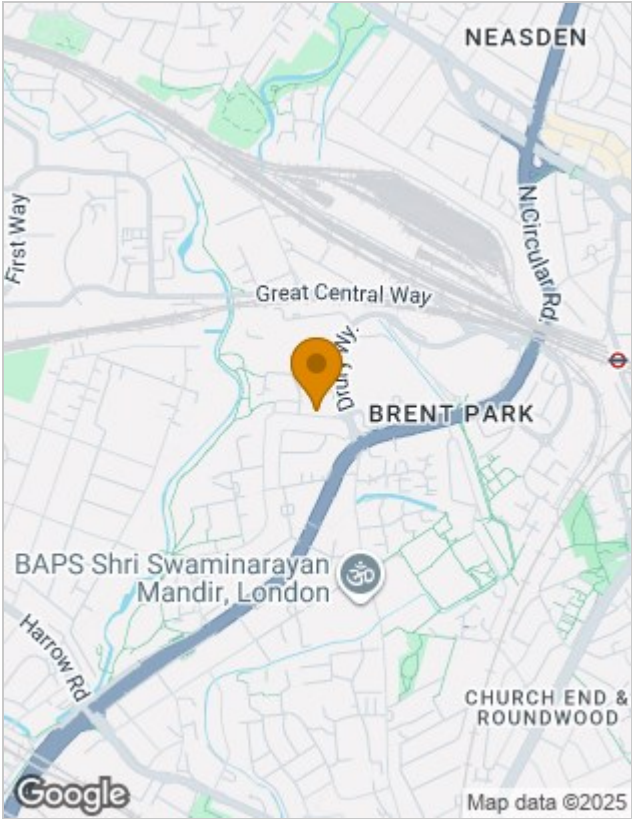

Energy Performance Graph



Viewing

Please contact our David Conway & Son Ltd Office on 02084225222 if you wish to arrange a viewing appointment for this property or require further information.

The particulars are set out as a general outline only for the guidance of intended purchasers or lessees, and do not constitute, any part of a contract. Nothing in these particulars shall be deemed to be a statement that the property is in good structural condition or otherwise nor that any of the services, appliances, equipment or facilities are in good working order. Purchasers should satisfy themselves of this prior to purchasing.