



Eastcote Lane, South Harrow, HA2 8BW

£1,025 PCM





# 19 Eastcote Lane

South Harrow, HA2 8BW

- FIRST FLOOR STUDIO FLAT
- FITTED KITCHEN
- WOOD LAMINATE FLOORING
- DOUBLE GLAZED
- UNFURNISHED
- 259 SQ FT
- WASHING MACHINE
- ELECTRIC HEATING
- ALLOCATED PARKING
- AVAILABLE NOW

Well presented first floor studio flat measuring 259 sq ft incorporating a 20'3 x 13'8 studio room with open plan fitted kitchen comprising newly installed electric oven with hob and extractor over, fitted wall and base units and washing machine. Fully tiled bathroom and loft storage space, wood effect laminate flooring. Allocated parking for 1 car. Electric heating, upvc double glazed. Unfurnished. Available 11/07. Ideally situated just 230 yards from South Harrow's Piccadilly Line tube and bus stations and South Harrow's main thoroughfare with its variety of shops, restaurants and convenience stores.

Council Tax Band: B - £1,588 per annum

Bills are not included.







**Council Tax Band - B**







Floor Plans

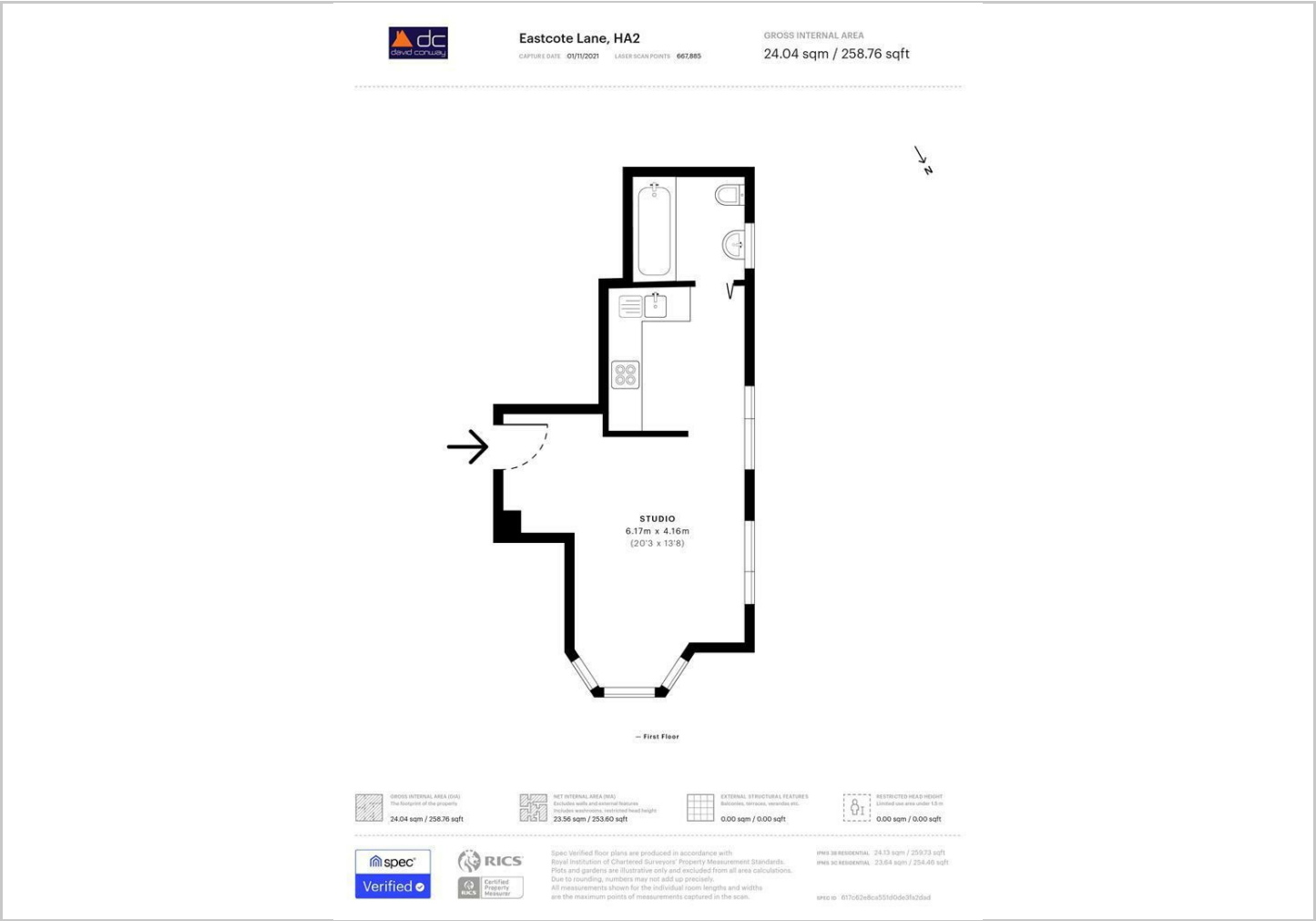

Location Map

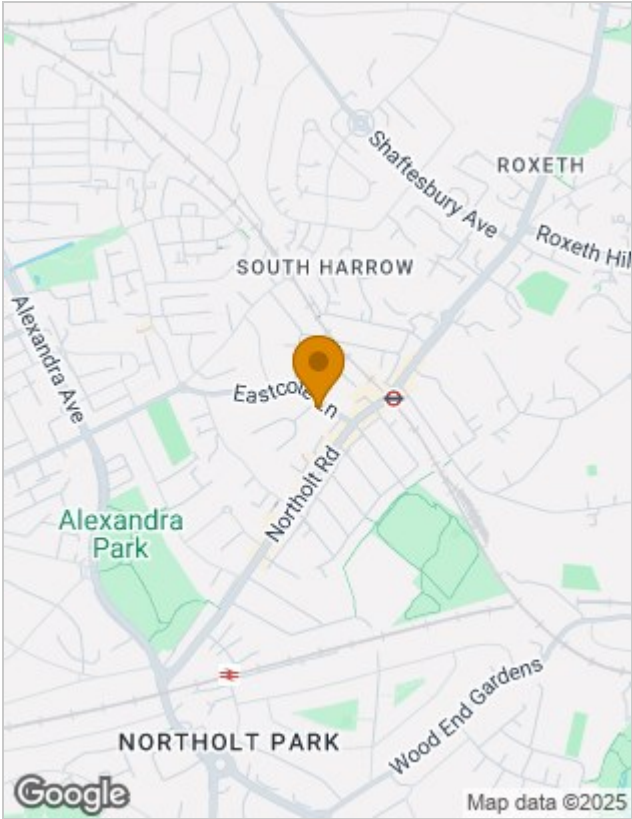

Energy Performance Graph

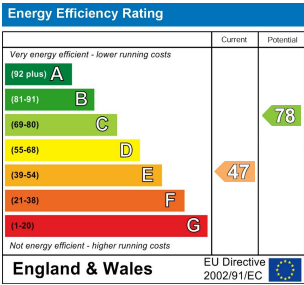

Viewing

Please contact our David Conway & Son Ltd Office on 02084225222 if you wish to arrange a viewing appointment for this property or require further information.

These particulars, whilst believed to be accurate are set out as a general outline only for guidance and do not constitute any part of an offer or contract. Intending purchasers should not rely on them as statements of representation of fact, but must satisfy themselves by inspection or otherwise as to their accuracy. No person in this firm's employment has the authority to make or give any representation or warranty in respect of the property. A £2,000 reservation deposit is payable to secure the sale. This deposit forms part of the purchase funds and will be allocated on completion. The reservation deposit is subject to terms and conditions.